

# EDCON-COMPONENTS

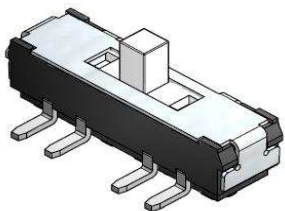

## Technical Description

Rating:	DC6V, 0,3A
Circuit:	2C-3P
Timing:	NON-Shorting
Travel:	2,0 ± 0,1mm
Contact Resistance:	70 mΩ max.
Operating Force:	
Stay	A > B < C :250± 100gf
Stay	A < B > C :300± 100gf
Operating Life:	10000 cycles

## Drawing

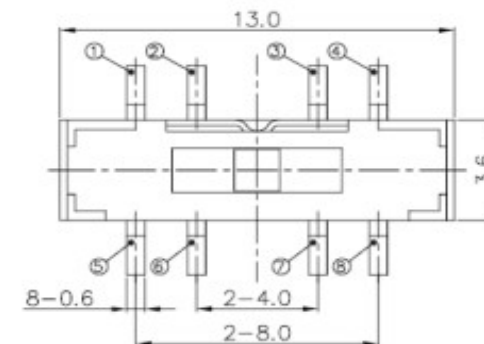
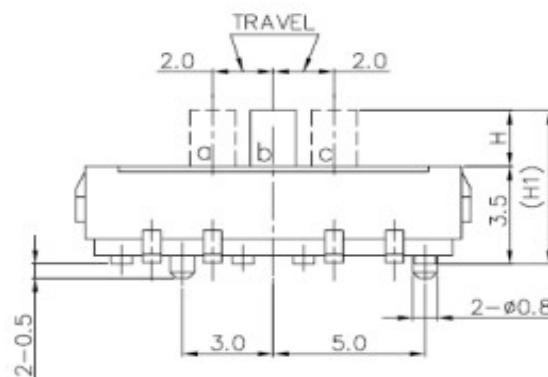

## PCB Layout

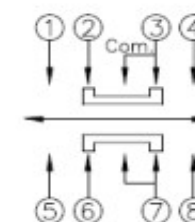
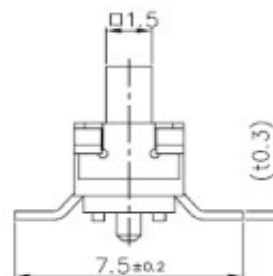
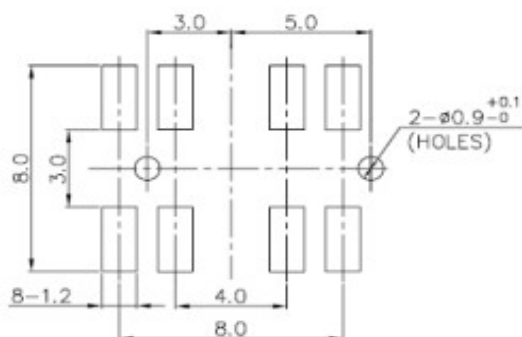

## SMD-SLIDE-Switch 3,5mm Height

Part No.: **Q62048**

Customer:

DRW:	Jason	CHKD	Wilson	MATL:	Wilson	TOLERANCE	Mason	DATE	31.08.2016
APPD:	Schumi			FINISH	Jamy		Sheet No.	1 from 3	

# EDCON-COMPONENTS

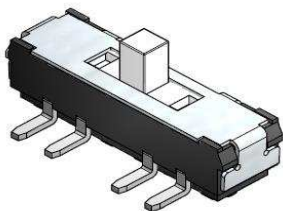

## Ordering Informations

Serie	Knob Length ( H + H1 )	Knob Type	Polarisation Peg	Spezial Function	ROHS	Packing				
-------	---------------------------	-----------	---------------------	---------------------	------	---------	--	--	--	--

<b>Q62048</b>	<b>A</b>	<b>0</b>	<b>Y</b>	<b>0</b>	<b>R</b>	<b>TR</b>				
---------------	----------	----------	----------	----------	----------	-----------	--	--	--	--

<b>A=</b> H=2,0 / H1=5,5mm	<b>0=</b> No function	<b>Y=</b> with Peg	<b>0=</b> No function	<b>R=</b> ROHS Conform	<b>BU=</b> Bulk- Ware
<b>B=</b> H=4,0 / H1=7,5mm					<b>TR=</b> Tape Reel

**SMD-SLIDE-Switch  
3,5mm Height**

Part No.: **Q62048**

DRW:	Jason	CHKD	Wilson	MATL:	Wilson	TOLERANCE	Mason	DATE	31.08.2016
APPD:	Schumi			FINISH	Jamy		Sheet No.		2 from 3

Customer:

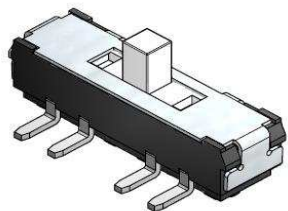

Soldering Profile Curve

Classification Reflow Profile (JEDEC J-STD-020C)



**SMD-SLIDE-Switch  
3,5mm Height**

Part No.: **Q62048**

DRW:	Jason	CHKD	Wilson	MATL:	Wilson	TOLERANCE	Mason	DATE	31.08.2016	Customer:
APPD:	Schumi			FINISH	Jamy		Sheet No.	3 from 3		