

EDCON-COMPONENTS

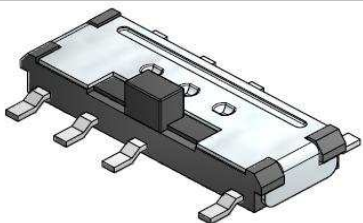

Technical Description

Rating: DC4V, 0,3A
Circuit: 2C-3P
Timing: NON-Shorting
Travel: $1,5 \pm 0,1$ mm
Contact Resistance: 70 mΩ max.
Operating Force:
 Stay a>b, b>a: 200 ± 150 gf
 b>c, c>b: 200 ± 150 gf

Operating Life: 10000 cycles

Drawing

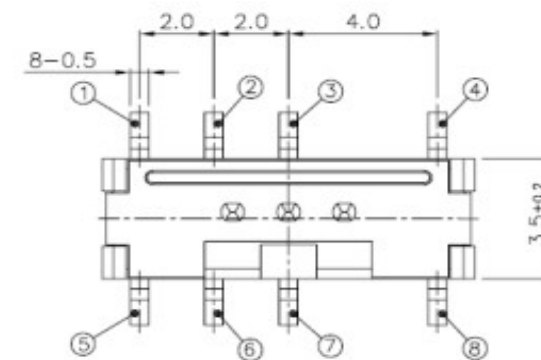
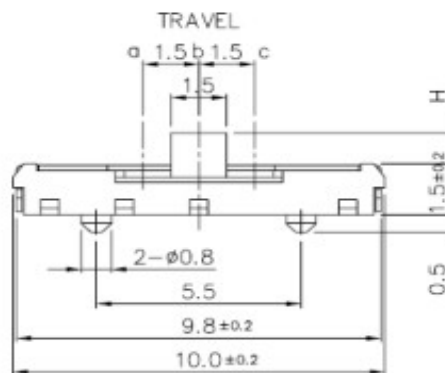

PCB Layout

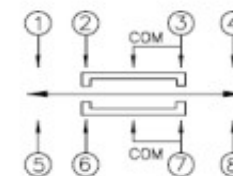
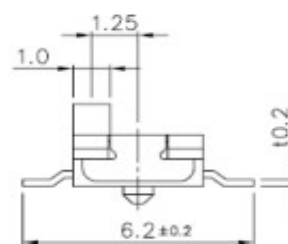
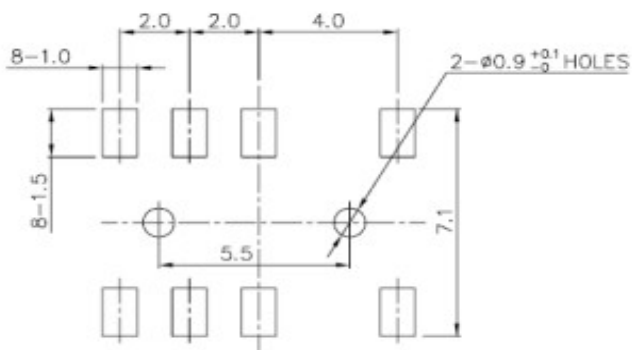

SMD-SLIDE-Switch 1,5mm Height

Part No.: **Q62019**

DRW:	Jason	CHKD	Wilson	MATL:	Wilson	TOLERANCE	Mason	DATE	31.08.2016
APPD:	Schumi			FINISH	Jamy		Sheet No.	1 from 3	Customer:

www.edcon-components.com

email: info@edcon-components.com

EDCON-COMPONENTS

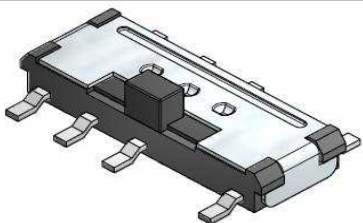

Ordering Informations

Serie	Knob Length (H)	Knob Type	Polarisation Peg	Spezial Function	ROHS	Packing				
-------	-----------------	-----------	------------------	------------------	------	---------	--	--	--	--

Q62019	A	0	Y	0	R	TR				
---------------	----------	----------	----------	----------	----------	-----------	--	--	--	--

A= 1,0mm	0= No function	Y= with Peg	0= No function	R= ROHS Conform	BU= Bulk-Ware
B= 2,5mm					TR= Tape Reel

**SMD-SLIDE-Switch
1,5mm Height**

Part No.: **Q62019**

DRW:	Jason	CHKD	Wilson	MATL:	Wilson	TOLERANCE	Mason	DATE	31.08.2016
APPD:	Schumi			FINISH	Jamy		Sheet No.	2 from 3	

Customer:

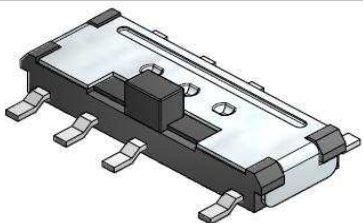

Soldering Profile Curve

Classification Reflow Profile (JEDEC J-STD-020C)



**SMD-SLIDE-Switch
1,5mm Height**

Part No.: **Q62019**

DRW:	Jason	CHKD	Wilson	MATL:	Wilson	TOLERANCE	Mason	DATE	31.08.2016
APPD:	Schumi			FINISH	Jamy		Sheet No.	3 from 3	Customer: