

EDCON-COMPONENTS

Data Sheet M12 Serie



Technical Specification

Connector Type	Sensor (M-Serie)
Connector Spec.	M12 Sensor Connector
Number of contacts	5 contacts
Contact:	Brass w. Gold Plating
Body Material:	PA + Glass Filber
Color:	Black
Accept Conductor	0,75mm ²
Coding Type:	B
O-Ring:	FKM
Screw/Nut:	Brass with Nixkel Plating
Accept hole:	1,2mm max.
Sealing:	Epoxy resin

Electrical Specification

Standard:	IEC 60947-5-2
Operating Temperature	.-25°C ~ +90°C
Poles:	5 contacts
Rated Current:	4A
Nominal Voltage:	60V AC/DC
Insulation Resistance:	> 20M Ohm
Contact Resistance:	< 5 milli Ohm
Degree of Protection:	IP67
Only in locked position with ist proper counterparts	

Technical Drawing

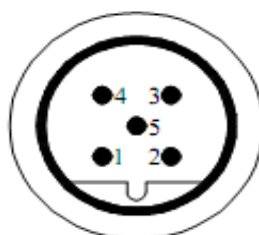
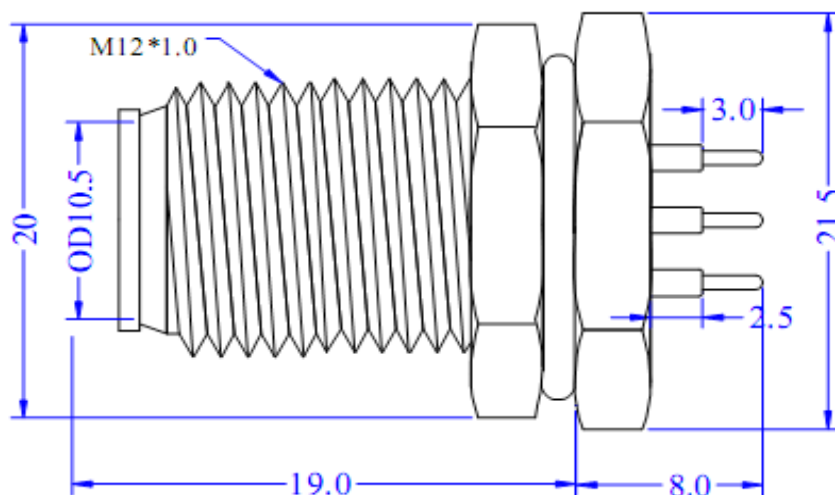

5P

Sensor Connector Type Size M12

EDCON-COMPONENTS

Data Sheet M12 Serie



Ordering Information

Sensor Connector Type Size M12

Serie	Contacts	Contact type	Color			
T61049	5	M	BK			
	5= 5 contacts	M= Male	BK = Black (Standard)			