

EDCON-COMPONENTS

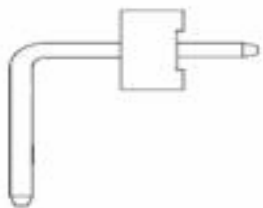

Specifications

Voltage Rating:	250 V AC/DC
Current Rating:	7A AC/DC
Operating Temperature:	-40°C to + 105°C
Contact Resistance:	20 mΩ
Withstanding Voltage:	1000 V AC/Minute
Insulation Resistance:	1000MΩ min.
Material Housing:	PA66 (UL94V-2)
Pin-Material:	Brass /Tin-plated or AU
Body Color:	Natural (White)

Drawing (dimensions all into mm)

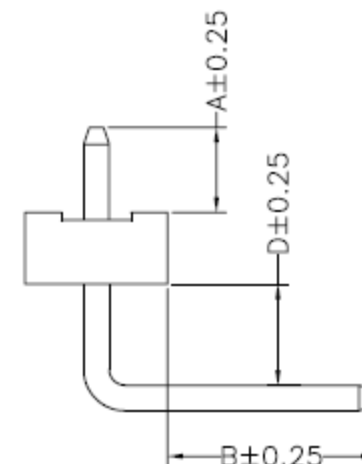
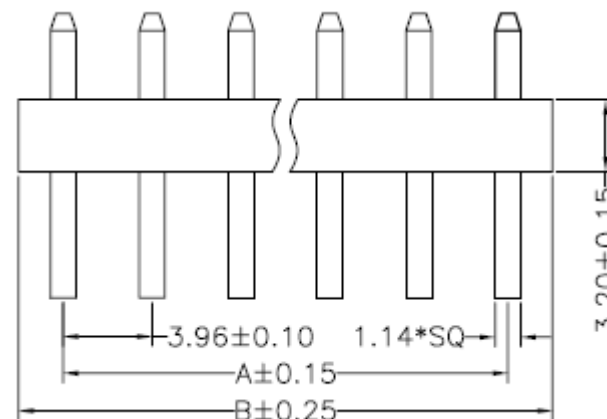
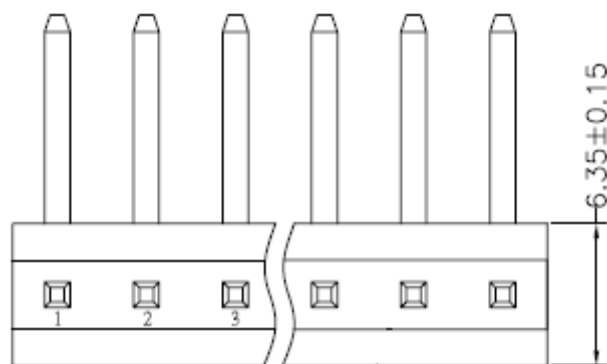

P.C.B. Layout

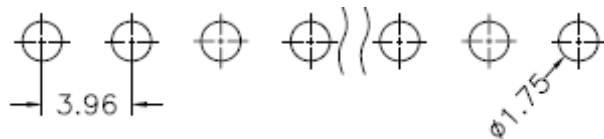

Wafer Serie T68Jxxxx Pitch
3,96mm

Part No.: **T68J025**

Customer:

DRW:	Jason	CHKD	Wilson	MATL:	Wilson	TOLERANCE	Mason	DATE	02.04.2009
APPD:	Schumi			FINISH	Jamy		Sheet No.	1 from 4	

EDCON-COMPONENTS

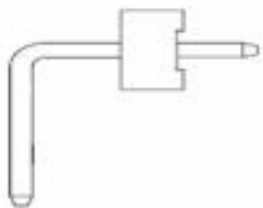

Dimension Information about Housing

Pos.	Dimension (mm)					
	A	B	C	D	E	F
2	3,96	7,92				
3	7,92	11,88				
4	11,88	15,84				
5	15,84	19,80				
6	19,80	23,76				
7	23,76	27,72				
8	27,72	31,68				
9	31,68	35,64				
10	35,64	39,60				
11	39,60	43,56				
12	43,56	47,52				
13	47,52	51,48				
14	51,48	55,44				
15	55,44	59,40				
16	59,40	63,36				
17	63,36	67,32				
18	67,32	71,28				
19	71,28	75,24				
20	75,24	79,20				
21	79,20	83,16				
22	83,16	87,12				
23	87,12	91,08				
24	91,08	95,04				

Code	Pin Length Dimension (mm)					
	A	D	B			
A01	3,80	4,50	9,30			
A02						
A03						
A04						
A05						
A06						
A07						
A08						
A09						
A10						
A11						
A12						
A13						
A14						
A15						
A16						
A17						
A18						
A19						
A20						
A21						
A22						
A23						
A24						

Wafer Serie T68Jxxxx Pitch 3,96mm	
Part No.:	T68J025
Customer:	

DRW:	Jason	CHKD	Wilson	MATL:	Wilson	TOLERANCE	Mason	DATE	02.04.2009
APPD:	Schumi			FINISH	Jamy		Sheet No.		2 from 4

EDCON-COMPONENTS

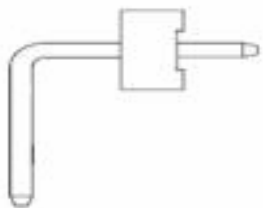

Ordering Informations

Serie	Number of Pos.	Contact Plating	Pin Length	Color of Body	Packing					
-------	----------------	-----------------	------------	---------------	---------	--	--	--	--	--

T68J025	02	TN	A01	WH	BU					
----------------	-----------	-----------	------------	-----------	-----------	--	--	--	--	--

xx = Pos.	TN= tinned	A01= Pin length look table	WH= White	BU= Bulk - Ware					
	AU= Gold plated								

Wafer Serie T68Jxxxx Pitch 3,96mm
Part No.: T68J025
Customer:

DRW:	Jason	CHKD	Wilson	MATL:	Wilson	TOLERANCE	Mason	DATE	02.04.2009
APPD:	Schumi			FINISH	Jamy		Sheet No.		3 from 4

www.edcon-components.com

email: info@edcon-components.com

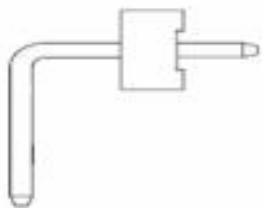

Soldering Profile Curve

Classification Reflow Profile (JEDEC J-STD-020C)

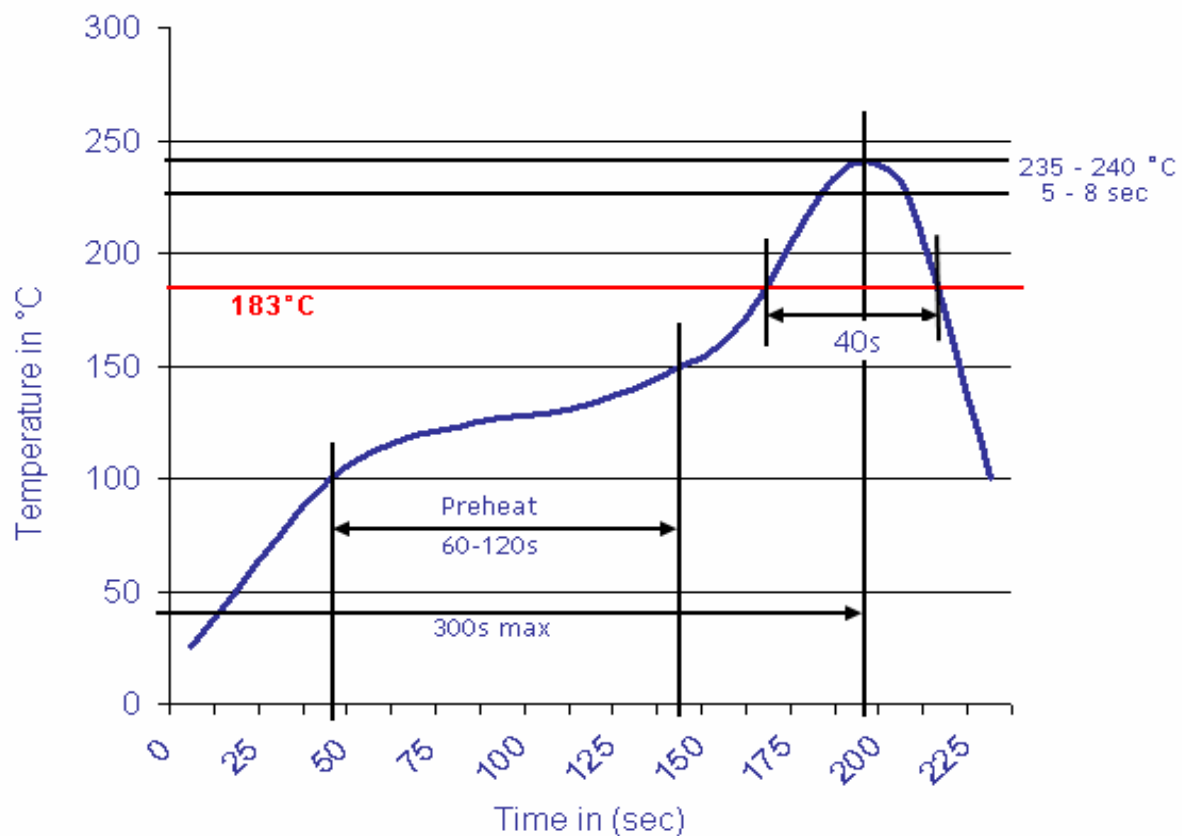

Wafer Serie T68Jxxxx Pitch
3,96mm

Part No.: **T68J025**

DRW:	Jason	CHKD	Wilson	MATL:	Wilson	TOLERANCE	Mason	DATE	02.04.2009
APPD:	Schumi			FINISH	Jamy		Sheet No.	4 from 4	

Customer: