

EDCON-COMPONENTS

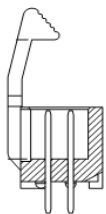

Specifications

Current Rating: 2,0A
 Insulation Resistance: 1000M Ohm min.
 Contact Resistance: 20milli Ohm max.
 Dielectric Voltage: 1000V AC for one minute
 Operating Temperature: -40°C ~ to +105°C
 Insulator Material: NY6T / LCP / NY46

Contact Pin: Brass
 Contact Plating: Gold all over or Selectiv Ni.
 Latches: Zinc Alloy

Drawing

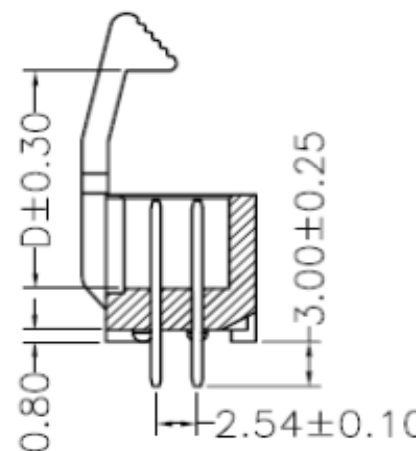
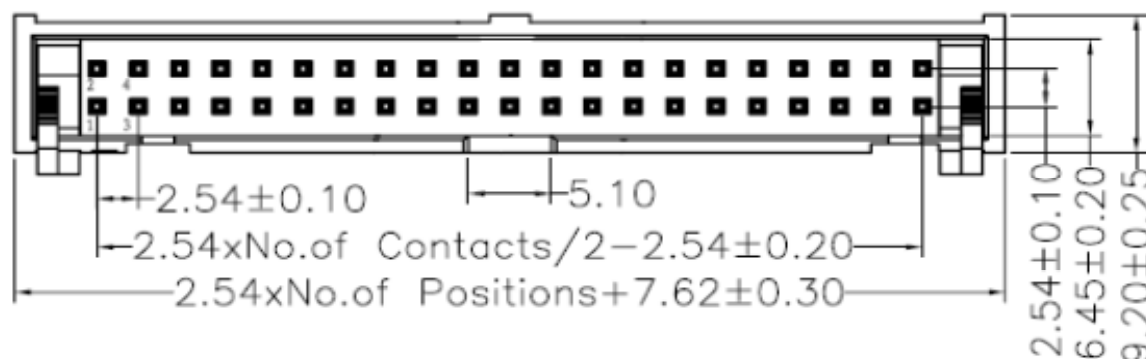
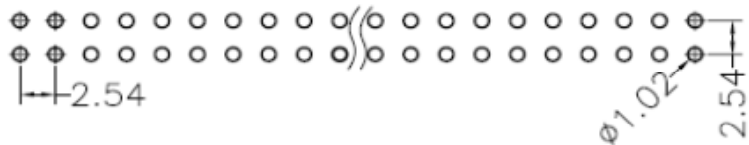
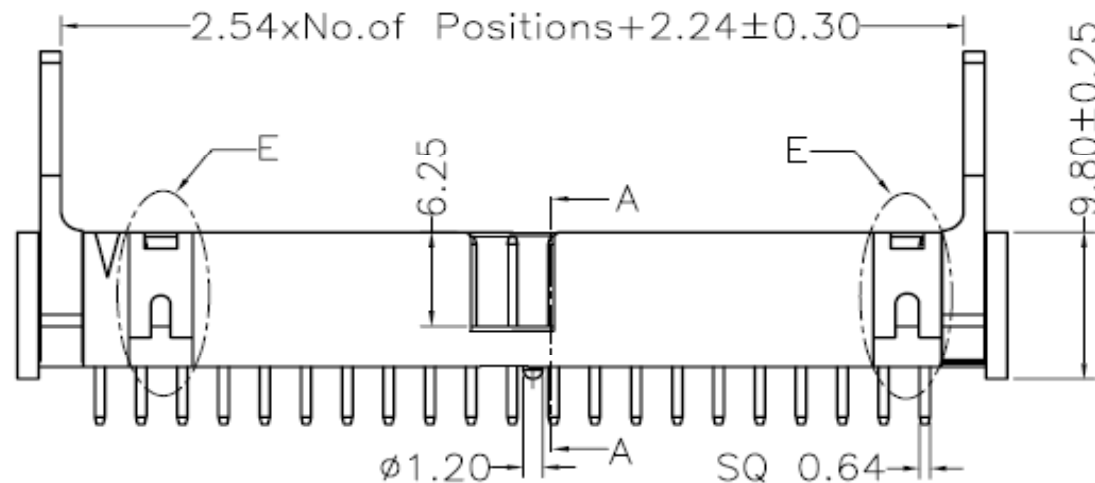

Short Latches
 D=10,65mm
Long Latches
 d=14,55mm

Box Header Pitch
2,54x2,54mm

Part No.: **T16A019-**

Customer:

DRW:	Jason	CHKD	Wilson	MATL:	Wilson	TOLERANCE	Mason	DATE	25.11.2016
APPD:	Schumi			FINISH	Jamy		Sheet No.		1 from 4

EDCON-COMPONENTS

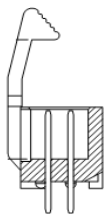

Ordering Informations

Serie	No. of Pos.	Contact Plating	Material	Color of Body	Pin Length Configuration	Latches	ROHS	Packing		
-------	-------------	-----------------	----------	---------------	--------------------------	---------	------	---------	--	--

T16A019-	XX	G0	PB	BK	A00	L	R	BU		
-----------------	-----------	-----------	-----------	-----------	------------	----------	----------	-----------	--	--

XX= 06, 08, 10, 14, 16, 20, 26, 30, 34, 40, 50, 60, 64	G0= Gold Flash	PB= PBT	BK= Black	Axx = Look Table	L= Long Latches	N= NO ROHS conform	BU= Bulk Ware
	T0= Tin plated	NY= NY6T	BL= Blue		S= Short Latches	R= ROHS conform	TU= Tube Packing
	GA= 3µ Gold Plating	LC= LCP	GR= Gray (413°C)				TY= Tray Packing
	GB= 5µ Gold Plating	N4= NY46					
	GC= 10µ Gold Plating						
	GD= 30µ Gold Plating						
	S0= Selectiv Plating Gold Flash / Tin						
	SD= Selectiv Tin/ 5µGold						
SD= Selectiv Tin/ 10µ Gold Flash							
SD= Selectiv Tin/ 20µ Gold	SD= Selectiv Tin/ 30µ Gold						

Box Header Pitch 2,54x2,54mm
Part No.: T16A019-
Customer:

DRW:	Jason	CHKD	Wilson	MATL:	Wilson	TOLERANCE	Mason	DATE	25.11.2016
APPD:	Schumi			FINISH	Jamy		Sheet No.		3 from 4

EDCON-COMPONENTS

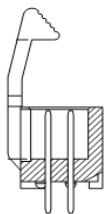

Soldering Profile for Lead Soldering (P.B.T.)

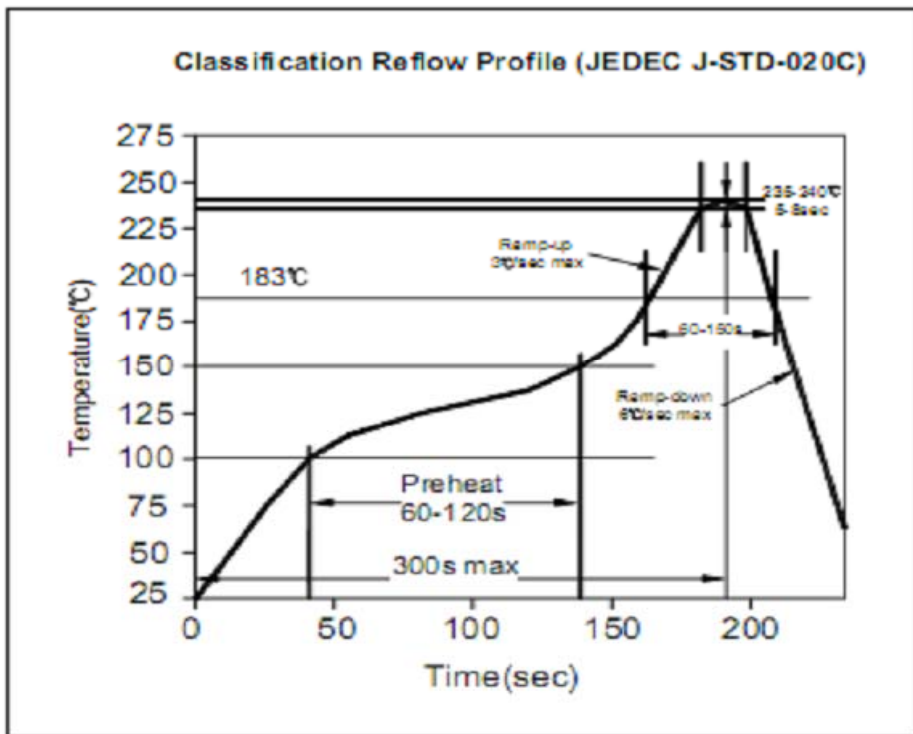

Soldering Profile for Lead Free Soldering (Nylon 6T)

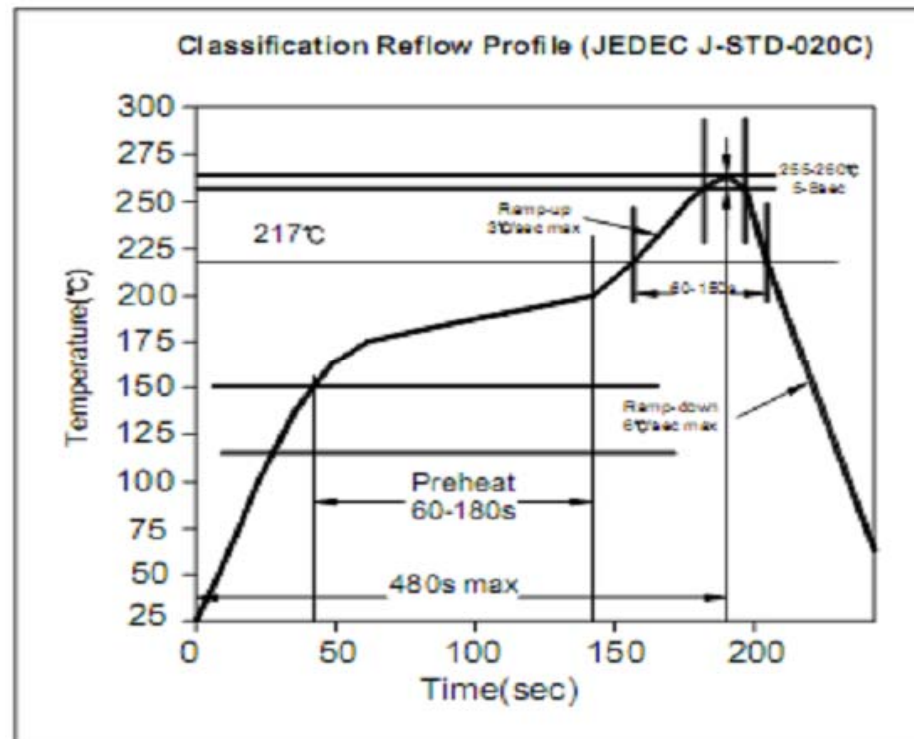

Box Header Pitch
2,54x2,54mm
 Part No.: **T16A019-**

DRW:	Jason	CHKD	Wilson	MATL:	Wilson	TOLERANCE	Mason	DATE	25.11.2016
APPD:	Schumi			FINISH	Jamy		Sheet No.	4 from 4	Customer:

www.edcon-components.com

email: info@edcon-components.com