

# EDCON-COMPONENTS

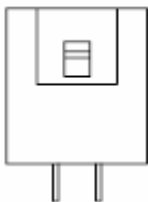

## Specifications

Current Rating: 3,0A  
 Insulation Resistance: 1000M Ohm min.  
 Contact Resistance: 20milli Ohm max.  
 Dielectric Voltage: 500V AC for one minute  
 Operating Temperature: -40°C ~ to +105°C  
 Insulator Material: PBT/PA6T+30% G.F.(UL94V-0)

Contact Pin: Brass  
 Contact Plating: Gold Flash all over

## Drawing

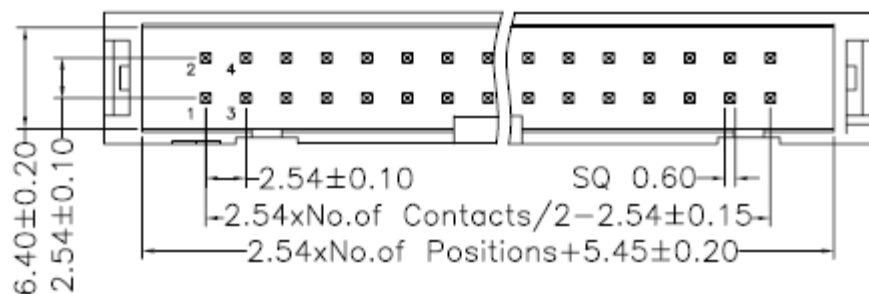
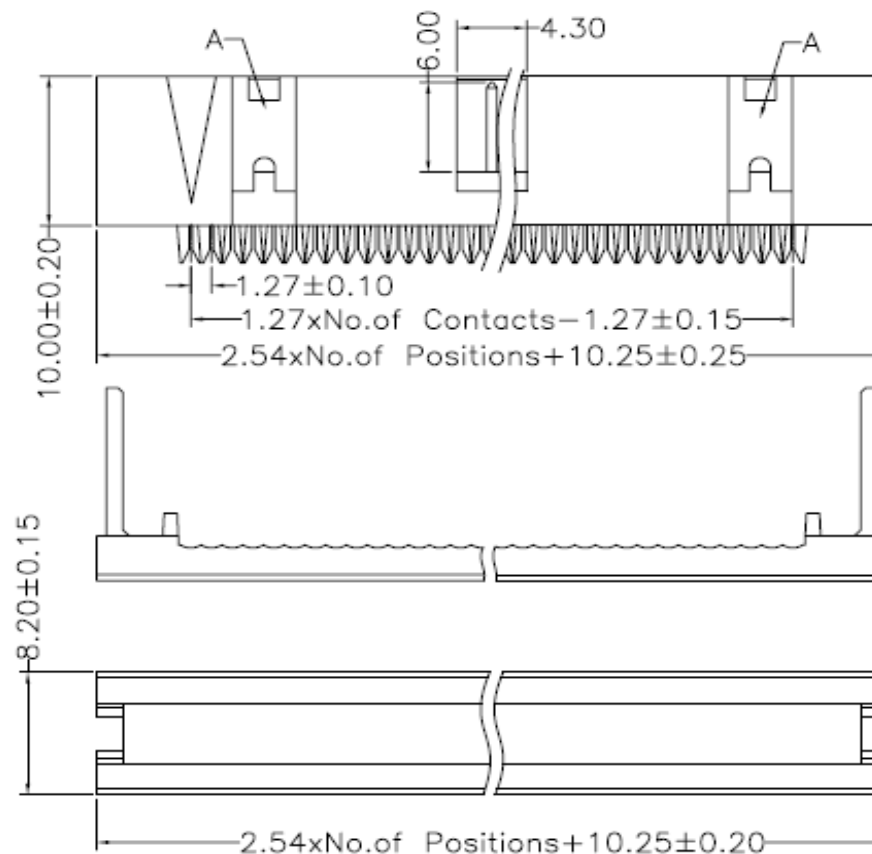
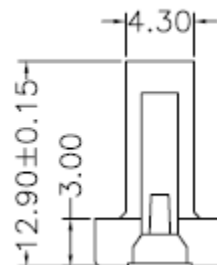
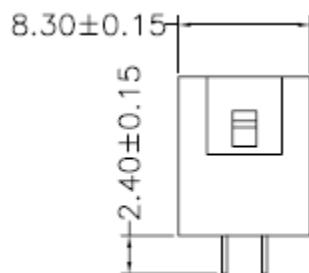

<b>Box Header Pitch</b>	
<b>2,54x2,54mm</b>	
Part No.:	<b>T16A016</b>
Customer:	

DRW:	Jason	CHKD	Wilson	MATL:	Wilson	TOLERANCE	Mason	DATE	10.04.2009
APPD:	Schumi			FINISH	Jamy		Sheet No.	1 from 4	



# EDCON-COMPONENTS

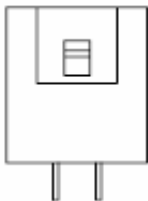

## Ordering Informations

Serie	No. of Pos.	Contact Plating	Material	Color of Body	Pin Length Configuration	ROHS	Packing			
<b>T16A016</b>	<b>XX</b>	<b>G0</b>	<b>PB</b>	<b>BK</b>	<b>A00</b>	<b>R</b>	<b>BU</b>			

<b>XX=</b> 10, 14, 16, 20, 24, 26, 30, 34, 40, 50, 60, 64	<b>G0=</b> Gold Flash	<b>PB=</b> PBT	<b>BK=</b> Black	<b>Axx =</b> Look Table	<b>N=</b> NO ROHS conform	<b>BU=</b> Bulk Ware
	<b>T0=</b> Tin plated	<b>PA=</b> PA6T +30% GF f. ROHS	<b>GR=</b> Gray (427°C)			<b>R=</b> ROHS conform
	<b>GA=</b> 3µ Gold Plating		<b>EG=</b> Gray (413°C)			<b>TC=</b> Tube w. CAP
	<b>GB=</b> 5µ Gold Plating					<b>TY=</b> Tray w.CAP
	<b>GC=</b> 10µ Gold Plating					
	<b>GD=</b> 30µ Gold Plating					
	<b>S0=</b> Selectiv Plating Gold Flash / Tin					
	<b>SD=</b> Selectiv Tin/ 5µGold					
<b>SD=</b> Selectiv Tin/ 10µ Gold Flash						
<b>SD=</b> Selectiv Tin/ 20µ Gold	<b>SD=</b> Selectiv Tin/ 30µ Gold					

<b>Box Header Pitch</b> <b>2,54x2,54mm</b>
Part No.: <b>T16A016</b>
Customer:

DRW:	Jason	CHKD	Wilson	MATL:	Wilson	TOLERANCE	Mason	DATE	10.04.2009
APPD:	Schumi			FINISH	Jamy		Sheet No.		3 from 4

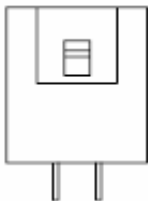

Soldering Profile for Lead Soldering ( P.B.T. )



Soldering Profile for Lead Free Soldering ( Nylon 6T )



<b>Box Header Pitch 2,54x2,54mm</b>	
Part No.:	<b>T16A016</b>
Customer:	

DRW:	Jason	CHKD	Wilson	MATL:	Wilson	TOLERANCE	Mason	DATE	10.04.2009
APPD:	Schumi			FINISH	Jamy		Sheet No.	4 from 4	