

EDCON-COMPONENTS



SPECIFICATION:

Voltage Rating: AC/DC 42V
 Current Rating: 100mA
 Mechanical Life: 1.000.000
 Contact Resistance: 100m Ω max. (initial)
 Insulation Resistance: 1000M Ω min. 100VDC
 Dielectric Strength: 2000VAC.
 Operating Temperature: -40°C ~ +80°C

Drawing

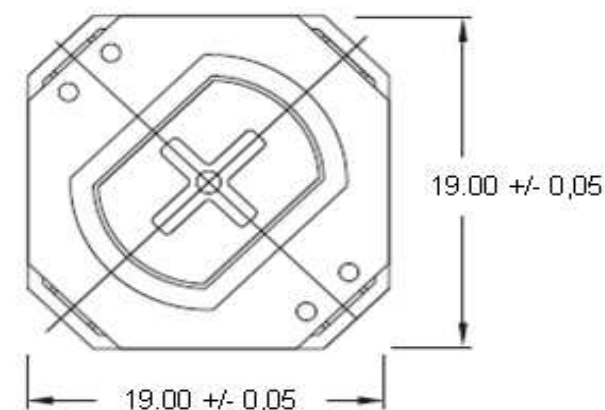
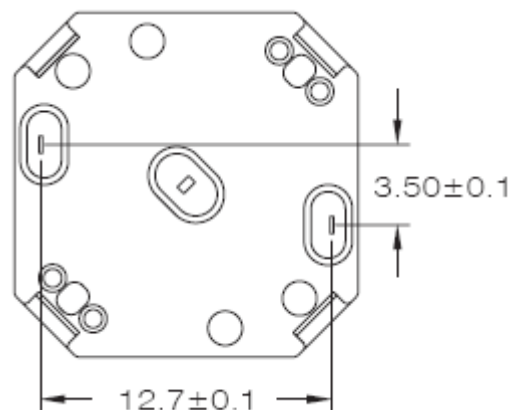

P.C.B Layout

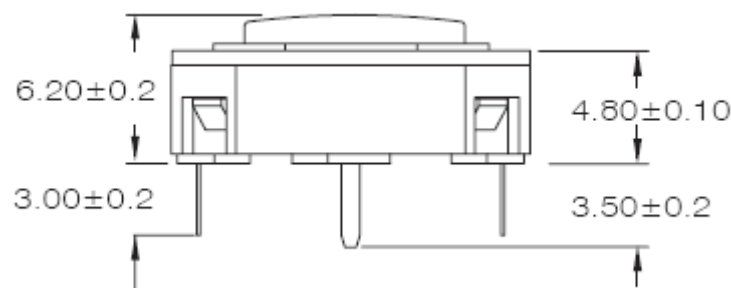
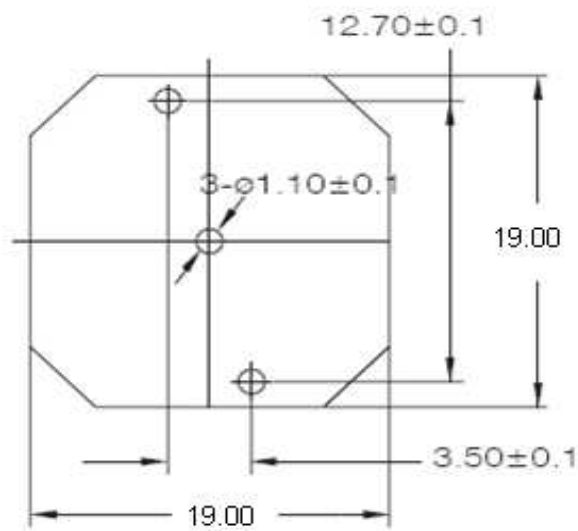

**Alternative to RAFI
19x19mm**

Part No.: **Q11069**

DRW:	Jason	CHKD	Wilson	MATL:	Wilson	TOLERANCE	Mason	DATE	04.03.2011	Customer:
APPD:	Schumi			FINISH	Jamy		Sheet No.	1 from 4		

www.edcon-components.com

email: info@edcon-components.com

Copyright by EDCON-COMPONENTS

EDCON-COMPONENTS



CAP Options / LED Options



Type T1



Type T2



Type T3



w/ or w/o LED

**Alternative to RAFI
19x19mm**

Part No.: **Q11069**

DRW:	Jason	CHKD	Wilson	MATL:	Wilson	TOLERANCE	Mason	DATE	04.03.2011
APPD:	Schumi			FINISH	Jamy		Sheet No.	2 from 4	

Customer:
email: info@edcon-components.com

EDCON-COMPONENTS



Ordering Informations

Serie	Total height w. Body	Operating Force	Contact Material	Electrical life	Cap Option	LED 1 Color	LED 2 Color	ROHS	Packing	
Q11069	062	751	A	105	T1	N	N	R	TU	

062 = 6,2mm	751 = 750gr	A = Gold plated	105 = 1000000 Cycles	T1 = Type 1	N = without LED	N = without LED	N = non ROHS	BU = Bulk Ware
		S = Silver plated		T2 = Type 2	W = White	W = White	R = ROHS conform	TU = Tube Packing
				T3 = Type 3	R = White	R = White		
					Y = White	Y = White		
					G = White	G = White		
					B = White	B = White		

**Alternative to RAFI
19x19mm**

Part No.: **Q11069**

DRW:	Jason	CHKD	Wilson	MATL:	Wilson	TOLERANCE	Mason	DATE	04.03.2011
APPD:	Schumi			FINISH	Jamy		Sheet No.	3 from 4	

Customer:



Soldering Profile Curve

Classification Reflow Profile (JEDEC J-STD-020C)

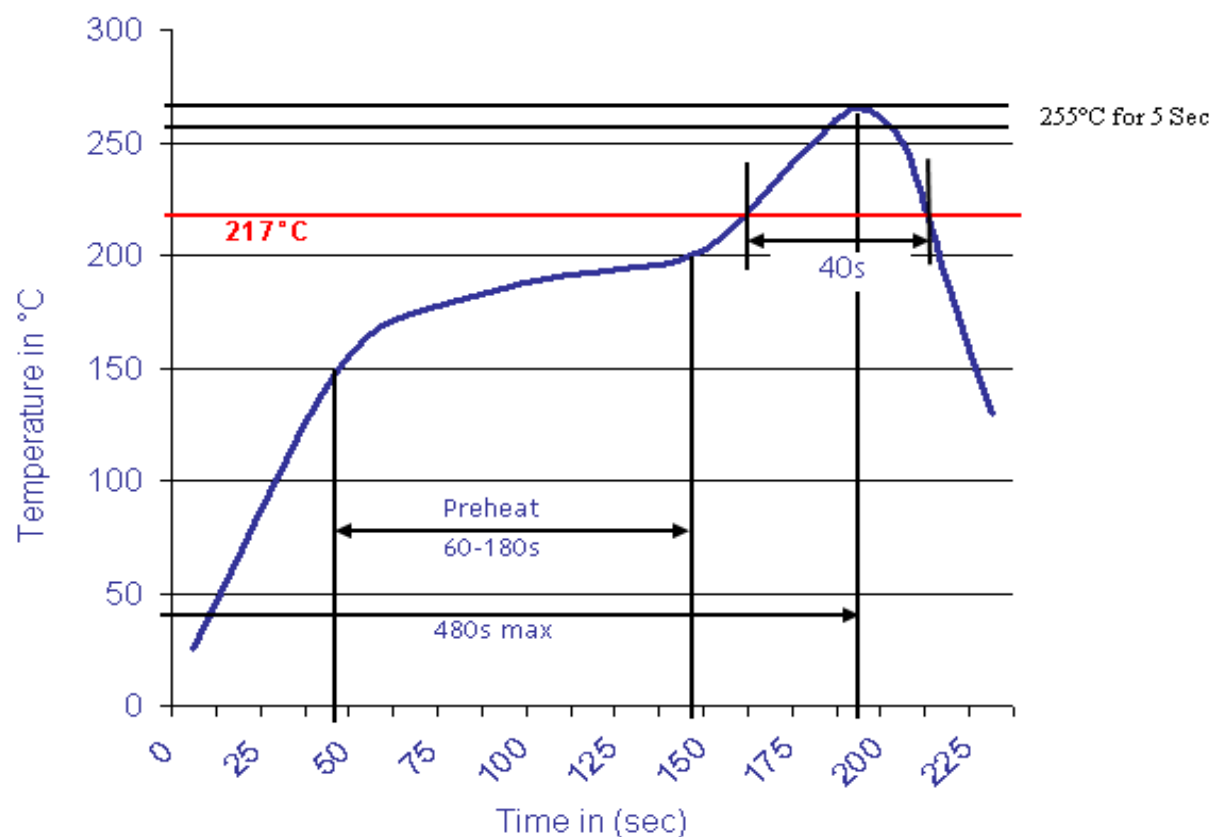
**Alternative to RAFI
19x19mm**

 Part No.: **Q11069**

Customer:

DRW:	Jason	CHKD	Wilson	MATL:	Wilson	TOLERANCE	Mason	DATE	04.03.2011
APPD:	Schumi			FINISH	Jamy		Sheet No.	4 from 4	