

# EDCON-COMPONENTS

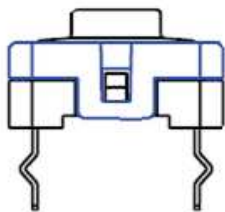

## SPECIFICATION:

Voltage Rating:	AC/DC 42V
Current Rating:	100mA
Mechanical Life:	1.000.000
Contact Resistance:	100m Ω max. (initial)
Insulation Resistance:	1000M Ω min. 100VDC
Dielectric Strength:	250VAC/1min.
Operating Temperature:	.-40°C ~ +80°C

## Drawing

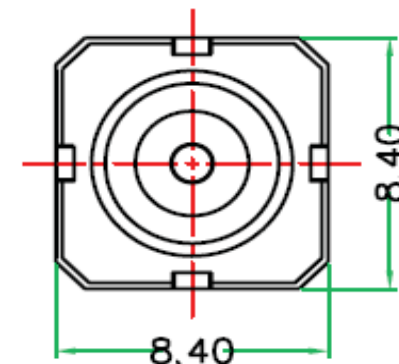
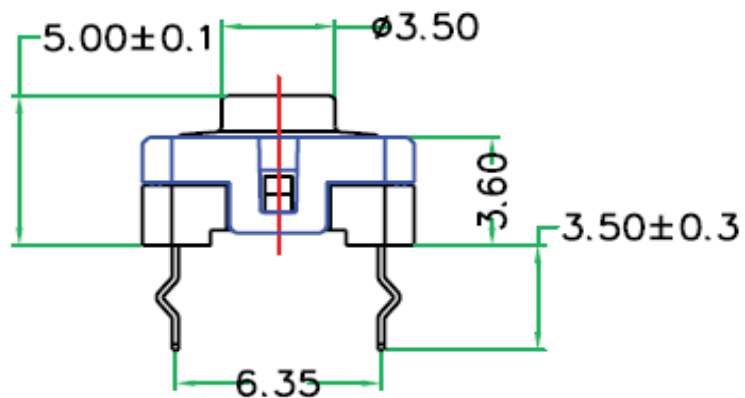

## P.C.B Layout

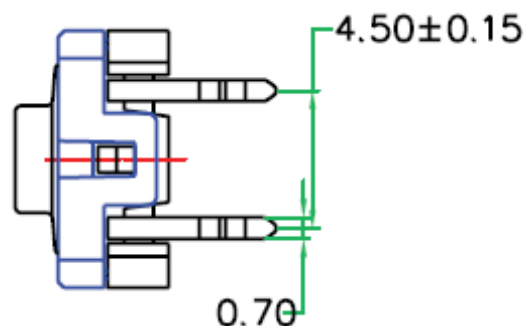
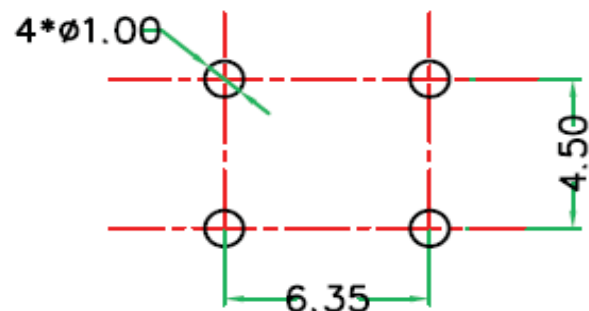

**Alternative to RAFI**

Part No.: **Q11063**

Customer:

DRW:	Jason	CHKD	Wilson	MATL:	Wilson	TOLERANCE	Mason	DATE	04.03.2011
APPD:	Schumi			FINISH	Jamy		Sheet No.	1 from 3	

# EDCON-COMPONENTS

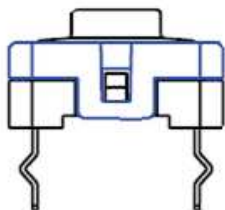

## Ordering Informations

Serie	Total height w. Body	Stem Height	Operating Force	Polarisation Peg	Electrical life	Cap Option	ROHS	Packing		
<b>Q11063</b>	<b>050</b>	<b>A</b>	<b>301</b>	<b>N</b>	<b>105</b>	<b>A</b>	<b>R</b>	<b>TR</b>		

<b>050</b> = 5,0mm	<b>A</b> = 4,95mm	<b>301</b> = 300gr	<b>N</b> = without Peg	<b>105</b> = 1000000 Cycles	<b>A1</b> = Total Height 9,75mm	<b>N</b> = non ROHS	<b>BU</b> = Bulk Ware
	<b>B</b> = 6,30mm	<b>601</b> = 600gr	<b>Y</b> = with Peg		<b>A2</b> = Total Height 12,5mm	<b>R</b> = ROHS conform	<b>TU</b> = Tube Packing
							<b>TR</b> = Tape/Reel Packing

**Alternative to RAFI**

Part No.: **Q11063**

Customer:

DRW:	Jason	CHKD	Wilson	MATL:	Wilson	TOLERANCE	Mason	DATE	04.03.2011
APPD:	Schumi			FINISH	Jamy		Sheet No.	2 from 3	

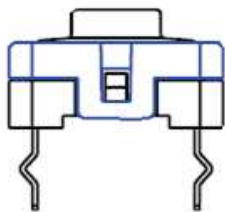

Soldering Profile Curve

Classification Reflow Profile (JEDEC J-STD-020C)

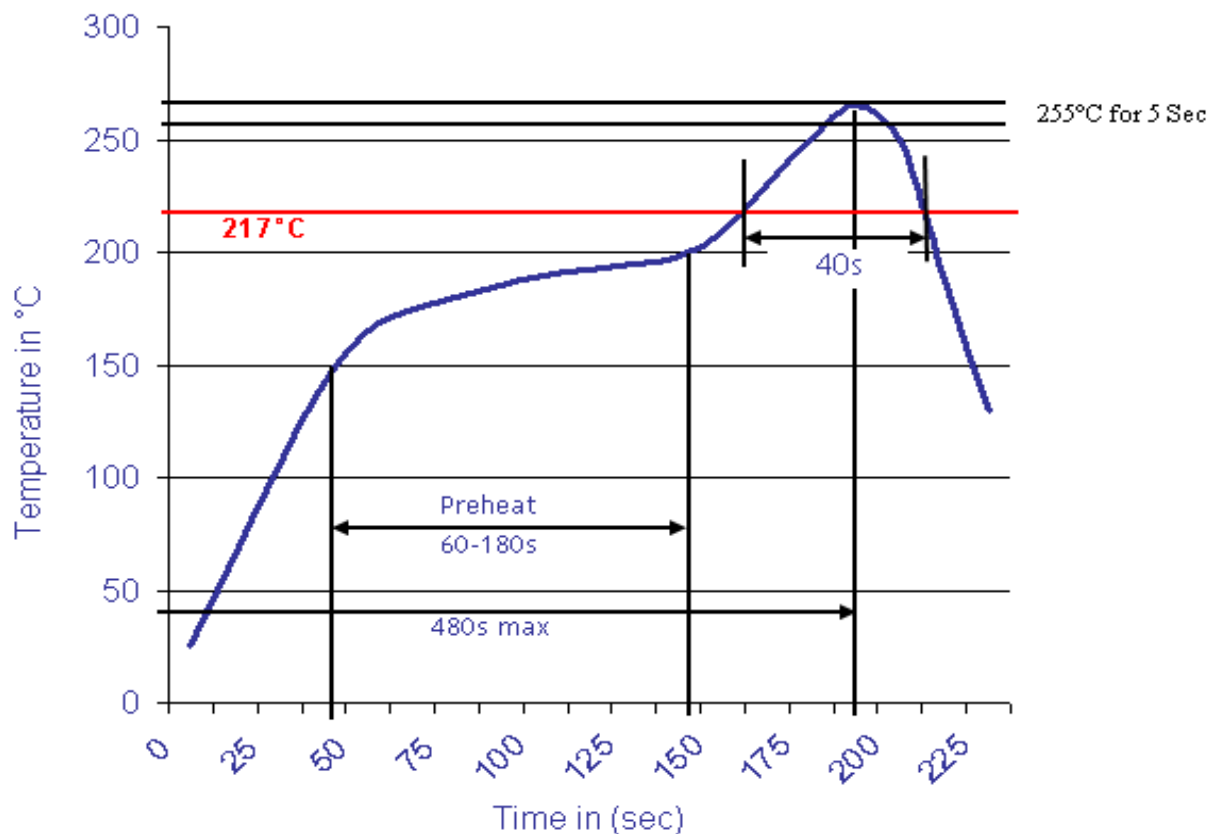

<b>Alternative to RAFI</b>	
Part No.:	<b>Q11063</b>
Customer:	

DRW:	Jason	CHKD	Wilson	MATL:	Wilson	TOLERANCE	Mason	DATE	04.03.2011
APPD:	Schumi			FINISH	Jamy		Sheet No.	3 from 3	