

Technical Specification

Electrical Characteristics

Standard Resistance Range: 220Ω ~ 5,0MΩ
 Resistance Tolerance: +/-30% Standard
 Contact Resistance Variation : ≤3%
 Effective Travel: 215° normal
 Absolute Minimum Resistance: ≤ 1% max.
 Resistance: Essentially infinite:

Environmental Characteristics

Range of Value: 220Ω to 5MΩ
 Resistance Tolerance: 220Ω to 1,0MΩ +/-20% (M)
 Resistance Tolerance: 1,0MΩ to 5,0MΩ +/-30% (N)
 Max. Voltage: 30VDC(lin), 15VDC(no lin)
 Residual Power: @50°C 0,03W(lin) 0,015W(no lin)
 Equivalent Noise Resistance: ≤3% Rn(3Ωmin)
 Operating Temperature: -25°C to +70°C
 Mechanical Life Standard: 500cycles (10000 Cycles)

Features

Carbon Resistive Element
 Dust Proof Enclosure
 Polyester Substrate
 Wider Position at 50% or fully clockwise
 Supplied in magazines for automatic insertion
 Long life model for low cost control potentiometer application
 Self Extinguishable Plastic UL94V-0

Physical Characteristics

Mechanical Angle: 235° +/- 5°
 Electrical Rotation angle: 200° +/-20%
 Torque: 0,2 to 2N-cm
 Stop Torque: ≥4N-cm
 Marking: resistance and date code
 Standard Packing 200pcs/Bag

Technical Dimensions Alternative to Piher 6mm

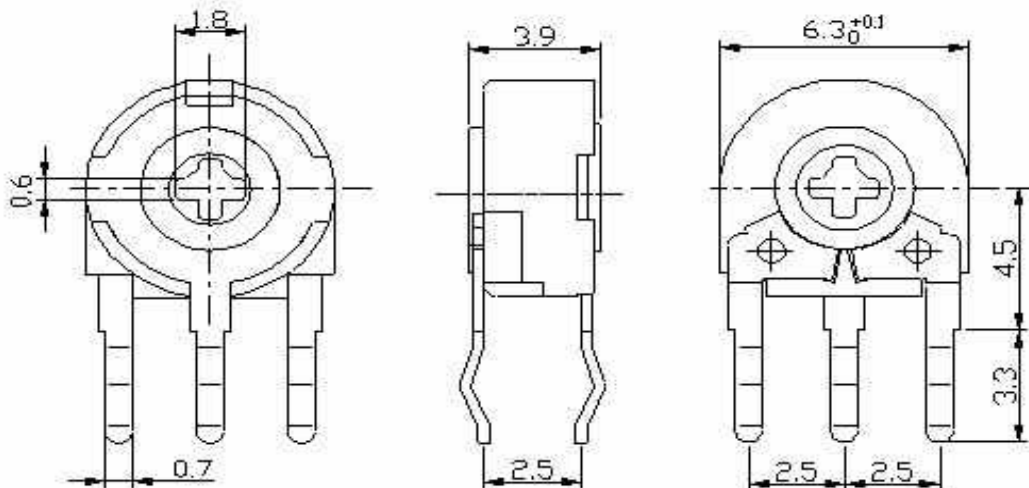

6mm THT Single-Turn Trimmer Type PT6H

X18002

Customer:

| | | | | | | | |
|-------|-------|------|-------|--------|-------|-------|------------|
| DRW: | Jason | CHKD | Jules | MATL: | Wu | DATE | 06.09.2009 |
| APPD: | Join | | | FINISH | Shieh | Sheet | 1 from 3 |

Copyright by EDCON-COMPONENTS H.Schmitt

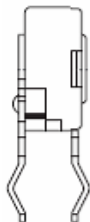

Range Code Table

PCB Layout

| Ordering Code | Range |
|---------------|-------|
| 221 | 220Ω |
| 331 | 330Ω |
| 102 | 1,0KΩ |
| 222 | 2,2KΩ |
| 332 | 3,3KΩ |
| 103 | 10KΩ |
| 223 | 22KΩ |
| 333 | 33KΩ |
| 503 | 50KΩ |
| 104 | 100KΩ |
| 204 | 200KΩ |
| 504 | 500KΩ |
| 105 | 1,0MΩ |
| 205 | 2,0MΩ |
| 505 | 5,0MΩ |

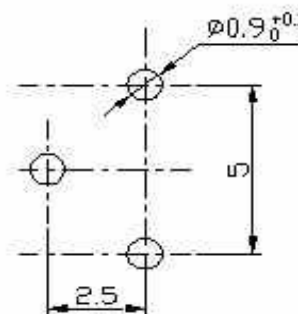

Rotor Style Variation



Style K

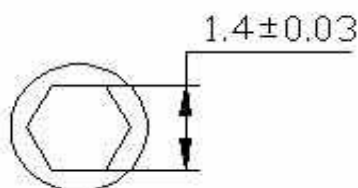

Style M

| | |
|----------------------------------------------|--------|
| 6mm THT Single-Turn Trimmer Type PT6H | |
| 0 | X18002 |
| Customer: | |

| | | | | | | | |
|-------|-------|------|-------|--------|-------|-------|------------|
| DRW: | Jason | CHKD | Jules | MATL: | Wu | DATE | 06.09.2009 |
| APPD: | Join | | | FINISH | Shieh | Sheet | 2 from 3 |

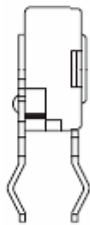

Soldering Profile

Classification Reflow Profile (JEDEC J-STD-020C)

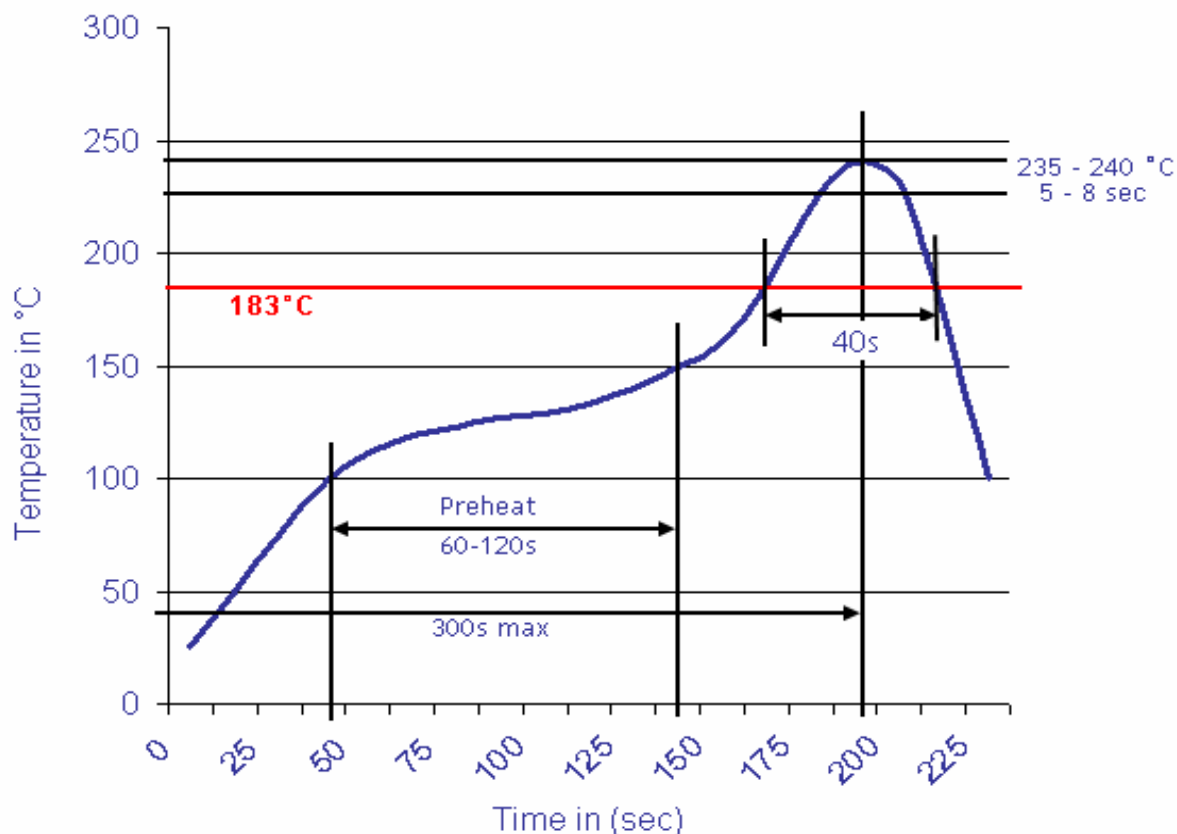

Ordering Information

| Serie | Ordering Code | Tolerance | Curve/ Taper | Rotor for Axle | ROHS | Packing |
|---------------|---------------|-----------|--------------|----------------|----------|--------------|
| X18002 | 101 | M | A | K | R | BU201 |

| | | | | | |
|-------------------|---------------------|-------------------------------|-------------------------|----------------------------|---------------------------------|
| 101 = 100Ω | M = Tol. 20% | A = Linear | K = Cross Slot | R = ROHS conform | BU201 = Bulk-Ware 200PCS |
| | N = Tol. 30% | B = Logarithmisch | M = Digonal Slot | N =NON ROHS conform | MA = Magazine |
| | | C = Anti Logarithmisch | | | |

6mm THT Single-Turn Trimmer Type PT6H

0 **X18002**

Customer:

| | | | | | | | |
|-------|-------|------|-------|--------|-------|-------|------------|
| DRW: | Jason | CHKD | Jules | MATL: | Wu | DATE | 06.09.2009 |
| APPD: | Join | | | FINISH | Shieh | Sheet | 3 from 3 |