

# EDCON-COMPONENTS



## Specifications

### Features

- Plastic material has U/L flammability classification 94V-0
- Reliable low cost construction utilizing molded plastic technique results inexpensive Prod.
- Lead solderable per MIL-STD-202 Method 208
- Ideal for printed circuit board
- Surge overload rating to 200 amperes peak
- Polarity Symbols molded on the body

Weight 6,6gr.

### Maximum Ratings & Electrical Characteristics Ratings at 25°C ambient temperature

	Sym bols	GBU 25A	GBU 25B	GBU 25D	GBU 25G	GBU 25J	GBU 25K	GBU 25M	Unit
Maximum reeurrent peak reverse Voltage	VRRM	50	100	200	400	600	800	1000	Volt
Maximum rms Input voltage	VRMS	35	70	140	280	420	560	700	Volt
Maximum dc blocking Voltage	VDC	50	100	200	400	600	800	1000	Volt
Maximum average forward output rectified TA=100°C	I(AV)	25							Amps
Peak forward surge current 8,3ms single half sine-wave	IFSM	340							Amps
Maximum forward voltage drop	VF	1,0							Volt
Maximum revese voltage TA=25°C	IR	5							µA
Maximum revese voltage TA=125°C	IR	500							µA
Operating and storage temperature range	TJ TSTG	-55°C to + 150°C							°C
Type junction capacitance VR=4,0V f=1,0Mhz	CJ	211			94				pF
Typical thermal resistance junction to case	R 0 JA	21							°C/W

## Technical Drawing (Unit: inch(mm))

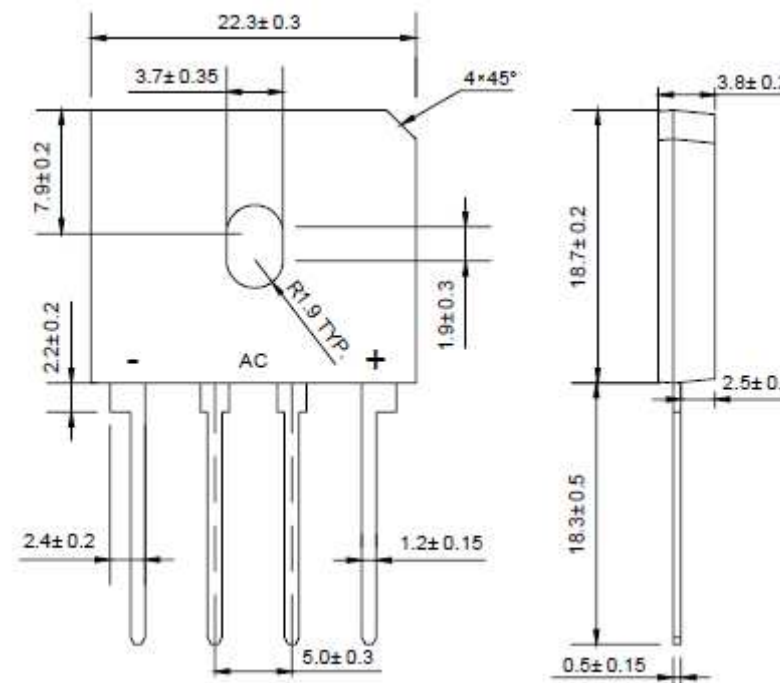

**Single Inline Bridge Rectifier  
25A**

EDCON-Ser. **E15032**

International  
Serie: **GBU25x**

DRW:	Jason	CHKD	Wilson	MATL:	Wilson	TOLERANCE	Mason	DATE	10.05.2010
APPD:	Schumi			FINISH	Jamy		Sheet No.		1 from 5

[www.edcon-components.com](http://www.edcon-components.com)

email: [info@edcon-components.com](mailto:info@edcon-components.com)

# EDCON-COMPONENTS



Rating & Characteristics Curves (TA=25°C unless otherwise noted)

Derating Curve for Output Rectified Current

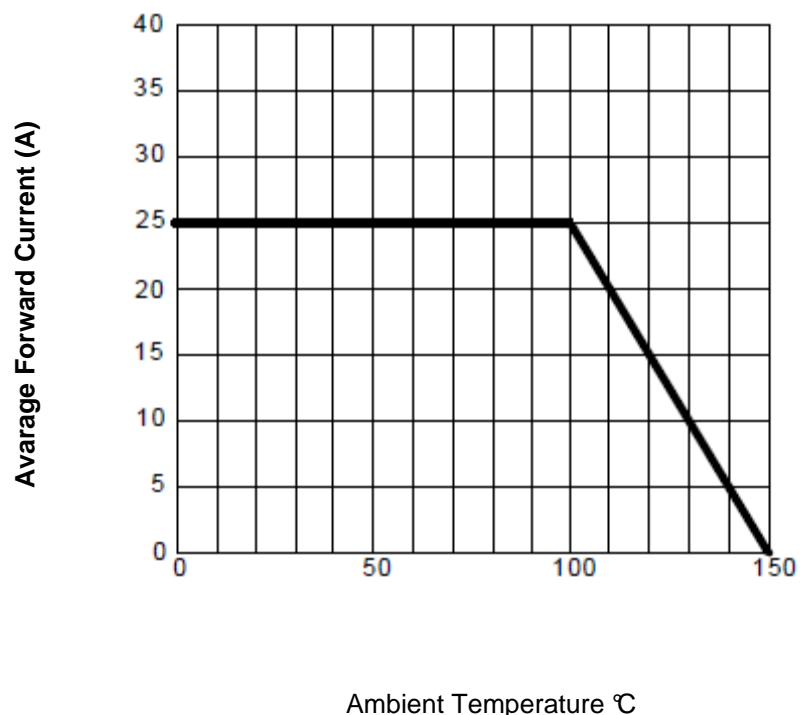

Maximum Forward Surge Current

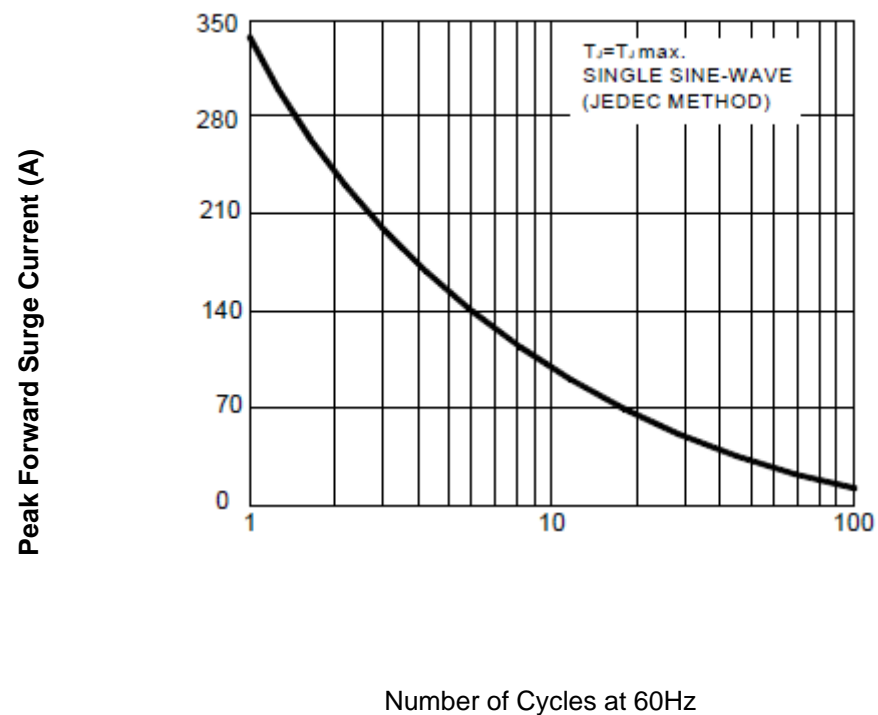

<b>Single Inline Bridge Rectifier 25A</b>	
EDCON-Ser.	<b>E15032</b>
International Serie:	<b>GBU25x</b>

DRW:	Jason	CHKD	Wilson	MATL:	Wilson	TOLERANCE	Mason	DATE	10.05.2010
APPD:	Schumi			FINISH	Jamy		Sheet No.	2 from 5	

[www.edcon-components.com](http://www.edcon-components.com)

email: info@edcon-components.com



Rating & Characteristics Curves (TA=25°C unless otherwise noted)

Typical Forward Characteristics

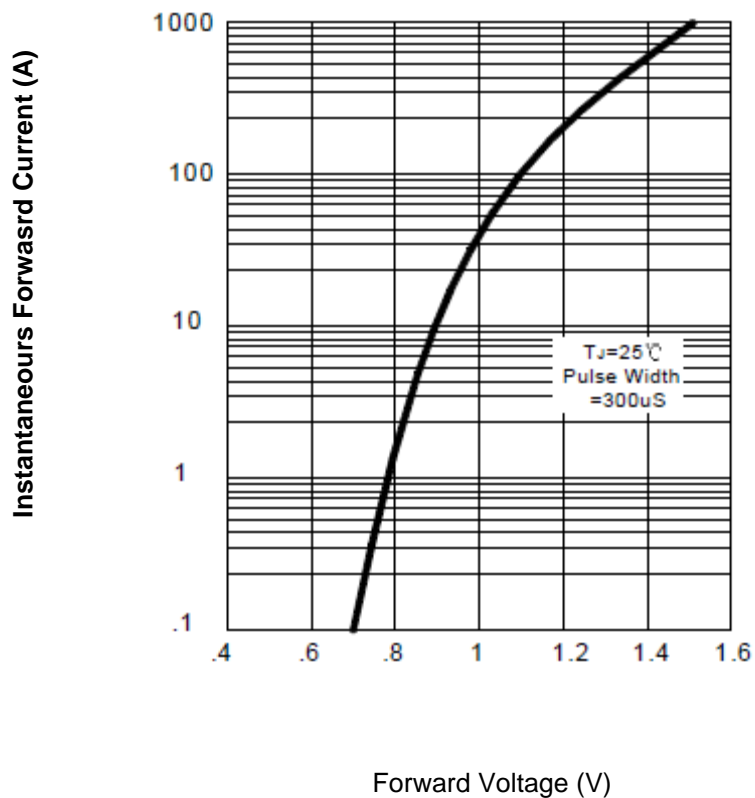

Typical Reverse Characteristics

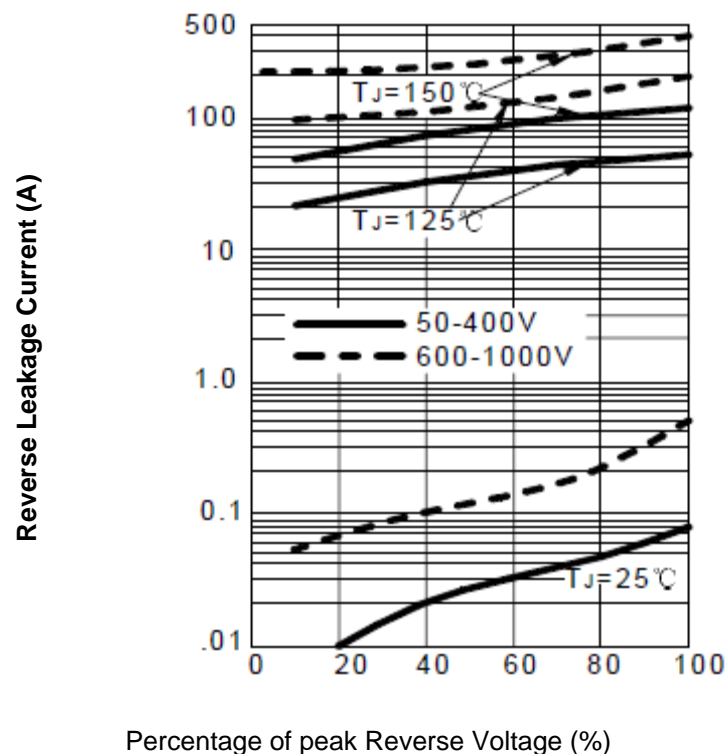

<b>Single Inline Bridge Rectifier 25A</b>	
EDCON-Ser.	<b>E15032</b>
International Serie:	<b>GBU25x</b>

DRW:	Jason	CHKD	Wilson	MATL:	Wilson	TOLERANCE	Mason	DATE	10.05.2010
APPD:	Schumi			FINISH	Jamy		Sheet No.	3 from 5	

# EDCON-COMPONENTS



Rating & Characteristics Curves (TA=25°C unless otherwise noted)

Forward Current Derating Curve

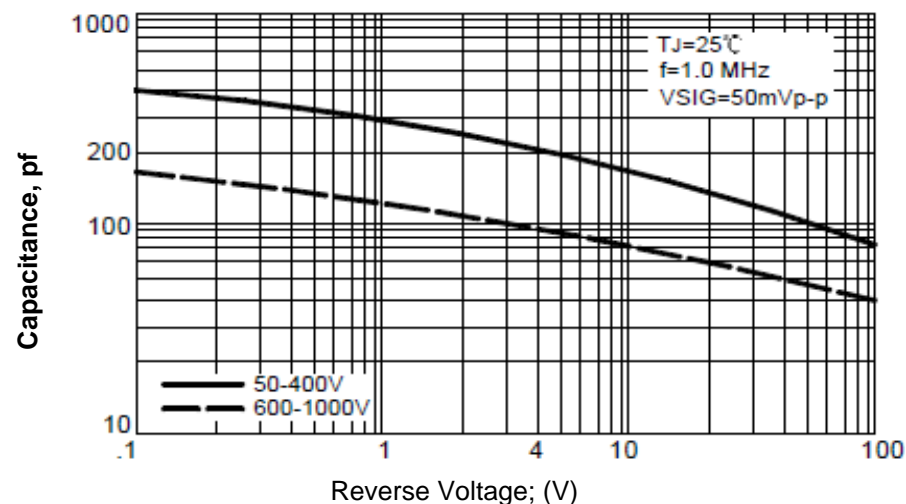

## Ordering Informations

EDCON Serie	International Type	NO function	ROHS	Package					
<b>E15032</b>	<b>GBU25x</b>	<b>LL</b>	<b>R</b>	<b>BX</b>					

Look Voltage Code Table	<b>LL</b> = Long Lead	<b>R</b> = ROHS Conform	<b>BX</b> = Box
	<b>L4</b> = Lead length 4mm	<b>N</b> = NON ROHS Conform	

<b>Single Inline Bridge Rectifier 25A</b>	
EDCON-Ser.	<b>E15032</b>
International Serie:	<b>GBU25x</b>

DRW:	Jason	CHKD	Wilson	MATL:	Wilson	TOLERANCE	Mason	DATE	10.05.2010
APPD:	Schumi			FINISH	Jamy		Sheet No.		4 from 5

[www.edcon-components.com](http://www.edcon-components.com)

email: [info@edcon-components.com](mailto:info@edcon-components.com)



Soldering Profile Curve

Classification Reflow Profile (JEDEC J-STD-020C)

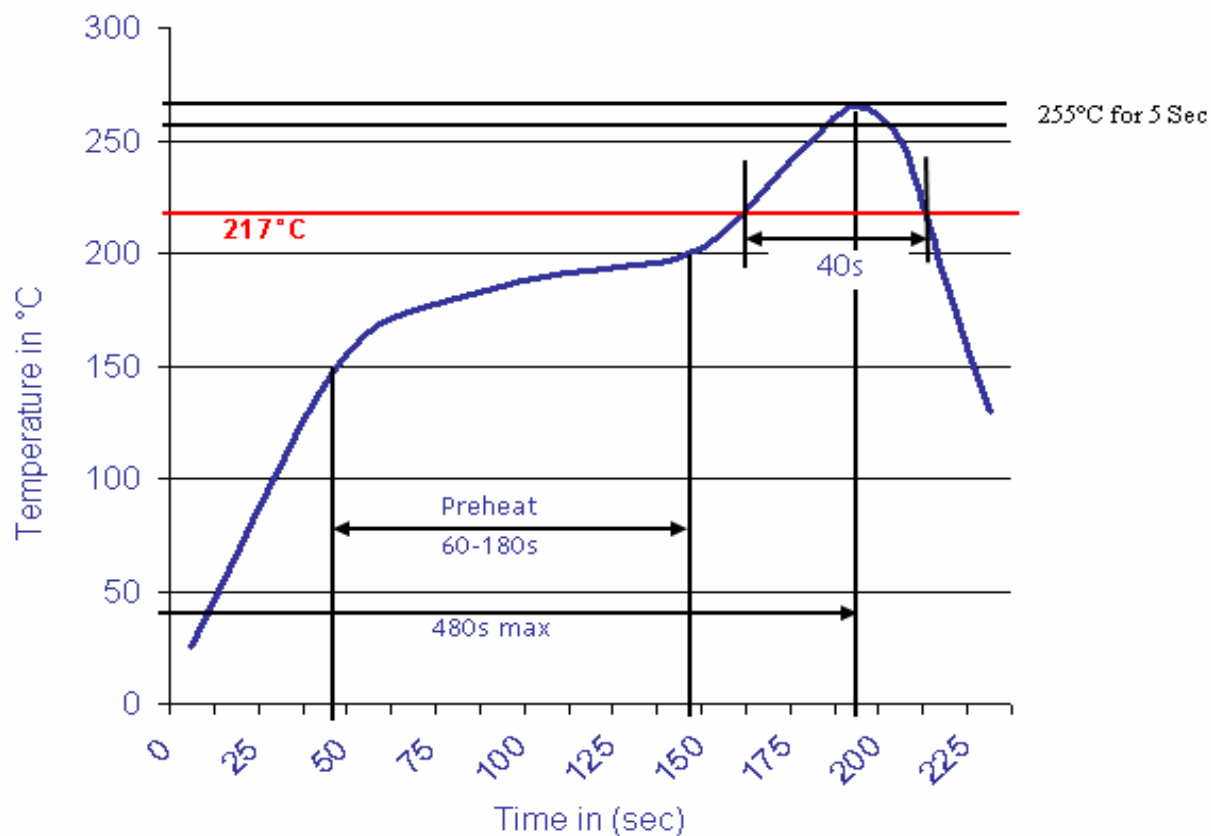

<b>Single Inline Bridge Rectifier 25A</b>	
EDCON-Ser.	<b>E15032</b>
International Serie:	<b>GBU25x</b>

DRW:	Jason	CHKD	Wilson	MATL:	Wilson	TOLERANCE	Mason	DATE	10.05.2010
APPD:	Schumi			FINISH	Jamy		Sheet No.	5 from 5	