

# Data Sheet

## Pluggable Terminal Block (Plug)

**Pitch: 5,00 mm**

**Serie: A14L104**

### Customer Information for special Item

**EDCON Customer : xxxxxx**

**Customer Version No. : xx**

# EDCON-COMPONENTS



## Technical Discription

## Drawing (Dimension in mm)

Electrical	UL	IEC
Rated Voltage	300Volt	
Rated Current	15A	
Wire Range	0,5~1,5mm <sup>2</sup>	
Wire Range AWG-Size	12 ~ 30	
Withstanding Voltage		2,5KV
Insulation Resistance		5000MΩ / 1000V
Mechanical		
Operating Temperature		-40°C ~ +115°C
Wire Strip Length		6-7mm
Screw Torque		3,5
Screw Size		M3
Dimensions		
Pitch (mm)		5,00
Poles		2 ~ 24 Pos.
Materials		
Terminal Housing		Thermoplastic, UL94V-0
Pin Header		Brass Tin Plated
Screw		Steel Ni-plated / Zinc Plated
Cage		Brass Ni Plated

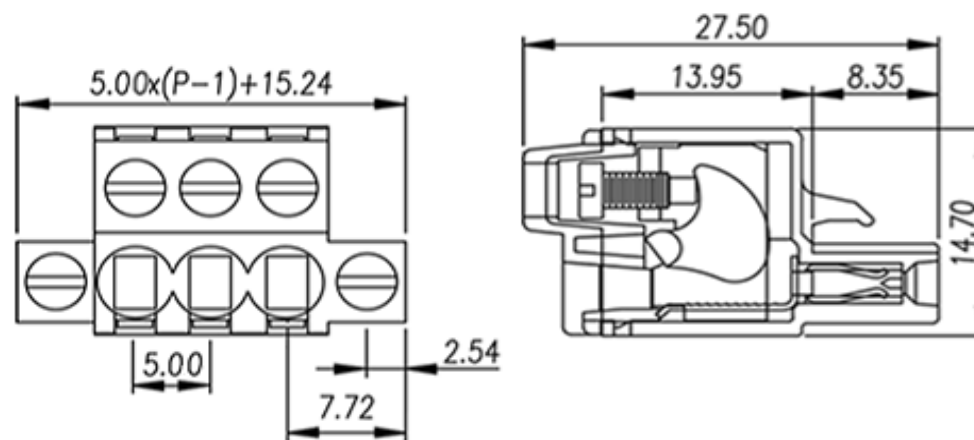

<b>Pluggable Terminal Block (Plug)</b>	
Part No.:	<b>A14L104</b>
Customer:	

DRW:	Jason	CHKD	Wilson	MATL:	Wilson	TOLERANCE	Mason	DATE	23.04.2017
APPD:	Schumi			FINISH	Jamy		Sheet No.		1 from 4

# EDCON-COMPONENTS



## Dimension Tolerance (mm)

No. of Pos.	A	Tol. A	B	Tol. B
02	20,16	± 0,10	5,00	± 0,10
03	25,16	± 0,10	10,00	± 0,10
04	30,16	± 0,10	15,00	± 0,10
05	35,16	± 0,10	20,00	± 0,10
06	40,16	± 0,10	25,00	± 0,10
07	45,16	± 0,10	30,00	± 0,10
08	50,16	± 0,10	35,00	± 0,10
09	55,16	± 0,20	40,00	± 0,20
10	60,16	± 0,20	45,00	± 0,20
11	65,16	± 0,20	50,00	± 0,20
12	70,16	± 0,20	55,00	± 0,20
13	75,16	± 0,20	60,00	± 0,20
14	80,16	± 0,20	65,00	± 0,20
15	85,16	± 0,20	70,00	± 0,20
16	90,16	± 0,20	75,00	± 0,20
17	95,16	± 0,30	80,00	± 0,30
18	100,16	± 0,30	85,00	± 0,30
19	105,16	± 0,30	90,00	± 0,30
20	110,16	± 0,30	95,00	± 0,30
21	115,16	± 0,30	100,00	± 0,30
22	120,16	± 0,30	105,00	± 0,30
23	125,16	± 0,30	110,00	± 0,30
24	130,16	± 0,30	115,00	± 0,30

### Pluggable Terminal Block (Plug)

Part No.: **A14L104**

Customer:

DRW:	Jason	CHKD	Wilson	MATL:	Wilson	TOLERANCE	Mason	DATE	23.04.2017
APPD:	Schumi			FINISH	Jamy		Sheet No.		2 from 4



# EDCON-COMPONENTS



## Ordering Informations

Serie	No. of Pos.	Body Color	Screw Type	Approval Code	ROHS	Packing	EDCON Cust. No.	Customer Version		
<b>A14L104</b>	<b>02</b>	<b>PG</b>	<b>A</b>	<b>N</b>	<b>R</b>	<b>B</b>	<b>xxxxxx</b>	<b>xx</b>		

Pitch  
5,00

02= Number of Pos. Standard 2 ~ 24Pos.	PG= Phoenix Green (Standard)	A= Slotted Screw Type (Standard) 	N= NON Approval	R= ROHS Conform	B= Bulk-Ware I= Individual Package	xxxxxx= Customer Number	xx= Customer Version ??(Printing)
	WH= White		A= UL /UR Approval Please consult EDCON for available	N= NON ROHS Conform			
	GN= Green	B= Cross Slotted Screw Type 	B= VDE Approval Please consult EDCON for available	C= TÜV Approval Please consult EDCON for available			
	GY= Gray						
	LG= Light Gray						
	OR= Orange	C= Screwless Type	1= UL Approval for Material				
	BL= Blue						
BK= Black							

**Pluggable Terminal Block (Plug)**

Part No.: **A14L104**

DRW:	Jason	CHKD	Wilson	MATL:	Wilson	TOLERANCE	Mason	DATE	23.04.2017
APPD:	Schumi			FINISH	Jamy		Sheet No.		3 from 4

Customer:



Soldering Profile Curve

Classification Reflow Profile (JEDEC J-STD-020C)

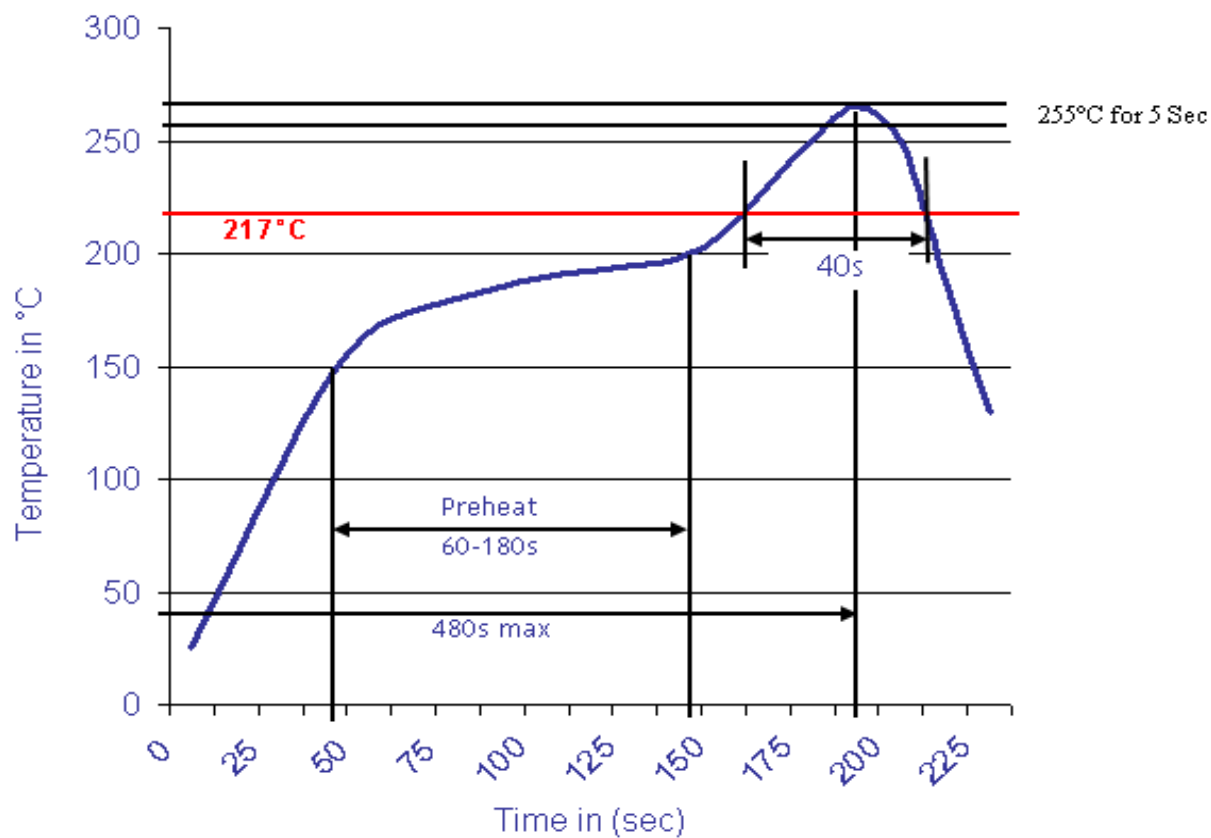

**Pluggable Terminal Block (Plug)**

Part No.: **A14L104**

Customer:

DRW:	Jason	CHKD	Wilson	MATL:	Wilson	TOLERANCE	Mason	DATE	23.04.2017
APPD:	Schumi			FINISH	Jamy		Sheet No.	4 from 4	