

# EDCON-COMPONENTS

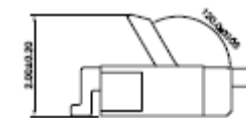

## Materials

Housing: LCP Natural  
 Cover: PPS Black  
 Contact: Phosphor Bronze  
 Latch: Phosphor Bronze

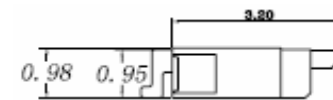
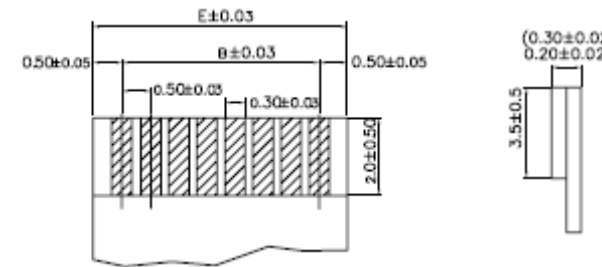
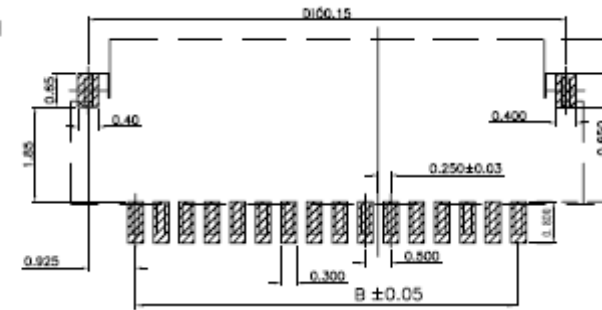
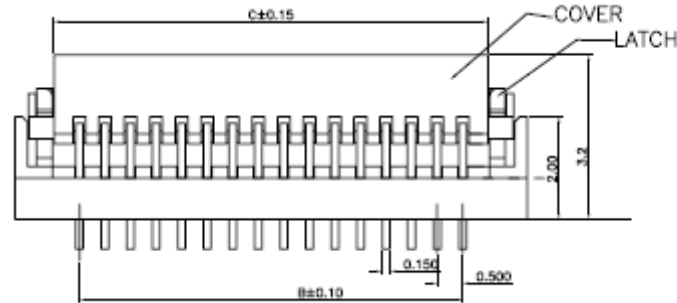

CKT	A	B	C	D	E	CKT	A	B	C	D	E
4	4.0	1.5	2.5	3.35	2.5	23	13.5	11.0	12.0	12.85	12.0
5	4.5	2.0	3.0	3.85	3.0	24	14.0	11.5	12.5	13.35	12.5
6	5.0	2.5	3.5	4.35	3.5	25	14.5	12.0	13.0	13.85	13.0
7	5.5	3.0	4.0	4.85	4.0	26	15.0	12.5	13.5	14.35	13.5
8	6.0	3.5	4.5	5.35	4.5	27	15.5	13.0	14.0	14.85	14.0
9	6.5	4.0	5.0	5.85	5.0	28	16.0	13.5	14.5	15.35	14.5
10	7.0	4.5	5.5	6.35	5.5	29	16.5	14.0	15.0	15.85	15.0
11	7.5	5.0	6.0	6.85	6.0	30	17.0	14.5	15.5	16.35	15.5
12	8.0	5.5	6.5	7.35	6.5	31	17.5	15.0	16.0	16.85	16.0
13	8.5	6.0	7.0	7.85	7.0	32	18.0	15.5	16.5	17.35	16.5
14	9.0	6.5	7.5	8.35	7.5	33	18.5	16.0	17.0	17.85	17.0
15	9.5	7.0	8.0	8.85	8.0	34	19.0	16.5	17.5	18.35	17.5
16	10.0	7.5	8.5	9.35	8.5	35	19.5	17.0	18.0	18.85	18.0
17	10.5	8.0	9.0	9.85	9.0	36	20.0	17.5	18.5	19.35	18.5
18	11.0	8.5	9.5	10.35	9.5	37	20.5	18.0	19.0	19.85	19.0
19	11.5	9.0	10.0	10.85	10.0	38	21.0	18.5	19.5	20.35	19.5
20	12.0	9.5	10.5	11.35	10.5	39	21.5	19.0	20.0	20.85	20.0
21	12.5	10.0	11.0	11.85	11.0	40	22.0	19.5	20.5	21.35	20.5
22	13.0	10.5	11.5	12.35	11.5	---	---	---	---	---	---

**Non-Zif FPC / FFC Connector**  
**Pitch: 0.50mm**

Part No.: **T28H004**

DRW:	Jason	CHKD	Wilson	MATL:	Wilson	TOLERANCE	Mason	DATE	21.04.2013	Customer:
APPD:	Schumi			FINISH	Jamy		Sheet No.		1 from 2	

# EDCON-COMPONENTS



## Odering Information

Serie	-	Number of Contact	Contact Plating	Insulator Color	Packing Style					
T28H004	-	04	T	2	TU					
EDCON-Serie	-	04 = 4 Con. ... 40 = 40 Con.	T = Tin Plated G = Flash Gold	2 = Ivory (Standard) 1 = Black	TU = Tube (Standard) TR = Tape Reel (on Request)					

## Soldering Profile Curve

Classification Reflow Profile (JEDEC J-STD-020C)

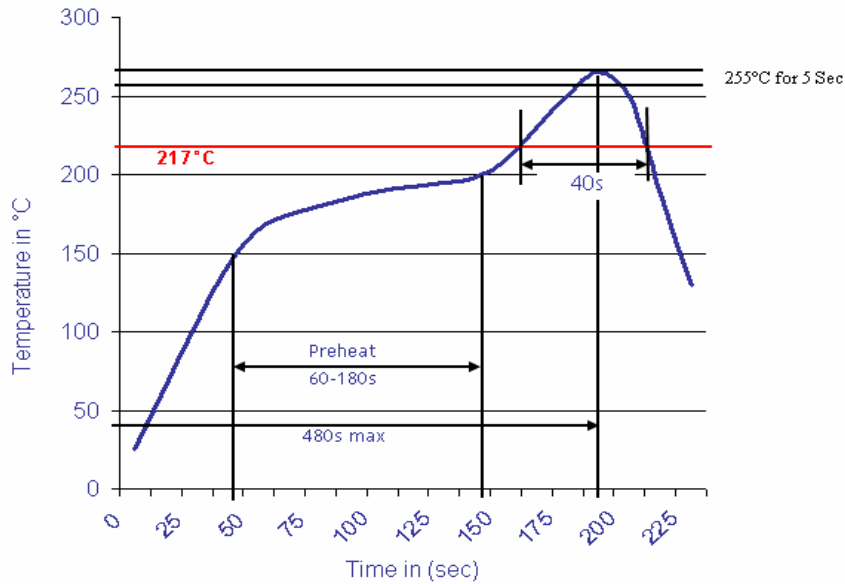

<b>Non-Zif FPC / FFC Connector</b>	
<b>Pitch: 0.50mm</b>	
Part No.:	<b>T28H004</b>

DRW:	Jason	CHKD	Wilson	MATL:	Wilson	TOLERANCE	Mason	DATE	21.04.2013	Customer:
APPD:	Schumi			FINISH	Jamy		Sheet No.	2 from 2		