



Technical Specification

Insulator Material:	
Contact Resistance:	30m Ohm max.
Insulator Resistance:	1000M Ohm max.
Temperature Rating:	-.55°C ~ 85°C
Contact Material:	Steel
Contact:	Tin Plated
Dielectric Voltage:	750VAC
Durability:	50 Cycles min.
Application for:	Coin Type
Battery Type:	1220, 1225, 1216



Ordering Information

Serie	Contact Material	Contact Plating	ROHS	Packing		
-------	------------------	-----------------	------	---------	--	--

B23070	-	ST	NI	R	BU	
---------------	---	-----------	-----------	----------	-----------	--

		N= Non ROHS	BU= Bulk-Ware
		R= ROHS Conform	TY= Tray
ST= Steel	NI= Nickel plated		

Battery Coin Cell Holder							
Part No.:	B23070						
Customer:							
DRW:	Jason	CHKD	Jules	MATL:	Wu	DATE	01.11.2018
APPD:	Join			FINISH	Shieh	Sheet	1 from 3



Technical Dimensions

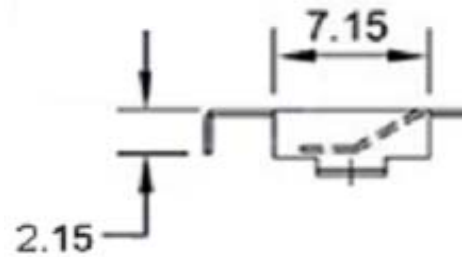
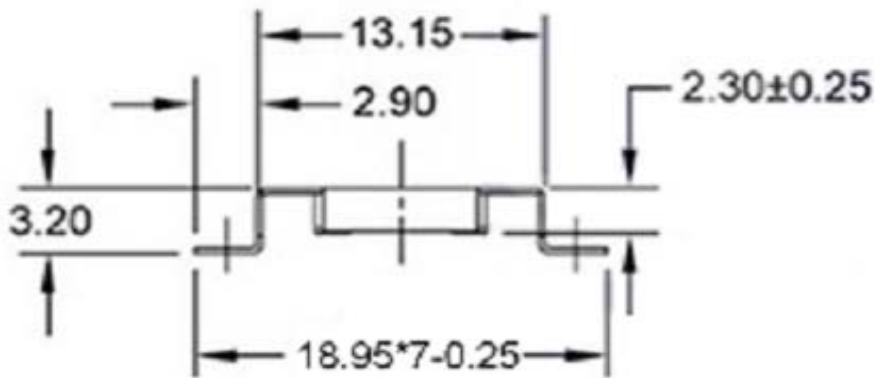
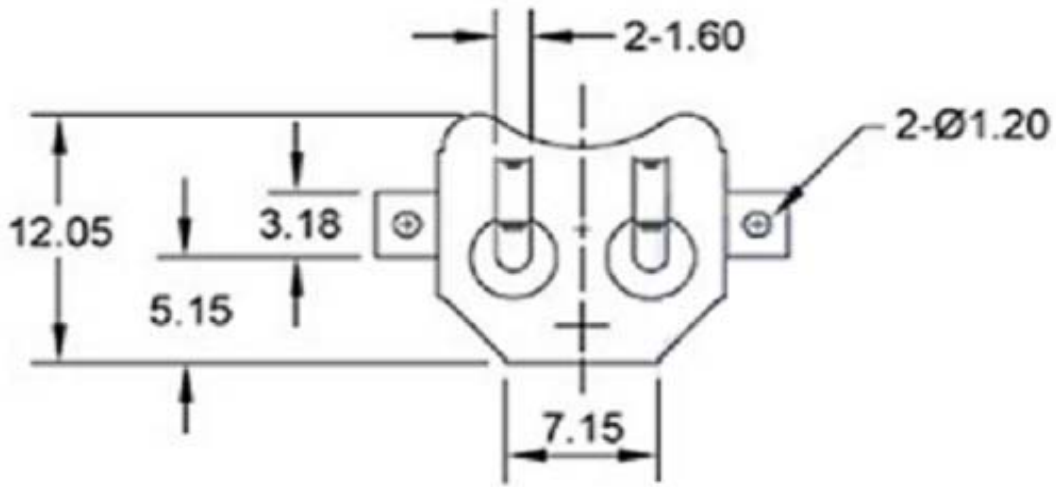

PCB Layout (mm)

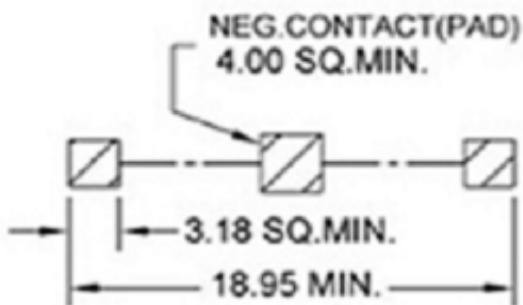

Battery Coin Cell Holder

Part No.: **B23070**

Customer:

DRW:	Jason	CHKD	Jules	MATL:	Wu	DATE	01.11.2018
APPD:	Join			FINISH	Shieh	Sheet	2 from 3



Soldering Profile Curve

Classification Reflow Profile (JEDEC J-STD-020C)

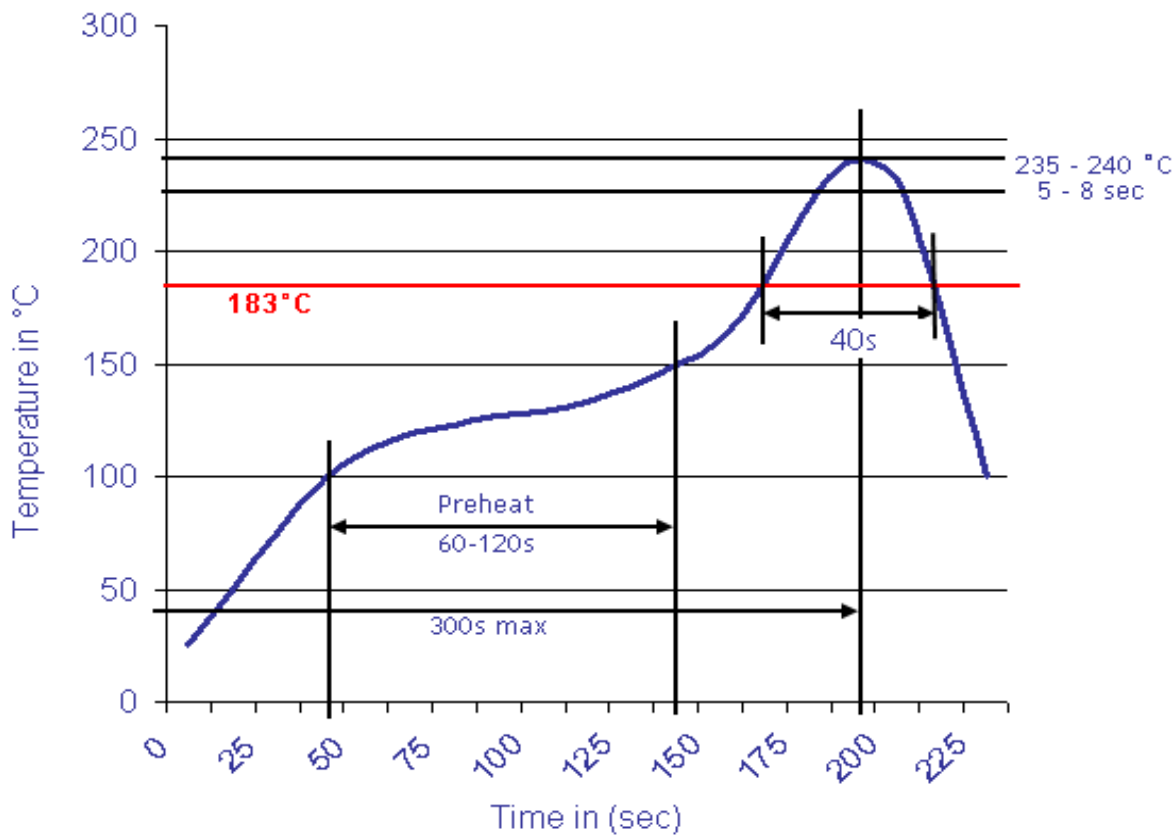

Battery Coin Cell Holder

Part No.: **B23070**

Customer:

DRW:	Jason	CHKD	Jules	MATL:	Wu	DATE	01.11.2018
APPD:	Join			FINISH	Shieh	Sheet	3 from 3