



Technical Specification

Electrical Characteristics

Standard Resistance Range: 10Ω to 2,0MΩ
 Standard Resistance Tolerance: 10% is Standard
 Terminal Resistance: ≤2Ω
 Contact Resistance Variation: 3% or 30hms max.
 Insulation Resistance: R1 ≥ 1000MΩ min.
 Dielectric Strength: 101,3KPa 600VAC 8,5KPa 250Vac
 Absolute Minimum Resistance: 1% or 2 Ohms max.
 Effekive Electrical Travel: 22 +/- 2 cycles
 Adjustability: Voltage +/- 0,05% Resistance +/-0,15%

Environmental Characteristics

Power Rating: (200Volts max.)
 0,75Watt/ 70°C / 0Watt / 125°C
 Temperature Range: -55°C ~ +125°C
 Temperature Coeffizient: +/-100ppm/°C
 Vibration: 98m/s² (1%Δ TR;1%Δ VR)
 Shock 390m/s² 4000 cycles (1%Δ TR;1%Δ VR)
 Climate Category: ΔR ≤+/- 3%R, R1≥10% R
 Electrical Endurance: 22+/-2cycles, ΔR≤+/-10%R
 Electrical Endurance at 70°C: 0,75W,1000h
 Collision: 10-500Hz, 0,75mm,or 98m/s²,6h

Physical Characteristics

Flammability: UL94V-0
 Torque: 30nM * m max.
 Terminals: Solderable Pins

Technical Dimensions Type 3006P

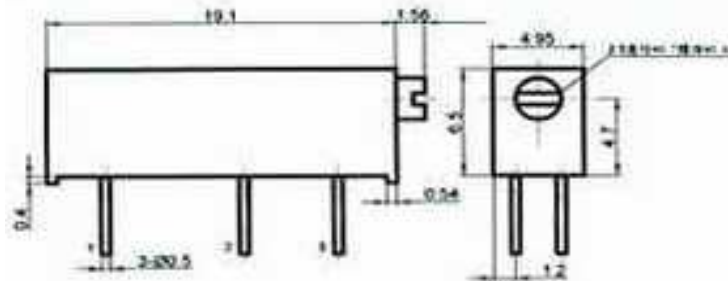

PCB Layout

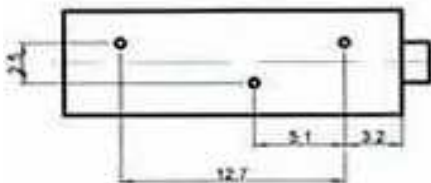

Physical Structure

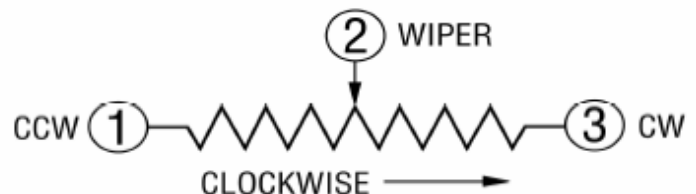

19mm THT Multi-Turn Trimmer Type 3006P

Serie No.: X19001

Customer:

DRW:	Jason	CHKD	Jules	MATL:	Wu	DATE	06.09.2009
APPD:	Join			FINISH	Shieh	Sheet	1 from 3

Copyright by EDCON-COMPONENTS H.Schmitt



Range Code Table

Ordering Code	Range
100	10Ω
200	20Ω
500	50Ω
101	100Ω
201	200Ω
501	500Ω
102	1,0KΩ
202	2,0KΩ
502	5,0KΩ
103	10KΩ
203	20KΩ
253	25KΩ
503	50KΩ
104	100KΩ
204	200KΩ
254	250KΩ
504	500KΩ
105	1,0MΩ
205	2,0MΩ

**19mm THT Multi-Turn
Trimmer Type 3006P**

Serie No.: **X19001**

Customer:

DRW:	Jason	CHKD	Jules	MATL:	Wu	DATE	06.09.2009
APPD:	Join			FINISH	Shieh	Sheet	2 from 3



Soldering Profile

Classification Reflow Profile (JEDEC J-STD-020C)

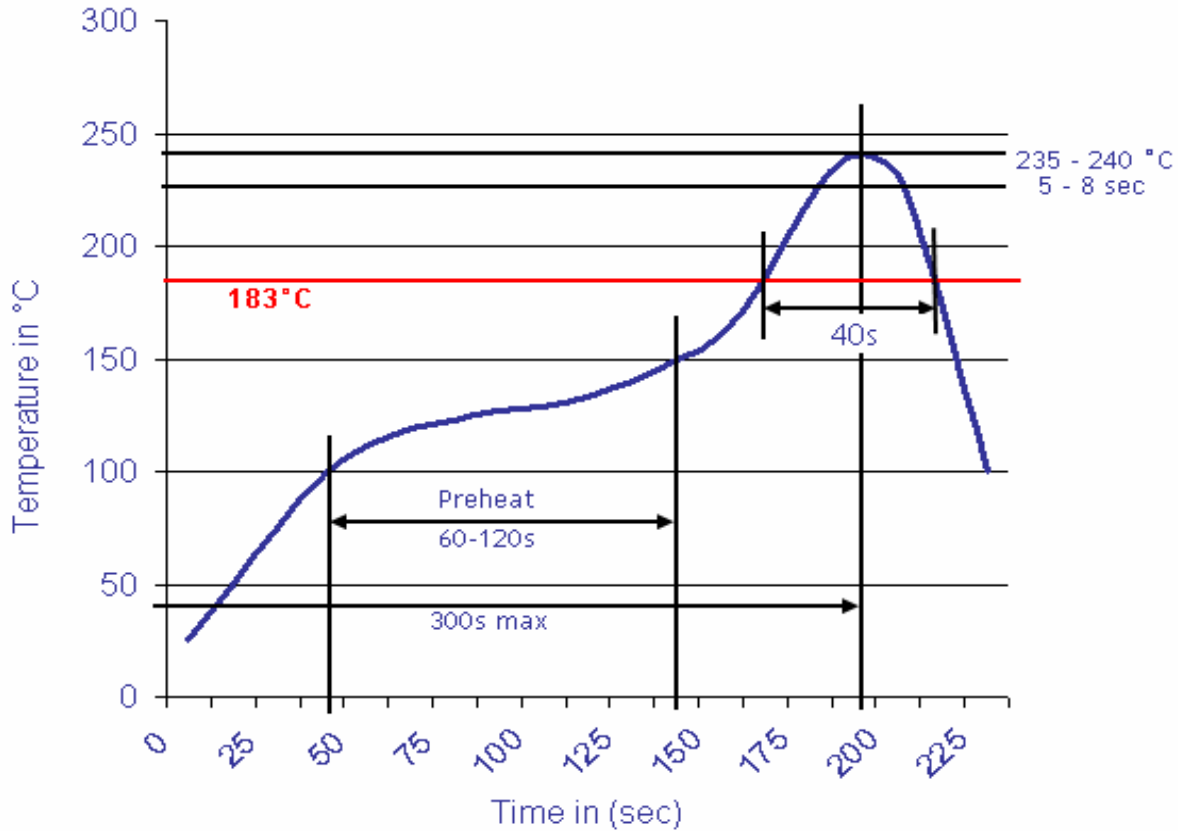

Ordering Information

Serie	Ordering Code	Tolerance	ROHS	Packing		
X19001	100	M	R	BU101		

100= 10Ω	M= Tol. 20%	R= ROHS conform	BU101= Bulk-Ware 100PCS
	K= Tol. 10%	N=NON ROHS conform	TU= Tube Packing

19mm THT Multi-Turn Trimmer Type 3006P	
Serie No.:	X19001
Customer:	

DRW:	Jason	CHKD	Jules	MATL:	Wu	DATE	06.09.2009
APPD:	Join			FINISH	Shieh	Sheet	3 from 3