

Technical Specification

Electrical Characteristics

Standard Resistance Range: 100Ω ~ 1,0MΩ
 Resistance Tolerance: +/-25% Standard
 Absolute Minimum Resistance: ≤2%
 Contact Resistance Variation : ≤5%
 Insulation Resistance: Infinite
 Adjustment Angle: 260° normal

Environmental Characteristics

Power Rating: (50VDC max.) 0,15W @ 70°C
 Temperature Range: -40°C to +125°C
 Temperature Coefficient: +/-250ppm/°C
 Soldering Heat: 260°C, 10seconds
 Humidity: 90% RH 500HRS
 Endurance: @ 70°C, 500H, ΔR ≤5%
 Rotational Life: 20cycles, ΔR ≤ +/-15%

Physical Characteristics

Mechanical Angle: Continuous
 Strating Torque: 30nM * m max.
 Marking: Resistance Code
 Standard Packing: 2000PCS per 7" Reel

Technical Dimensions Type 3303C

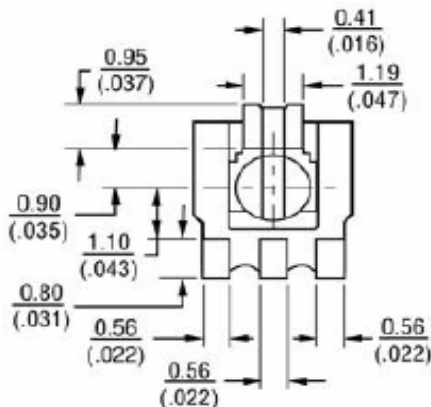
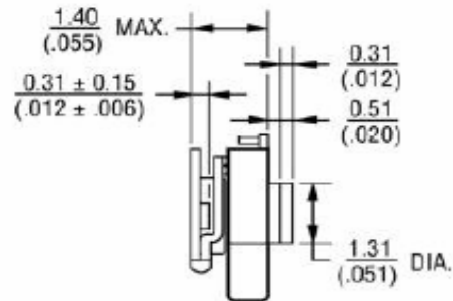
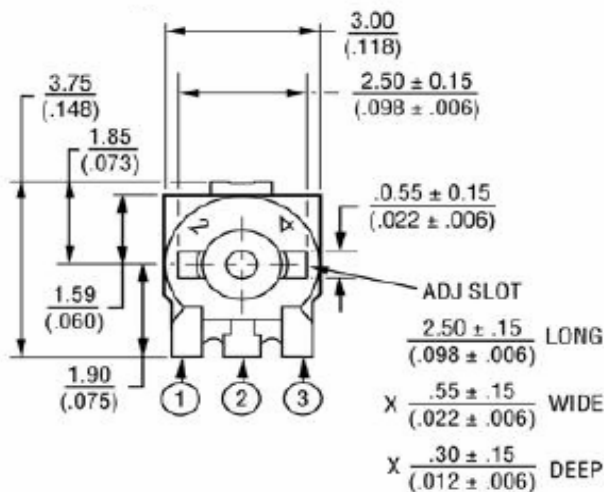

Physical Structure

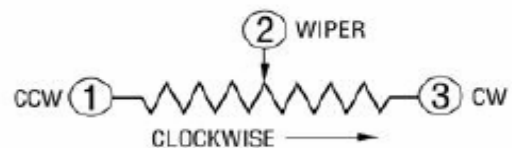

3mm SMT Single-Turn Trimmer Type 3303C

Serie No.: X13002

Customer:

DRW:	Jason	CHKD	Jules	MATL:	Wu	DATE	06.09.2009
APPD:	Join			FINISH	Shieh	Sheet	1 from 3

Copyright by EDCON-COMPONENTS H.Schmitt

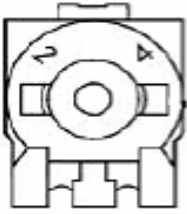

Range Code Table

PCB Layout

Ordering Code	Range
101	100Ω
201	200Ω
501	500Ω
102	1,0KΩ
202	2,0KΩ
502	5,0KΩ
103	10KΩ
203	20KΩ
503	50KΩ
104	100KΩ
204	200KΩ
504	500KΩ
105	1,0MΩ

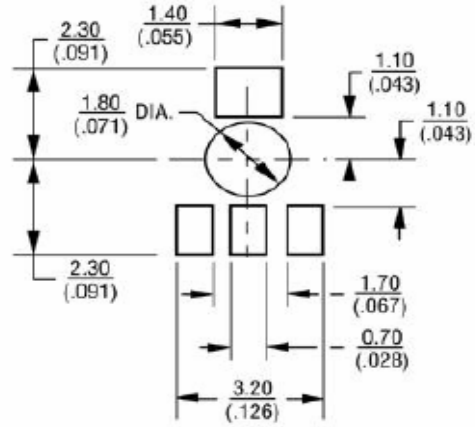

**3mm SMT Single-Turn
 Trimmer Type 3303C**

Serie No.: **X13002**

Customer:

DRW:	Jason	CHKD	Jules	MATL:	Wu	DATE	06.09.2009
APPD:	Join			FINISH	Shieh	Sheet	2 from 3

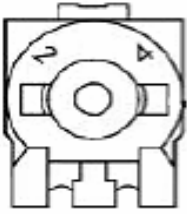

Soldering Profile

Classification Reflow Profile (JEDEC J-STD-020C)

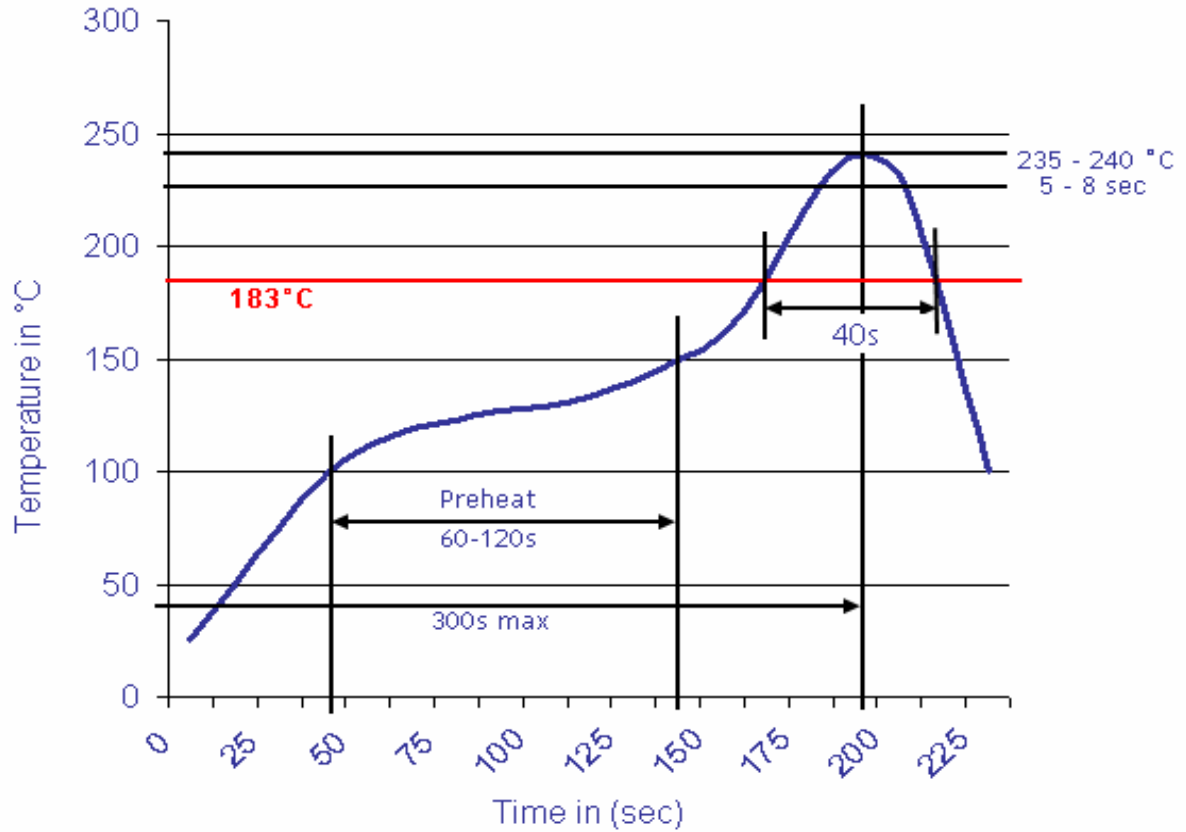

Ordering Information

Serie	Ordering Code	Tolerance	ROHS	Packing		
X13002	100	M	R	TR202		

100= 10Ω	M= Tol. 20%	R= ROHS conform	BU101= Bulk-Ware 100PCS TR202= Tape / Reel 2000PCS
	K= Tol. 10%	N=NON ROHS conform	

3mm SMT Single-Turn Trimmer Type 3303C	
Serie No.:	X13002
Customer:	

DRW:	Jason	CHKD	Jules	MATL:	Wu	DATE	06.09.2009
APPD:	Join			FINISH	Shieh	Sheet	3 from 3