

EDCON-COMPONENTS

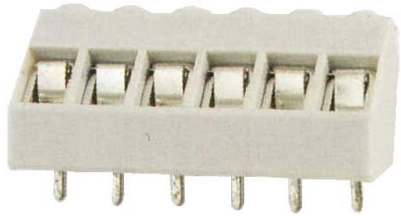

Drawing

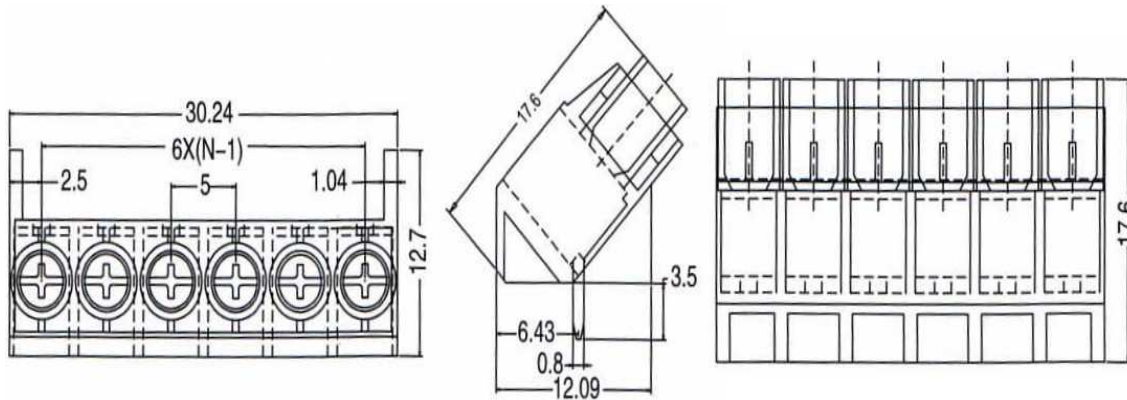

P.C.B. Layout

Specification

Electrical

Rated voltage	150V
Rated current	13.5A
Contact resistance	20mΩ
Insulation resistance	5000MΩ / 1000V
Wire range	26-16 AWG
Withstanding voltage	AC 1500V/1Min

Mechanical

Ambient temperature	-40°C ~ +105°C
Soldering temperature	250°C ±10°C/5sec
Strip length	5 ~ 6mm
Screw, Torque	M2.5, 0.4Nm (3.6Lb-In.)

Dimensions

Pitch	5.00mm
-------	--------

Material

Housing	PA66 (UL94V-0)
Pin header	Brass, Tin plated
Contact	Brass
Terminal screw	Steel Zinc plated



Wire Protector Terminal Block /
Pitch 5.00mm

Part No.: A12L074

Customer:

DRW:	Bill	CHKD	Lord	MATL:	Jimmy	TOLERANCE	Sam	DATE	14.03.2009
APPD:	Louis			FINISH	Georg		Sheet No.		1 from 3

www.edcon-components.com

email: info@edcon-components.com

EDCON-COMPONENTS

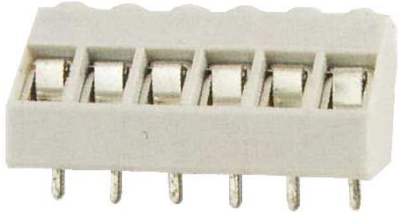

Ordering Informations

Serie	-	No. of Pole	Body-Color	wire protector	Screw	Customer Request
A12L074	-	XX	XX	X	X	X

XX = total	WH - white	1 - with wire protector	A - Slotted screw
	GN - green	2 - without wire protector	B - Cross-slotted screw (standard)
	GR - gray		
	LG - light gray		



PG - Phoenix Green
OR - orange
BL - blue
BK - black

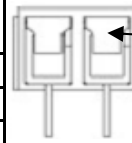

wire protector

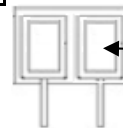

without wire protector



Wire Protector Terminal Block /
Pitch 5.00mm

Part No.: A12L074

Customer:

DRW:	Bill	CHKD	Lord	MATL:	Jimmy	TOLERANCE	Sam	DATE	14.03.2009
APPD:	Louis			FINISH	Georg		Sheet No.		2 from 3

www.edcon-components.com

email: info@edcon-components.com

EDCON-COMPONENTS

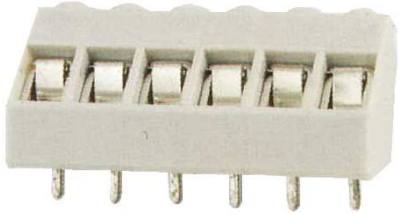

Soldering - Profil

Classification Reflow Profile (JEDEC J-STD-020C)

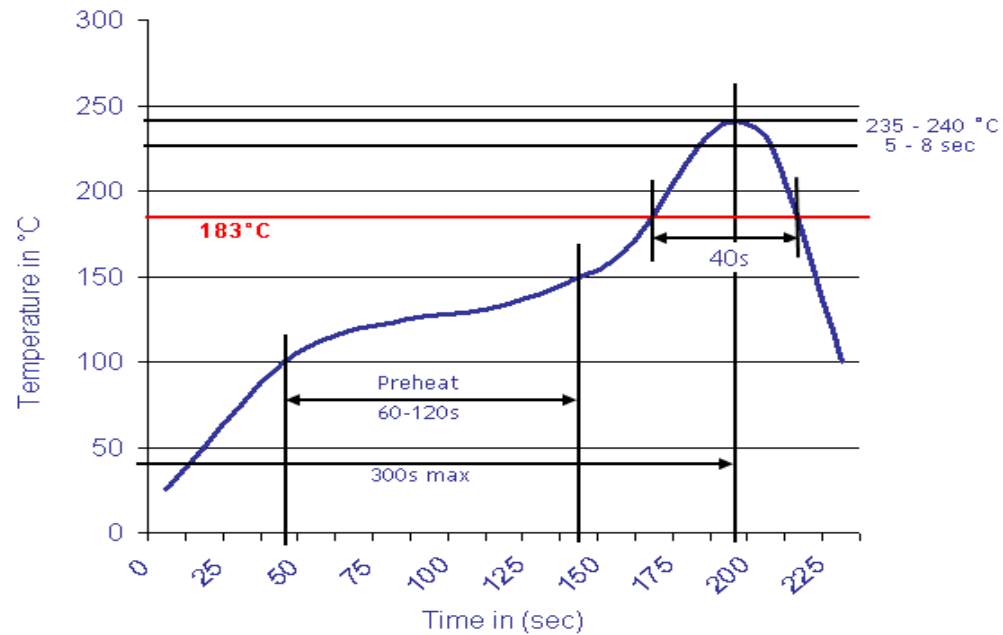

Wire Protector Terminal Block /
Pitch 5.00mm

Part No.: A12L074

Customer:

DRW:	Bill	CHKD	Lord	MATL:	Jimmy	TOLERANCE	Sam	DATE	14.03.2009
APPD:	Louis			FINISH	Georg		Sheet No.	3 from 3	

www.edcon-components.com

email: info@edcon-components.com