

EDCON-COMPONENTS

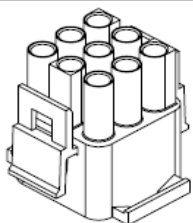

Specifications

Voltage Rating:	600VAC /DC
Current Rating	15AC / DC
Operating Temperature	. -25°C ~ +85°C
Contact Resistance	3,5m Ω Max.
Withstanding Voltage	5000V AC/minute
Insulation Resistance	1000M Ω Min.
 Material:	 Nylon 66, UL94V-0 or UL94V-2

Drawing (dimensions all into mm)

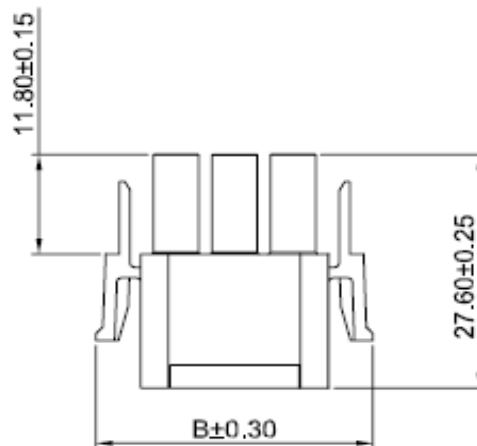
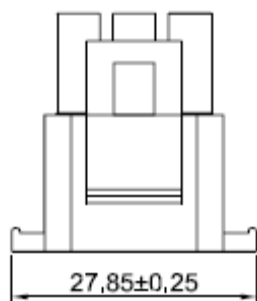
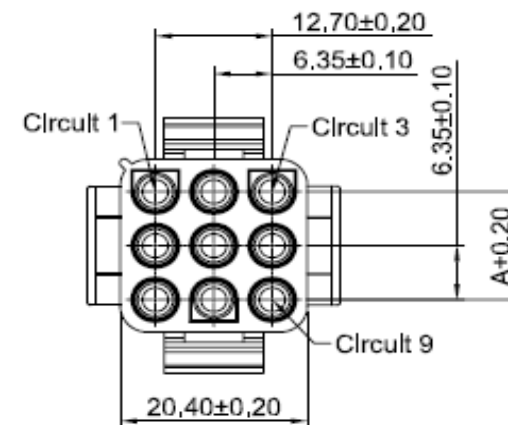
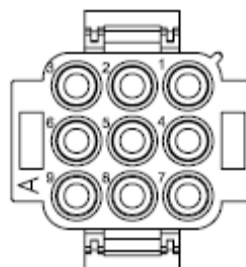

Wire to Wire Serie Pitch 6,35mm

Part No.: **T68M028**

Customer:

DRW:	Jason	CHKD	Wilson	MATL:	Wilson	TOLERANCE	Mason	DATE	02.04.2009
APPD:	Schumi			FINISH	Jamy		Sheet No.	1 from 3	

EDCON-COMPONENTS

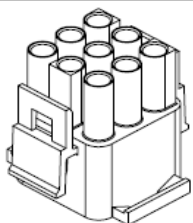

Dimension Informations about Wafer

Pos.	Dimension (mm)					
	A	B	C	D	E	F
02P	6,35	12,97				
03P	12,70	20,32				
04P	19,05	26,67				
05P	25,40	33,02				
06P	31,75	39,37				
07P	38,10	45,72				
08P	44,45	52,07				
09P	50,80	58,42				
10P	57,15	64,77				

Pos.	Dimension (mm)					
	A	B	C	D	E	F

Wire to Wire Serie Pitch 6,35mm	
Part No.:	T68M028
Customer:	

DRW:	Jason	CHKD	Wilson	MATL:	Wilson	TOLERANCE	Mason	DATE	02.04.2009
APPD:	Schumi			FINISH	Jamy			Sheet No.	2 from 3

EDCON-COMPONENTS

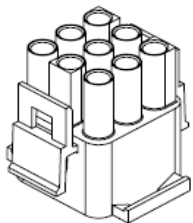

Ordering Informations

Serie	Number of	Body	ROHS	Packing						
T68M028	06	V0	R	BU						

06 = 3x2Pos.	V0= Material	R= ROHS Conform	BU= Bulk (Standard)
09 = 3x3Pos.	V2= Material	N= NON ROHS Conform	
12 = 3x4Pos.			
15 = 3x55Pos.			

Wire to Wire Serie Pitch 6,35mm
Part No.: T68M028
Customer:

DRW:	Jason	CHKD	Wilson	MATL:	Wilson	TOLERANCE	Mason	DATE	02.04.2009
APPD:	Schumi			FINISH	Jamy		Sheet No.		3 from 3

www.edcon-components.com

email: info@edcon-components.com