

EDCON-COMPONENTS

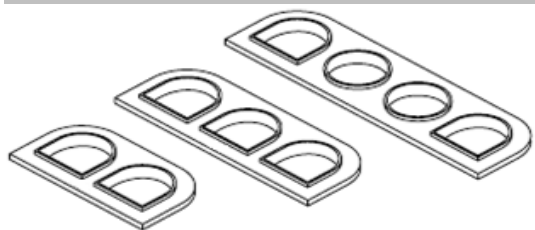

Technical Requirement

2,79mm-3,30mm Insulation diameter passed European IP Sealing level #5/7 (swirling dust / Immerslon to 1Meter for 30Minutes).

1,52mm-2,79mm Insulation diameter passed European IP sealing level #5/6 (Swirling dust / heavy seas)

Wire AWG range is #20-14 with Insulation diameter range from 1,52mm-3,3mm.

Drawing (dimensions all into mm)

02 Pos.

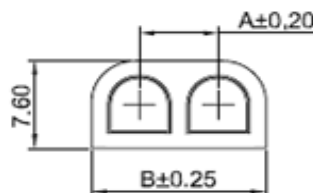

03 Pos.

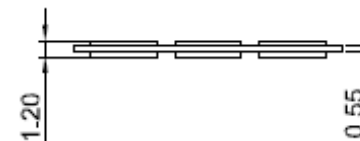
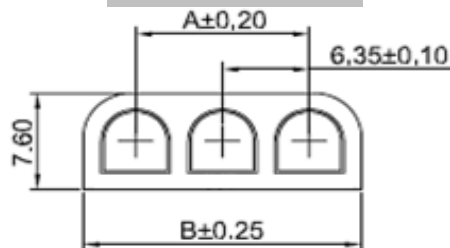

04 Pos.

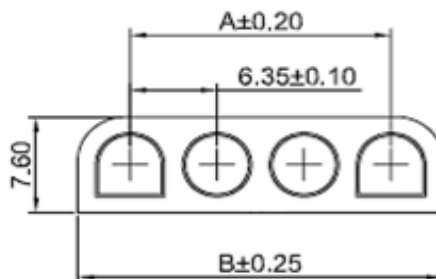

Wire to Wire Serie Pitch 6,35mm

Part No.: T68M026

Customer:

DRW:	Jason	CHKD	Wilson	MATL:	Wilson	TOLERANCE	Mason	DATE	02.04.2009
APPD:	Schumi			FINISH	Jamy		Sheet No.	1 from 3	

EDCON-COMPONENTS

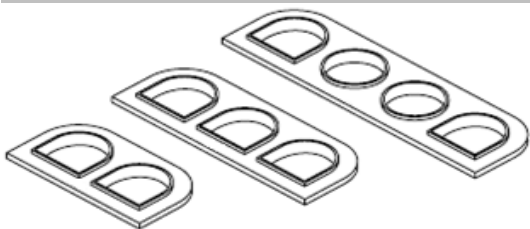

Ordering Informations

Serie	Number of	Color	ROHS	Packing						
T68M026	02	BL	R	BU						

02 = 2Pos.	BL= Blue	R= ROHS Conform	BU= Bulk (Standard)
03 = 3Pos.		N= NON ROHS Conform	
04 = 4Pos.			

Wire to Wire Serie Pitch 6,35mm
Part No.: T68M026
Customer:

DRW:	Jason	CHKD	Wilson	MATL:	Wilson	TOLERANCE	Mason	DATE	02.04.2009
APPD:	Schumi			FINISH	Jamy		Sheet No.	3 from 3	

www.edcon-components.com

email: info@edcon-components.com