

EDCON-COMPONENTS

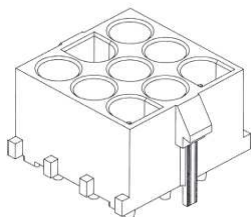

Specifications

Voltage Rating: 600VAC /DC
 Current Rating: 15AC / DC
 Operating Temperature: -25°C ~ +85°C
 Contact Resistance: 3,5m Ω Max.
 Withstanding Voltage: 5000V AC/minute
 Insulation Resistance: 1000M Ω Min.

Material: Nylon 66, UL94V-0 or UL94V-2
 Material Pin: Brass / Tin-Plated

Drawing (dimensions all into mm)

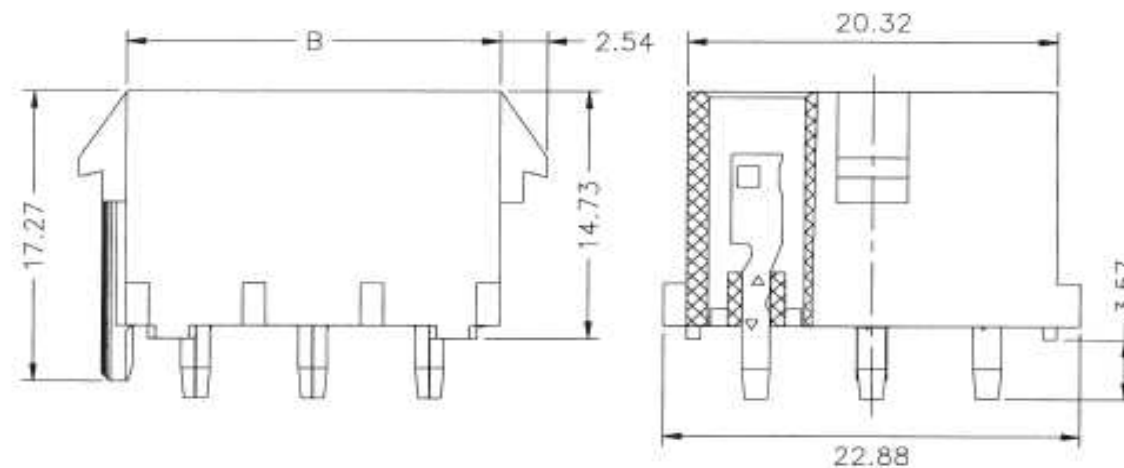

PCB Layout

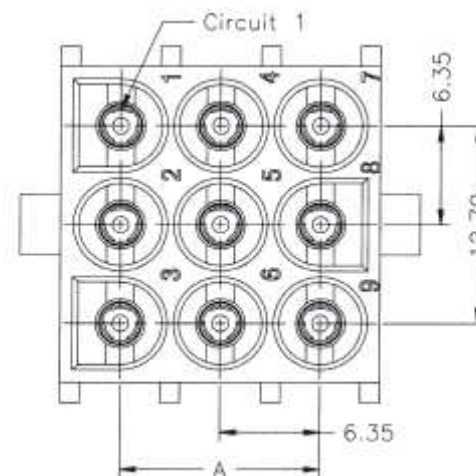
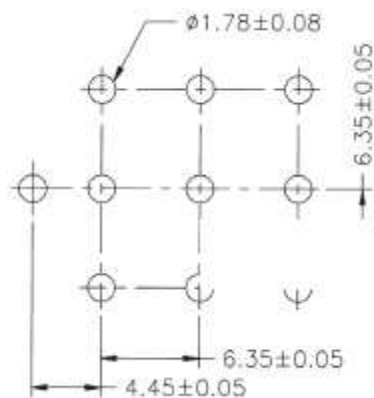

**Female Wire to Board Serie
 Pitch 6,35mm with Polarisation**

Part No.: **T68M008**

Customer:

DRW:	Jason	CHKD	Wilson	MATL:	Wilson	TOLERANCE	Mason	DATE	02.04.2009
APPD:	Schumi			FINISH	Jamy		Sheet No.	1 from 4	

EDCON-COMPONENTS

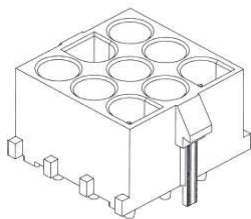

Dimension Informations about Wafer

Pos.	Dimension (mm)					
	A	B	C	D	E	F
3x2P	6,35	13,97				
3x3P	12,70	20,32				
3x4P	19,05	26,67				
3x5P	25,40	33,02				

Pos.	Dimension (mm)					
	A	B	C	D	E	F

Female Wire to Board Serie	
Pitch 6,35mm with Polarisation	
Part No.:	T68M008
Customer:	

DRW:	Jason	CHKD	Wilson	MATL:	Wilson	TOLERANCE	Mason	DATE	02.04.2009
APPD:	Schumi			FINISH	Jamy		Sheet No.		2 from 4

EDCON-COMPONENTS

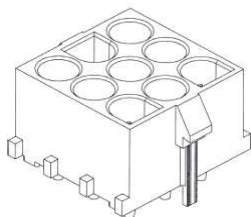

Ordering Informations

Serie	Number of	Body	Contact	ROHS	Packing					
T68M008	06	V0	T	R	BU					

06 = 3x2Pos.	V0= Material	T= Tin Plated (Standard)	R= ROHS Conform	BU= Bulk (Standard)
09 = 3x3Pos.	V2= Material		N= NON ROHS Conform	
12 = 3x4Pos.		G= Gold Flash Plated (MOQ on request)		
15 = 3x5Pos.				

**Female Wire to Board Serie
Pitch 6,35mm with Polarisation**

Part No.: **T68M008**

DRW:	Jason	CHKD	Wilson	MATL:	Wilson	TOLERANCE	Mason	DATE	02.04.2009
APPD:	Schumi			FINISH	Jamy		Sheet No.		3 from 4

Customer:

www.edcon-components.com

email: info@edcon-components.com

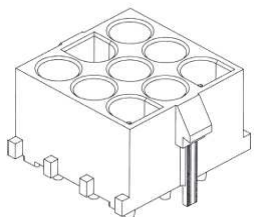

Soldering Profile

Lead Free Curve

Classification Reflow Profile (JEDEC J-STD-020C)

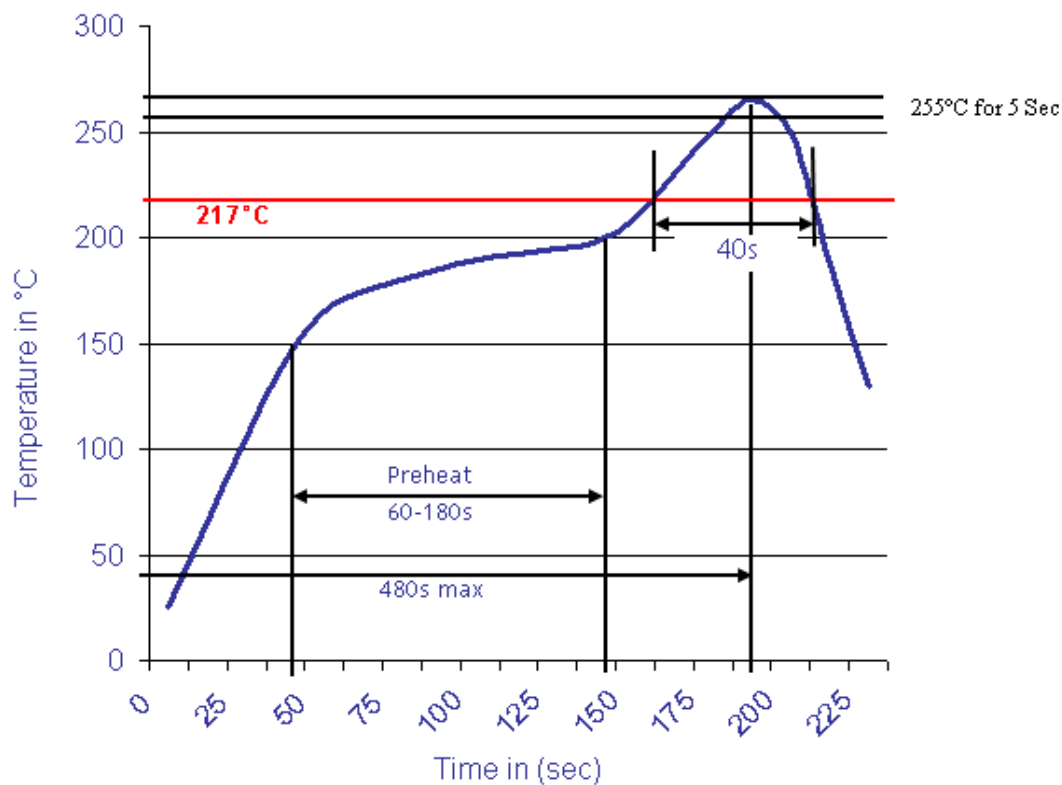

Female Wire to Board Serie
Pitch 6,35mm with Polarisation

Part No.: **T68M008**

DRW:	Jason	CHKD	Wilson	MATL:	Wilson	TOLERANCE	Mason	DATE	02.04.2009
APPD:	Schumi			FINISH	Jamy		Sheet No.	4 from 4	

Customer: