

EDCON-COMPONENTS

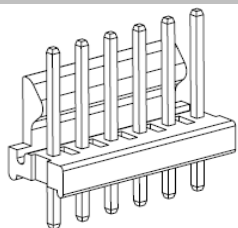

Specifications

Voltage Rating:	250VAC /DC
Current Rating	2,5AC / DC
Operating Temperature	. -40°C ~ +130°C
Contact Resistance	20m Ω Max.
Withstanding Voltage	1000V AC/minute
Insulation Resistance	1000M Ω Min.
Material Insulator:	Nylon 66 UL94V-0 White
Material Pin	Brass
Pin Plating:	Brass; Tin Plated

Drawing (dimensions all into mm)

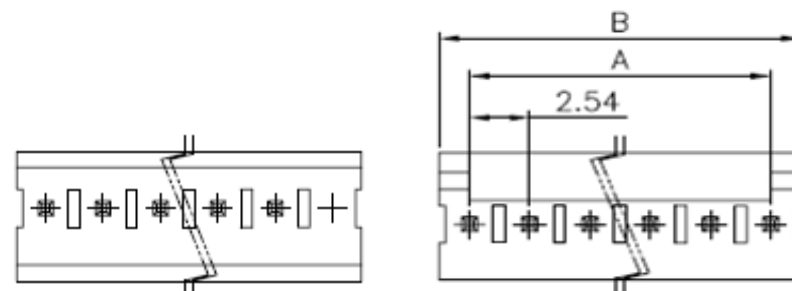
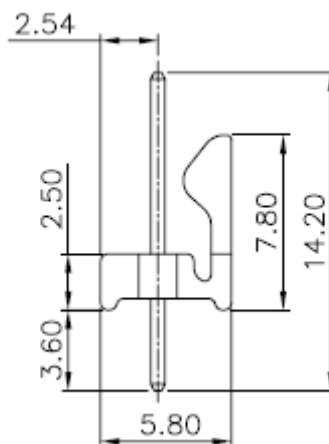

PCB Layout

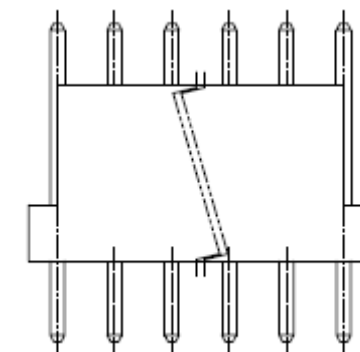
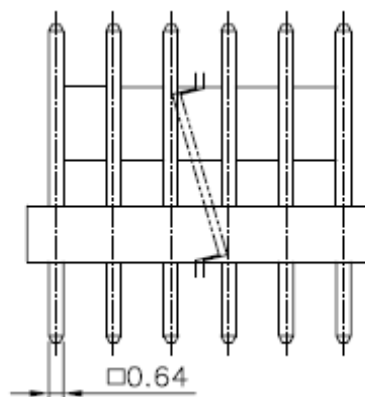
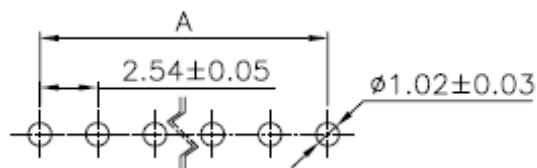

**Wire to Board Pitch 2,54mm
Alternative to Serie MASCONN**

Part No.: **T68N012**

DRW:	Jason	CHKD	Wilson	MATL:	Wilson	TOLERANCE	Mason	DATE	02.04.2009
APPD:	Schumi			FINISH	Jamy		Sheet No.		1 from 4

Customer:

EDCON-COMPONENTS

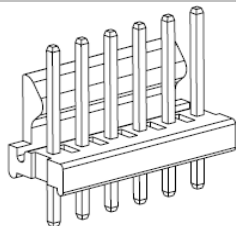

Ordering Informations

Serie	Positions	Body Color	C- Plating	ROHS	Packing				
T68N012	02	BK	TN	R	BU				

Look Table	BK= Black	TN= Tin Plated	R= ROHS Conform	BU= Bulk (Standard)
	WH= White	GF= Gold Flash	N= NON ROHS Conform	
		GA= 3µGold		
		GB= 5µGold		
		GC= 10µGold		
		GD= 15µGold		
		GE= 30µGold		
		SA= Sel. 3µGold		
		SB= Sel. 5µGold		
		SC= Sel. 10µGold		
	SD= Sel. 15µGold	SE= Sel. 30µGold		

**Wire to Board Pitch 2,54mm
Alternative to Serie MASCONN**

Part No.: **T68N012**

DRW:	Jason	CHKD	Wilson	MATL:	Wilson	TOLERANCE	Mason	DATE	02.04.2009	Customer:
APPD:	Schumi			FINISH	Jamy		Sheet No.	3 from 4		

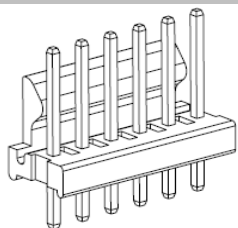

Soldering Profile

Lead Free Curve

Classification Reflow Profile (JEDEC J-STD-020C)

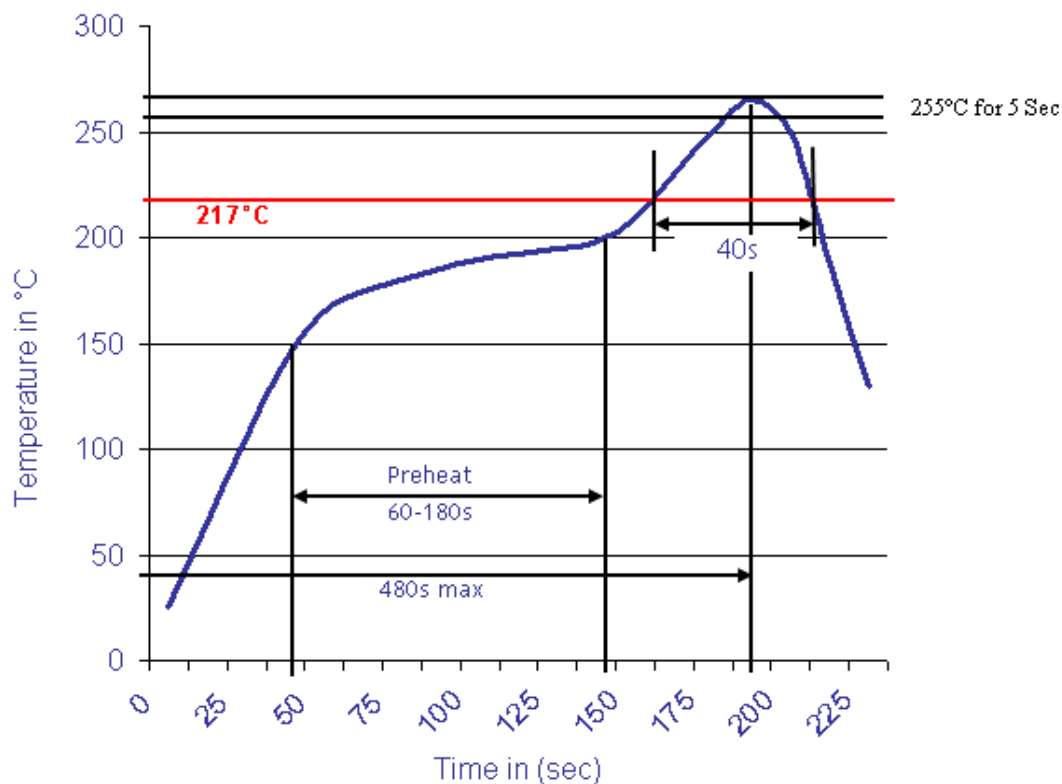

Wire to Board Pitch 2,54mm
Alternative to Serie MASCONN

Part No.: **T68N012**

DRW:	Jason	CHKD	Wilson	MATL:	Wilson	TOLERANCE	Mason	DATE	02.04.2009
APPD:	Schumi			FINISH	Jamy		Sheet No.	4 from 4	

Customer: