

EDCON-COMPONENTS

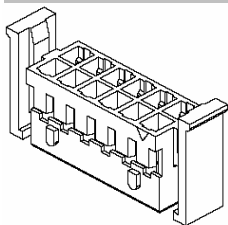

Specifications

Voltage Rating:	250 V AC/DC
Current Rating:	3A AC/DC
Operating Temperature:	-25°C to + 85°C
Contact Resistance:	10 mΩ
Withstanding Voltage:	800 V AC/Minute
Insulation Resistance:	1000MΩ min.
Material Housing:	Nylon 66 / UL94V-0
Color:	Natural / (White)

Drawing (dimensions all into mm)

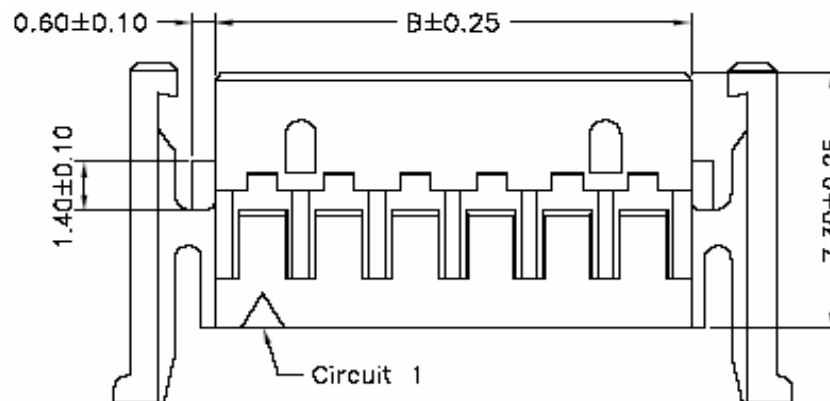
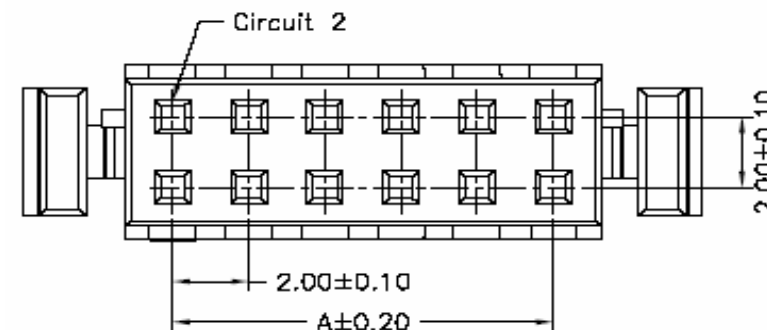
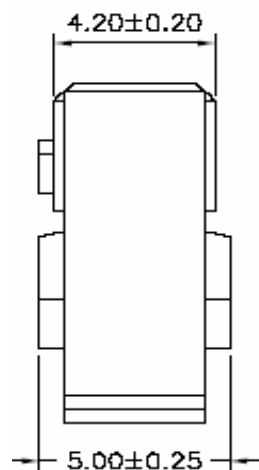

Housing Serie T68Txxxx Pitch 2,00mm	
Part No.:	T68T305
Customer:	

DRW:	Jason	CHKD	Wilson	MATL:	Wilson	TOLERANCE	Mason	DATE	02.04.2009
APPD:	Schumi			FINISH	Jamy		Sheet No.	1 from 3	

www.edcon-components.com

email: info@edcon-components.com

EDCON-COMPONENTS

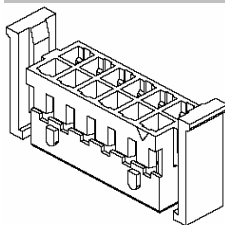

Dimension Information about Housing

Pos.	Dimension (mm)					
	A	B	C	D	E	F
04 (2x02)	2,00	4,50				
06 (2x03)	4,00	6,50				
08 (2x04)	6,00	8,50				
10 (2x05)	8,00	10,50				
12 (2x06)	10,00	12,50				
14 (2x07)	12,00	14,50				
16 (2x08)	14,00	16,50				
18 (2x09)	16,00	18,50				
20 (2x10)	18,00	20,50				
22 (2x11)	20,00	22,50				
24 (2x12)	22,00	24,50				
26 (2x13)	24,00	26,50				
28 (2x14)	26,00	28,50				
30 (2x15)	28,00	30,50				
32 (2x16)	30,00	32,50				
34 (2x17)	32,00	34,50				
36 (2x18)	34,00	36,50				
38 (2x19)	36,00	38,50				
40 (2x20)	38,00	40,50				

Pos.	Dimension (mm)					
	A	B	C	D	E	F

Housing Serie T68Txxxx Pitch 2,00mm
Part No.: T68T305
Customer:

DRW: Jason	CHKD: Wilson	MATL: Wilson	TOLERANCE: Mason	DATE: 02.04.2009
APPD: Schumi	FINISH: Jamy	Sheet No.:	2 from 3	

EDCON-COMPONENTS

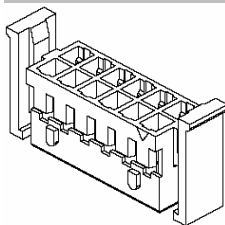

Ordering Informations

Serie	Number of Pos.	Color of Body	Packing							
-------	----------------	---------------	---------	--	--	--	--	--	--	--

T68T305	04	WH	BU							
----------------	-----------	-----------	-----------	--	--	--	--	--	--	--

xx = Pos.	WH= White	BU= Bulk Packing								

Housing Serie T68Txxxx Pitch 2,00mm
Part No.: T68T305
Customer:

DRW:	Jason	CHKD	Wilson	MATL:	Wilson	TOLERANCE	Mason	DATE	02.04.2009
APPD:	Schumi			FINISH	Jamy		Sheet No.		3 from 3

www.edcon-components.com

email: info@edcon-components.com