

EDCON-COMPONENTS

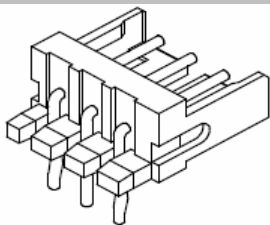

Specifications

Voltage Rating:	125 V AC/DC
Current Rating:	4A AC/DC
Operating Temperature:	-25°C to +85°C
Contact Resistance:	10 mΩ
Withstanding Voltage:	1000 V AC/Minute
Insulation Resistance:	1000MΩ min.
Material Housing:	Nylon 66 / UL94V-0
Color of Base:	Natural (White)
Pin-Material:	Brass / Tin plated 100~150μ

Drawing (dimensions all into mm)

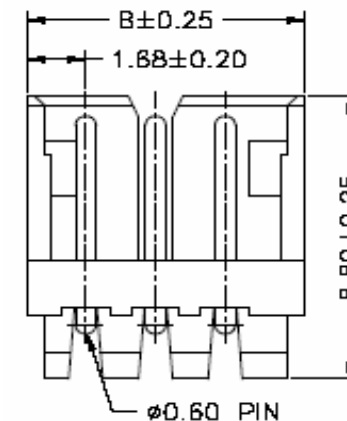
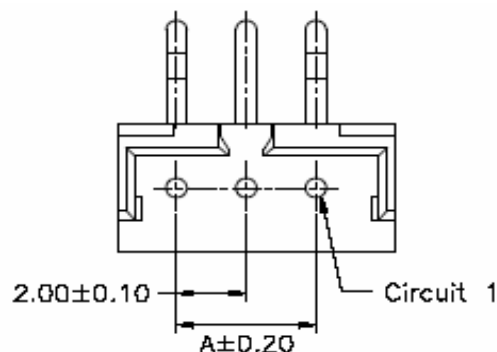

P.C.B. Layout

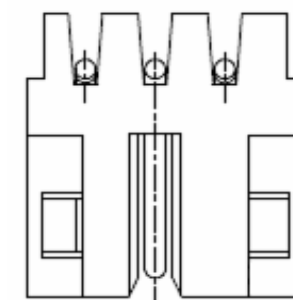
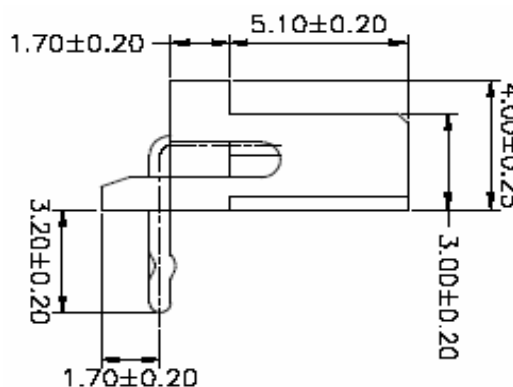
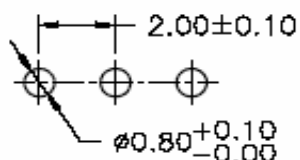

Wafer Serie T68Txxxx Pitch
2,00mm

Part No.: **T68T050**

Customer:

DRW:	Jason	CHKD	Wilson	MATL:	Wilson	TOLERANCE	Mason	DATE	02.04.2009
APPD:	Schumi			FINISH	Jamy		Sheet No.	1 from 4	

EDCON-COMPONENTS

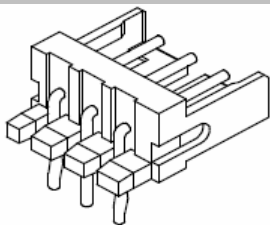

Ordering Informations

Serie	Number of Pos.	Leg Function	Material of Body	Color of Body	Packing					
-------	----------------	--------------	------------------	---------------	---------	--	--	--	--	--

T68T050	02	N	66	WH	BU					
----------------	-----------	----------	-----------	-----------	-----------	--	--	--	--	--

xx = Pos.	N= without King	66= Nylon 66	WH= White	BU= Bulk Ware						
	K= with King	46= Nylon 46								

Wafer Serie T68Txxxx Pitch
2,00mm

Part No.: **T68T050**

DRW:	Jason	CHKD	Wilson	MATL:	Wilson	TOLERANCE	Mason	DATE	02.04.2009
APPD:	Schumi			FINISH	Jamy		Sheet No.		3 from 4

Customer:

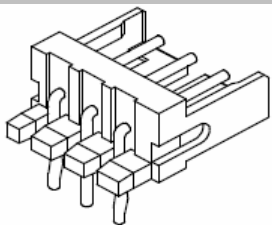

Soldering Profile Curve

Classification Reflow Profile (JEDEC J-STD-020C)

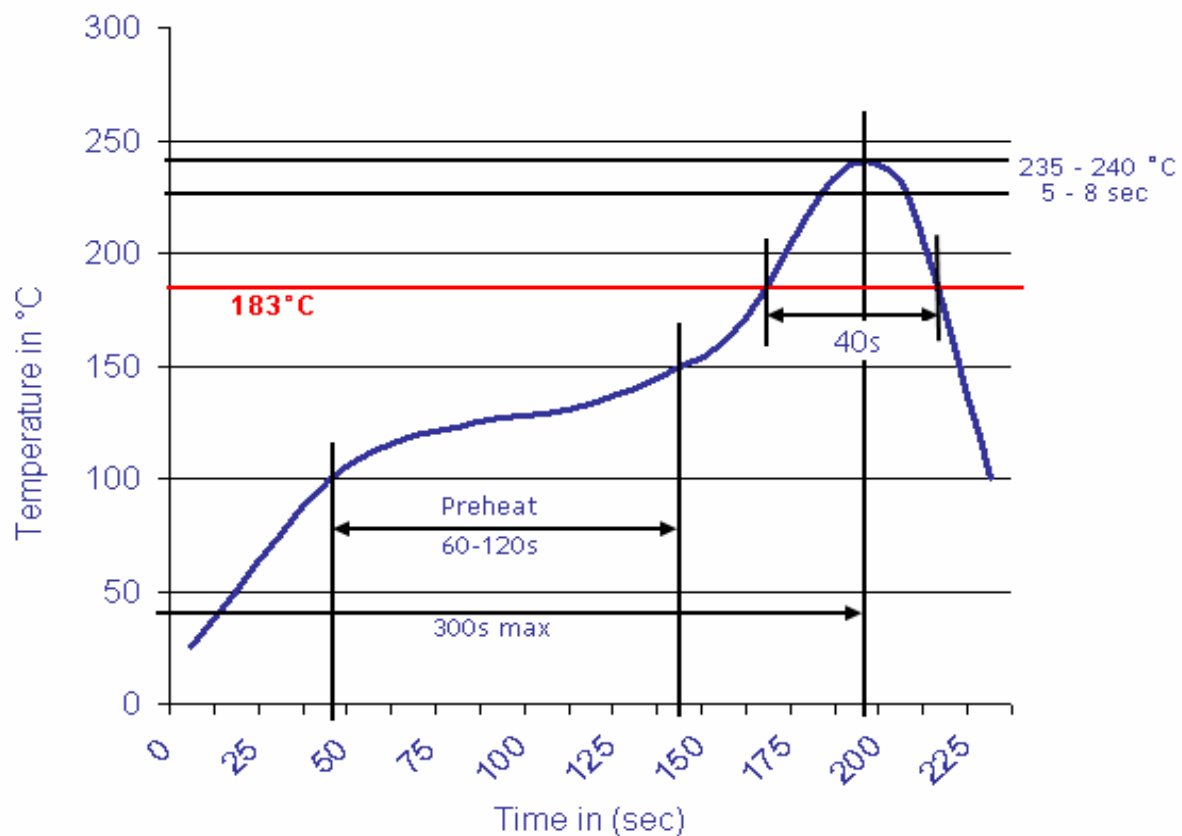

Wafer Serie T68Txxxx Pitch
2,00mm

Part No.: **T68T050**

DRW:	Jason	CHKD	Wilson	MATL:	Wilson	TOLERANCE	Mason	DATE	02.04.2009
APPD:	Schumi			FINISH	Jamy		Sheet No.	4 from 4	Customer: