

EDCON-COMPONENTS

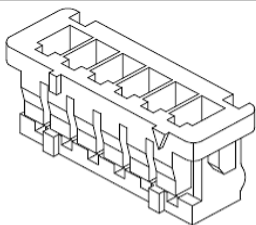

Specifications

Voltage Rating:	150 V AC/DC
Current Rating:	1A AC/DC
Operating Temperature:	-25°C to +85°C
Contact Resistance:	30 mΩ
Withstanding Voltage:	500 V AC/Minute
Insulation Resistance:	500MΩ min.
Material Housing:	Nylon 66 / UL94V-0
Color Tone:	7529C ~ 7530C

Drawing (dimensions all into mm)

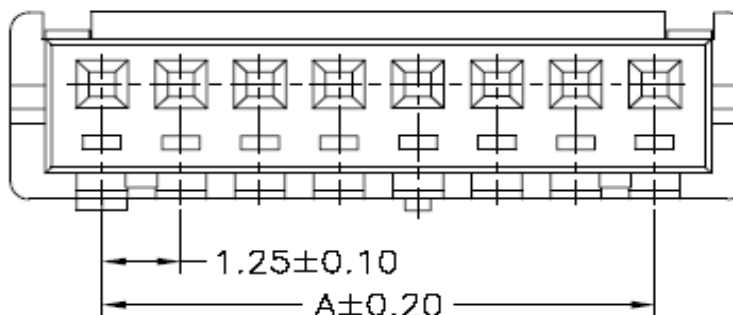
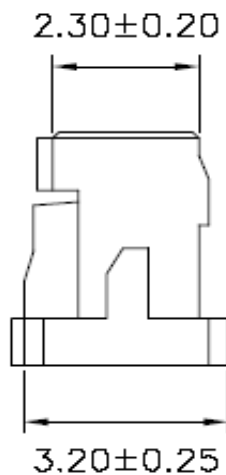
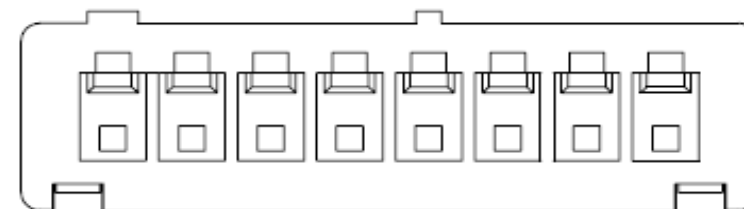
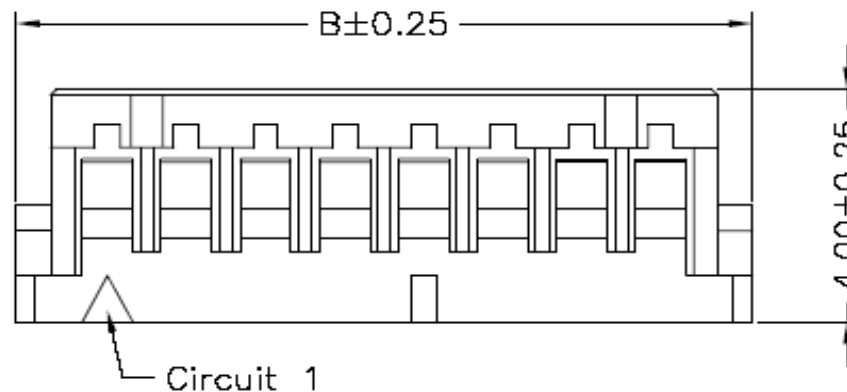

Housing Serie T68Sxxxx Pitch
1,25mm

Part No.: **T68S040**

Customer:

DRW:	Jason	CHKD	Wilson	MATL:	Wilson	TOLERANCE	Mason	DATE	02.04.2009
APPD:	Schumi			FINISH	Jamy		Sheet No.		1 from 3

EDCON-COMPONENTS

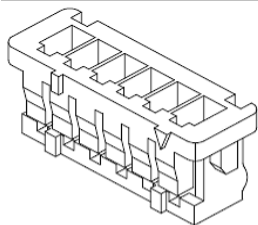

Ordering Informations

Serie	Number of Pos.	Color of Body	Packing							
-------	----------------	---------------	---------	--	--	--	--	--	--	--

T68S040	02	NA	BU							
----------------	-----------	-----------	-----------	--	--	--	--	--	--	--

xx = Pos.	NA= Natural	BU= Bulk Packing								
	BG= Beige									

Housing Serie T68Sxxxx Pitch 1,25mm

Part No.: **T68S040**

DRW:	Jason	CHKD	Wilson	MATL:	Wilson	TOLERANCE	Mason	DATE	02.04.2009
APPD:	Schumi			FINISH	Jamy		Sheet No.		3 from 3

Customer: