

EDCON-COMPONENTS

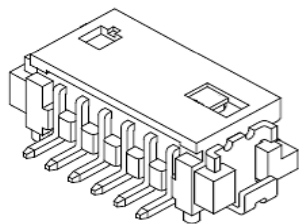

Specifications

Voltage Rating:	150 V AC/DC
Current Rating:	1A AC/DC
Operating Temperature:	-25°C to + 85°C
Contact Resistance:	30 mΩ
Withstanding Voltage:	500 V AC/Minute
Insulation Resistance:	500MΩ min.
Material Housing:	Nylon 6T / UL94V-0
Color:	Natural (Beige)
Pin-Material:	Brass /Tin-plated
Solder Tabs:	Brass /Tin-plated
Pic and Place Cap	6T UL94V-0

Drawing (dimensions all into mm)

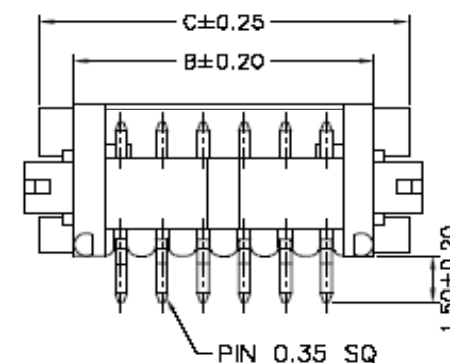
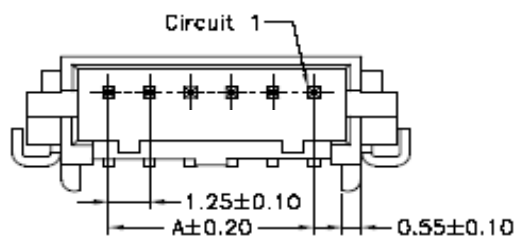

P.C.B. Layout

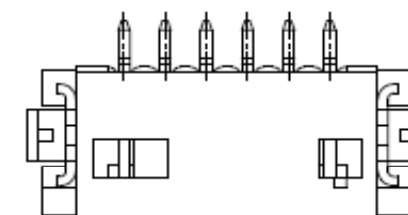
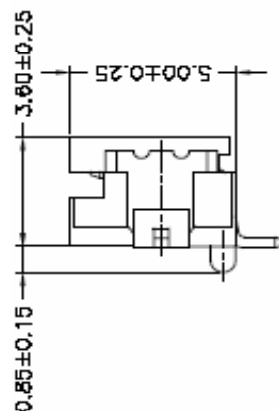
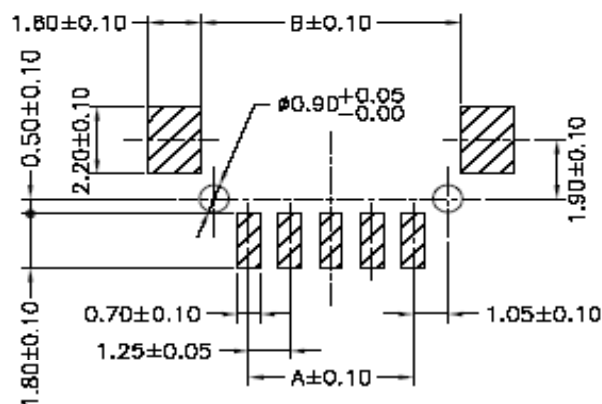

Wafer Serie T68Sxxxx Pitch
1,25mm

Part No.: **T68S039 -**

Customer:

DRW:	Jason	CHKD	Wilson	MATL:	Wilson	TOLERANCE	Mason	DATE	17.07.2021
APPD:	Schumi			FINISH	Jamy		Sheet No.	1 from 4	

EDCON-COMPONENTS

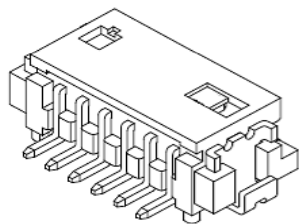

Ordering Informations

Serie	Number of Pos.	Color of Body	ROHS	Packing						
-------	----------------	---------------	------	---------	--	--	--	--	--	--

T68S039 -	02	NA	R	TU						
------------------	-----------	-----------	----------	-----------	--	--	--	--	--	--

xx = Pos.	NA= Natural	R= ROHS Conform	TU= Tube Packing							
	BG= Beige	N= NON ROHS Conform	TR= Tape / Reel Packing							

Wafer Serie T68Sxxxx Pitch 1,25mm
Part No.: T68S039 -
Customer:

DRW:	Jason	CHKD	Wilson	MATL:	Wilson	TOLERANCE	Mason	DATE	17.07.2021
APPD:	Schumi			FINISH	Jamy		Sheet No.		3 from 4

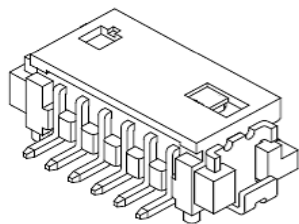

Soldering Profile Curve

Classification Reflow Profile (JEDEC J-STD-020C)

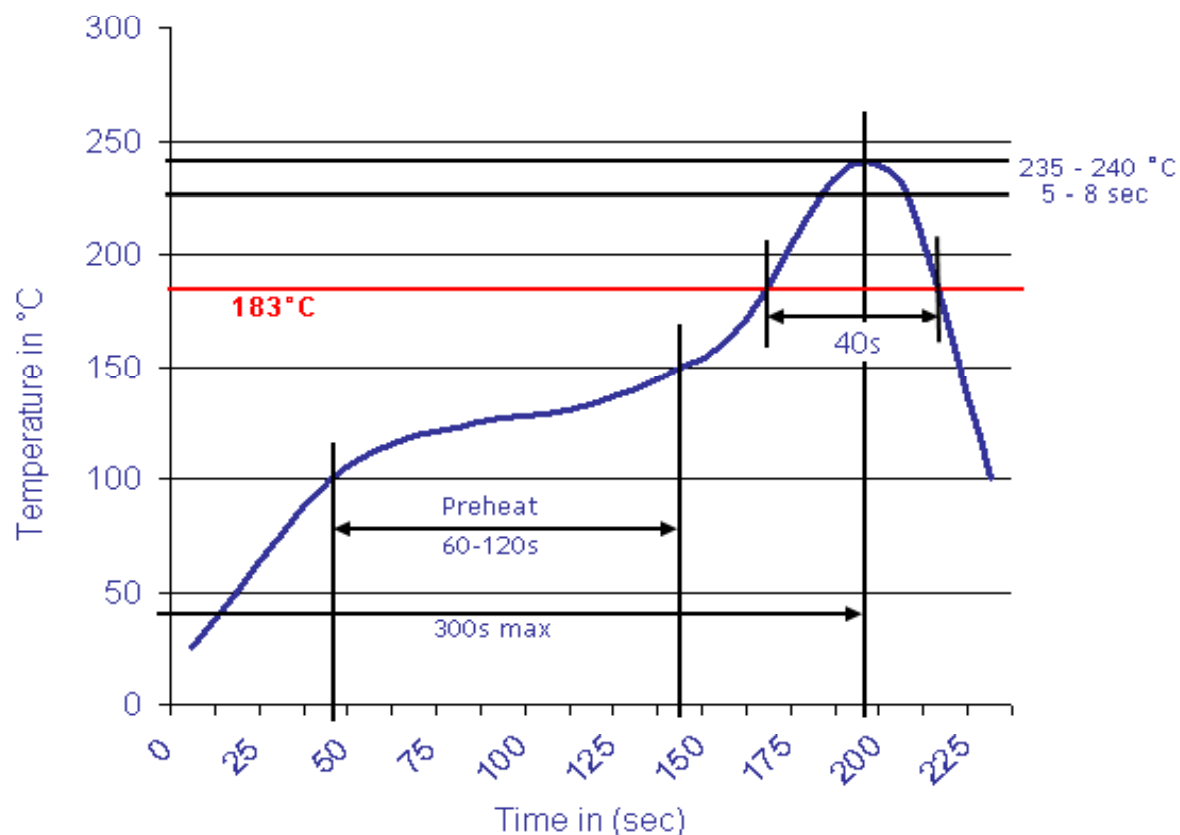

Wafer Serie T68Sxxxx Pitch
1,25mm

Part No.: **T68S039 -**

DRW:	Jason	CHKD	Wilson	MATL:	Wilson	TOLERANCE	Mason	DATE	17.07.2021	Customer:
APPD:	Schumi			FINISH	Jamy		Sheet No.	4 from 4		