

EDCON-COMPONENTS

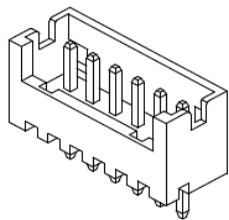

Specifications

Voltage Rating:	150 V AC/DC
Current Rating:	1A AC/DC
Operating Temperature:	-25°C to +85°C
Contact Resistance:	30 mΩ
Withstanding Voltage:	500 V AC/Minute
Insulation Resistance:	500MΩ min.
Material Housing:	Nylon 6T / UL94V-0
Color:	Natural (Beige)
Pin-Material:	Brass /Tin-plated
Solder Tabs:	Brass /Tin-plated

Drawing (dimensions all into mm)

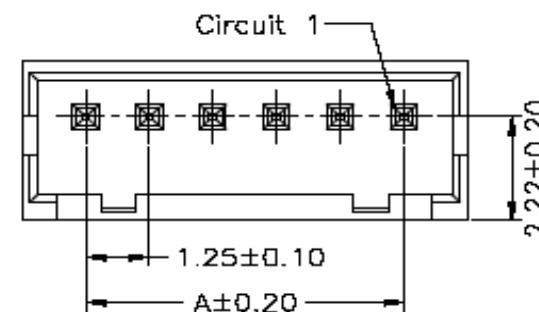
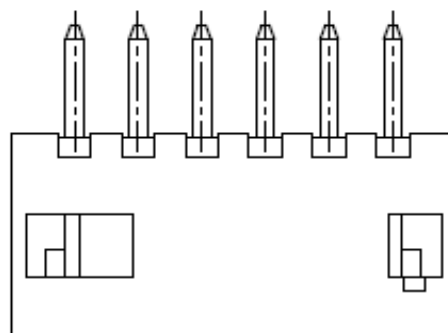

P.C.B. Layout

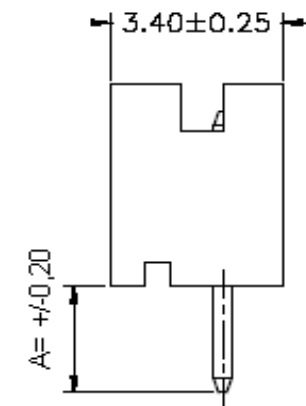
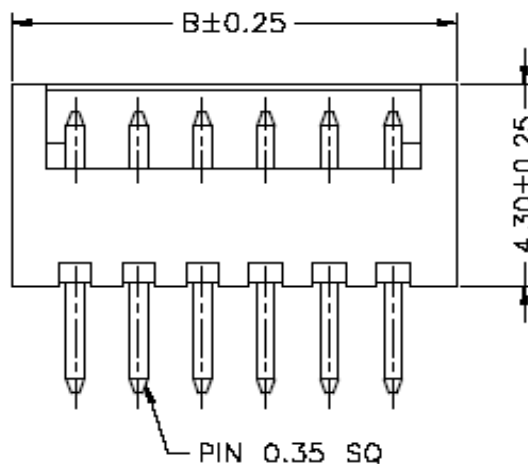
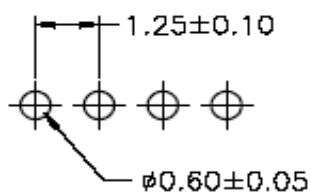

Wafer Serie T68Sxxxx Pitch
1,25mm

Part No.: **T68S024**

Customer:

DRW:	Jason	CHKD	Wilson	MATL:	Wilson	TOLERANCE	Mason	DATE	02.04.2009
APPD:	Schumi			FINISH	Jamy		Sheet No.		1 from 4

EDCON-COMPONENTS

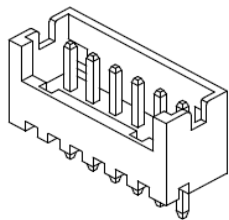

Ordering Informations

Serie	Number of Pos.	Color of Body	Pin Length	ROHS	Packing					
-------	----------------	---------------	------------	------	---------	--	--	--	--	--

T68S024	02	NA	A01	R	BU					
----------------	-----------	-----------	------------	----------	-----------	--	--	--	--	--

xx = Pos.	NA= Natural	A01= Standard	R= ROHS Conform	BU= Bulk Ware					
	BG= Beige	Axx= Look Pin length configuration	N= NON ROHS Conform	TR= Tape / Reel Packing					
				RC= Tape / Reel Packing with Cap					
				TU= Tube Packing					
				TC= Tube Packing with Cap					

Wafer Serie T68Sxxxx Pitch 1,25mm
Part No.: T68S024
Customer:

DRW:	Jason	CHKD	Wilson	MATL:	Wilson	TOLERANCE	Mason	DATE	02.04.2009
APPD:	Schumi			FINISH	Jamy		Sheet No.		3 from 4

www.edcon-components.com

email: info@edcon-components.com

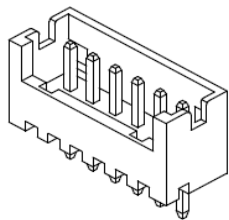

Soldering Profile Curve

Classification Reflow Profile (JEDEC J-STD-020C)

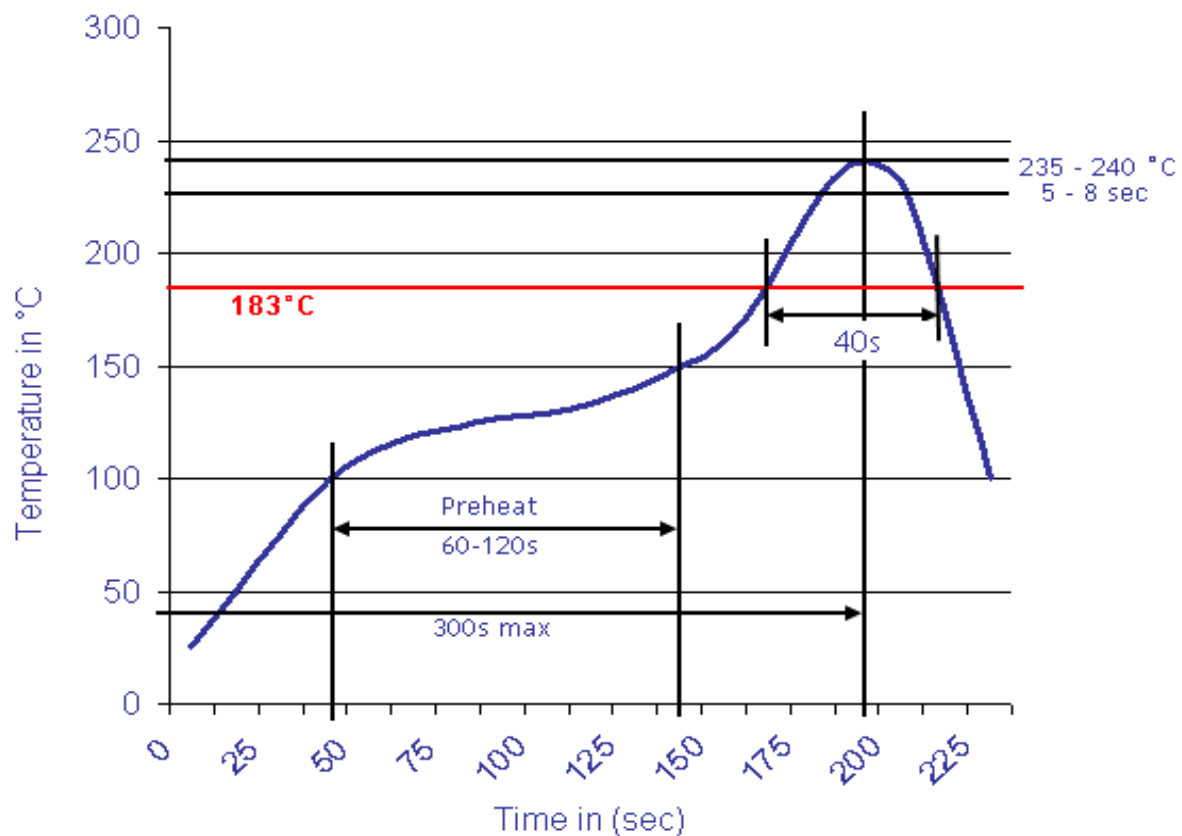

Wafer Serie T68Sxxxx Pitch
1,25mm

Part No.: **T68S024**

DRW:	Jason	CHKD	Wilson	MATL:	Wilson	TOLERANCE	Mason	DATE	02.04.2009	Customer:
APPD:	Schumi			FINISH	Jamy		Sheet No.	4 from 4		