

EDCON-COMPONENTS

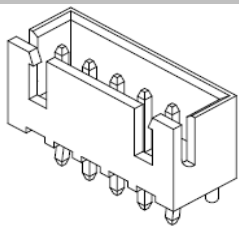

Specifications

Voltage Rating: 250 V AC/DC
 Current Rating: 3A AC/DC
 Operating Temperature: -25°C to + 85°C
 Contact Resistance: 10 mΩ
 Withstanding Voltage: 1000 V AC/Minute
 Insulation Resistance: 1000MΩ min.
 Material Housing: Nylon 66 / UL94V-0

Pin-Material: Brass /Tin-plated
 Color of Base: Natural (White)

Drawing (dimensions all into mm)

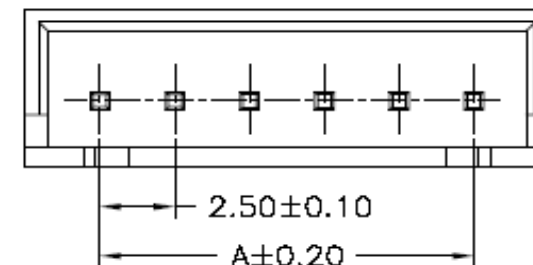
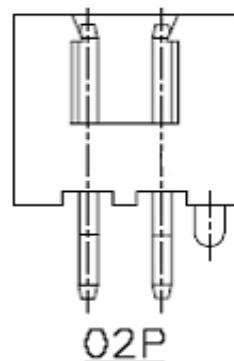

P.C.B. Layout

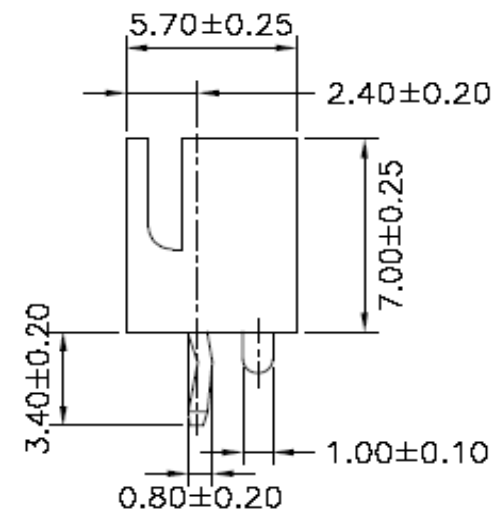
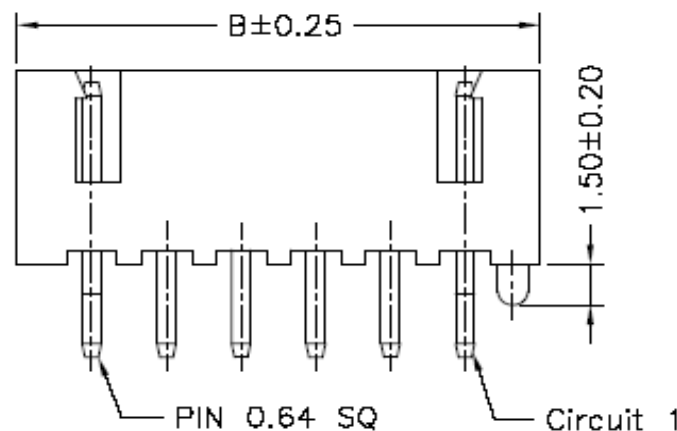
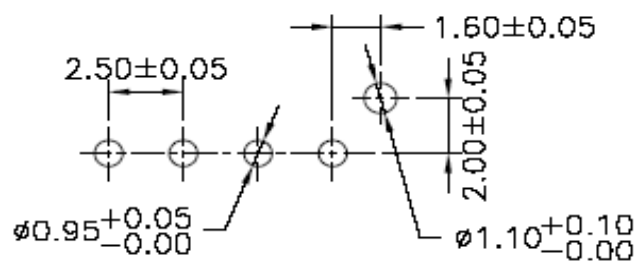

Wafer Serie T68Pxxxx Pitch 2,50mm

Part No.: **T68P300**

Customer:

DRW:	Jason	CHKD	Wilson	MATL:	Wilson	TOLERANCE	Mason	DATE	02.04.2009
APPD:	Schumi			FINISH	Jamy		Sheet No.		1 from 4

EDCON-COMPONENTS

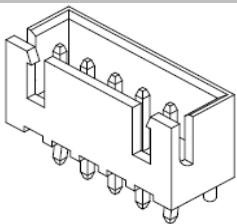

Dimension Information about Housing

Pos.	Dimension (mm)					
	A	B	C	D	E	F
2	2,50	7,50				
3	5,00	10,00				
4	7,50	12,50				
5	10,00	15,00				
6	12,50	17,50				
7	15,00	20,00				
8	17,50	22,50				
9	20,00	25,00				
10	22,50	27,50				
11	25,00	30,00				
12	27,50	32,50				
13	30,00	35,00				
14	32,50	37,50				
15	35,00	40,00				
16	37,50	42,50				
17	40,00	45,00				
18	42,50	47,50				
19	45,00	50,00				
20	47,50	52,50				

Pos.	Dimension (mm)					
	A	B	C	D	E	F

Wafer Serie T68Pxxxx Pitch 2,50mm
Part No.: T68P300
Customer:

DRW: Jason	CHKD: Wilson	MATL: Wilson	TOLERANCE: Mason	DATE: 02.04.2009
APPD: Schumi		FINISH: Jamy	Sheet No.:	2 from 4

EDCON-COMPONENTS

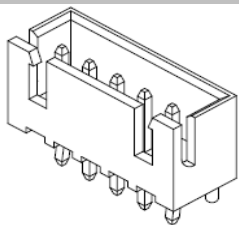

Ordering Informations

Serie	Number of Pos.	Leg Function	Color of Body	Packing						
-------	----------------	--------------	---------------	---------	--	--	--	--	--	--

T68P300	02	N	WH	BU						
----------------	-----------	----------	-----------	-----------	--	--	--	--	--	--

xx = Pos.	N= without Kink Type 3	WH= White	BU= Bulk Ware							
	K= without Kink Type 1									
	L= without Kink Type 2									

Wafer Serie T68Pxxxx Pitch 2,50mm
Part No.: T68P300
Customer:

DRW:	Jason	CHKD	Wilson	MATL:	Wilson	TOLERANCE	Mason	DATE	02.04.2009
APPD:	Schumi			FINISH	Jamy		Sheet No.		3 from 4

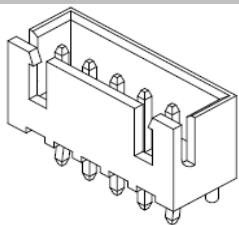

Soldering Profile Curve

Classification Reflow Profile (JEDEC J-STD-020C)

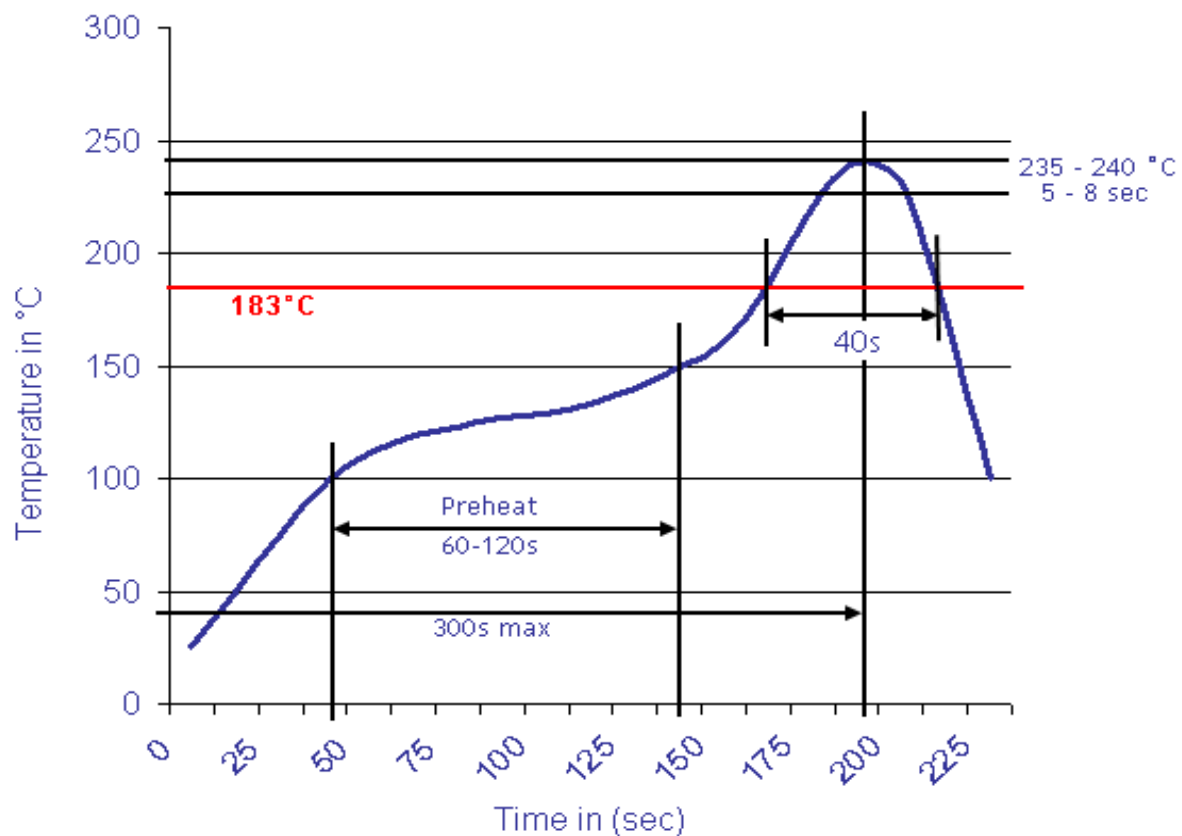

Wafer Serie T68Pxxxx Pitch
2,50mm

Part No.: **T68P300**

DRW:	Jason	CHKD	Wilson	MATL:	Wilson	TOLERANCE	Mason	DATE	02.04.2009	Customer:
APPD:	Schumi			FINISH	Jamy		Sheet No.	4 from 4		