

# EDCON-COMPONENTS

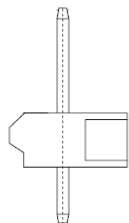

## Specifications

Voltage Rating: 250 V AC/DC  
 Current Rating: 3A AC/DC  
 Operating Temperature: -25°C to + 85°C  
 Contact Resistance: 10 mΩ  
 Withstanding Voltage: 250 V AC/Minute  
 Insulation Resistance: 500MΩ min.  
 Material Housing: Nylon 66 / UL94V-0

Pin-Material: Brass /Tin-plated  
 Color of Base: Nylon 66 UL94V-0

## Drawing ( dimensions all into mm)

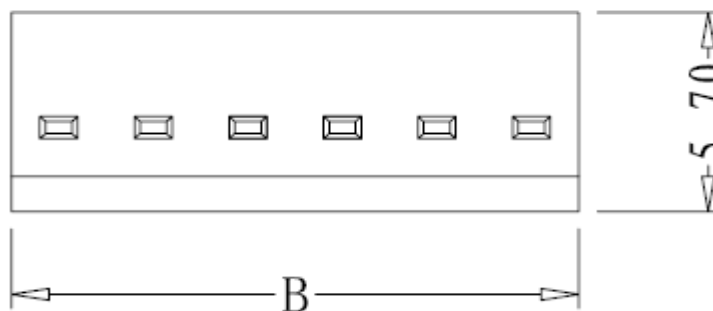
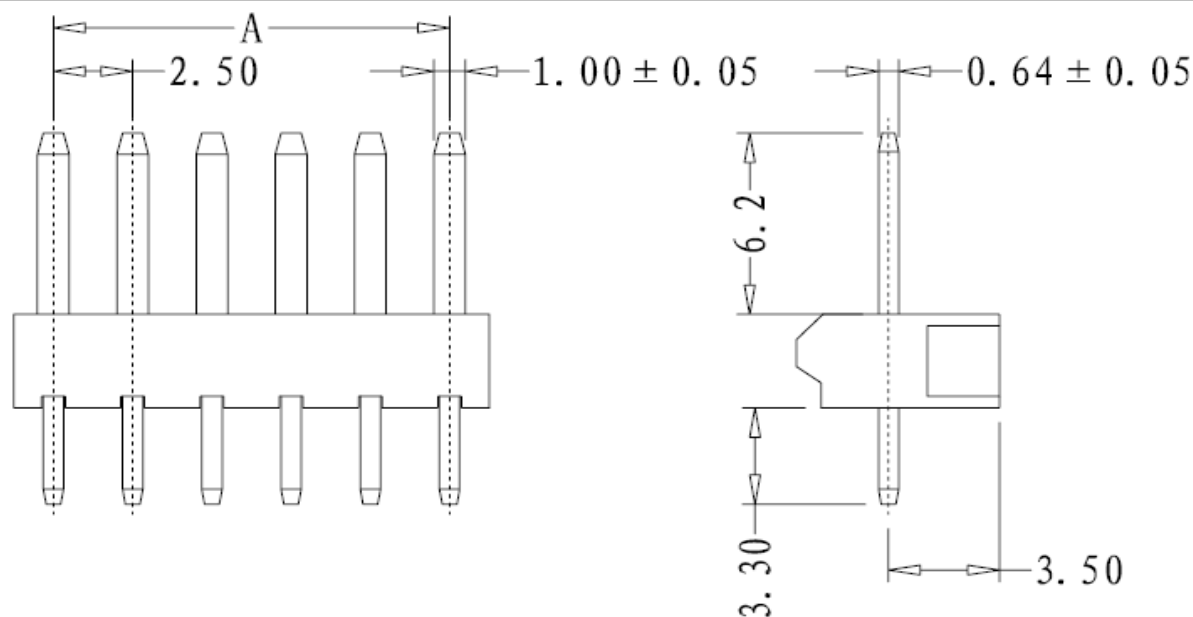

Wafer Serie T68Pxxx Pitch 2,50mm	
Part No.:	<b>T68P060</b>
Customer:	

DRW:	Jason	CHKD	Wilson	MATL:	Wilson	TOLERANCE	Mason	DATE	26.05.2011
APPD:	Schumi			FINISH	Jamy		Sheet No.		1 from 4

# EDCON-COMPONENTS

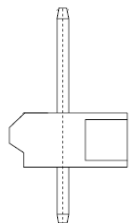

## Dimension Information about Housing

Pos.	Dimension (mm)					
	A	B	C	D	E	F
2	2,50	5,00				
3	5,00	7,50				
4	7,50	10,00				
5	10,00	12,50				
6	12,50	15,00				
7	15,00	17,50				
8	17,50	20,00				
9	20,00	22,50				
10	22,50	25,00				
11	25,00	27,50				
12	27,50	30,00				
13	30,00	32,50				
14	32,50	35,00				
15	35,00	37,50				
16	37,50	40,00				
17	40,00	42,50				
18	42,50	45,00				
19	45,00	47,50				
20	47,50	50,00				

Pos.	Dimension (mm)					
	A	B	C	D	E	F

Wafer Serie T68Pxxx Pitch 2,50mm	
Part No.:	<b>T68P060</b>
Customer:	

DRW:	Jason	CHKD	Wilson	MATL:	Wilson	TOLERANCE	Mason	DATE	26.05.2011
APPD:	Schumi			FINISH	Jamy		Sheet No.	2 from 4	

# EDCON-COMPONENTS

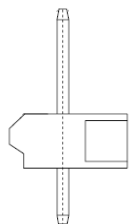

## Ordering Informations

Serie	Number of Pos.	Leg Function	Color of Body	Contact Plating	ROHS	Packing				
<b>T68P060</b>	<b>02</b>	<b>N</b>	<b>WH</b>	<b>TN</b>	<b>R</b>	<b>BU</b>				
<b>xx = Pos.</b>	<b>N= without Kink</b>	<b>WH= White</b>	<b>TN= Tin plated</b>	<b>R= Rohs Conform</b>	<b>BU= Bulk Ware</b>					
				<b>N= NON Rohs Conform</b>						

Wafer Serie T68Pxxx Pitch 2,50mm
Part No.: <b>T68P060</b>
Customer:

DRW:	Jason	CHKD	Wilson	MATL:	Wilson	TOLERANCE	Mason	DATE	26.05.2011
APPD:	Schumi			FINISH	Jamy		Sheet No.		3 from 4

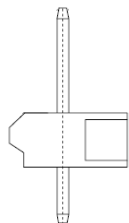

Soldering Profile Curve

Classification Reflow Profile (JEDEC J-STD-020C)



Wafer Serie T68Pxxx Pitch 2,50mm
Part No.: <b>T68P060</b>
Customer:

DRW:	Jason	CHKD	Wilson	MATL:	Wilson	TOLERANCE	Mason	DATE	26.05.2011
APPD:	Schumi			FINISH	Jamy		Sheet No.	4 from 4	