

EDCON-COMPONENTS

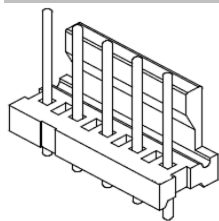

Specifications

Voltage Rating:	600 V AC/DC
Current Rating:	7A AC/DC
Operating Temperature:	-25°C to + 85°C
Contact Resistance:	3 mΩ
Withstanding Voltage:	2200 V AC/Minute
Insulation Resistance:	5000MΩ min.
Material Housing:	Nylon 66 / UL94V-0
Pin-Material:	Brass /Tin-plated
Body Color:	Natural (White)

Drawing (dimensions all into mm)

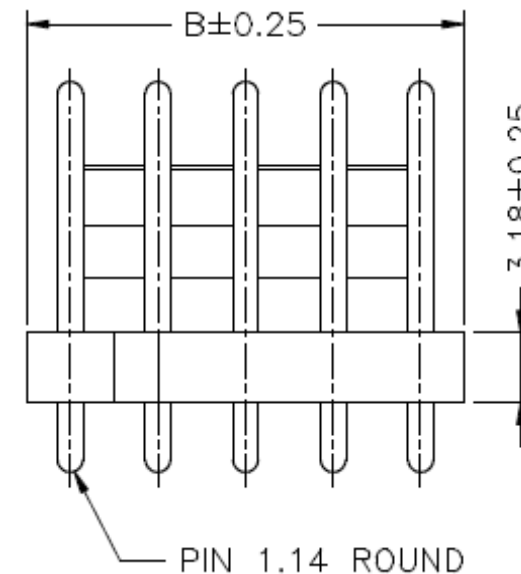
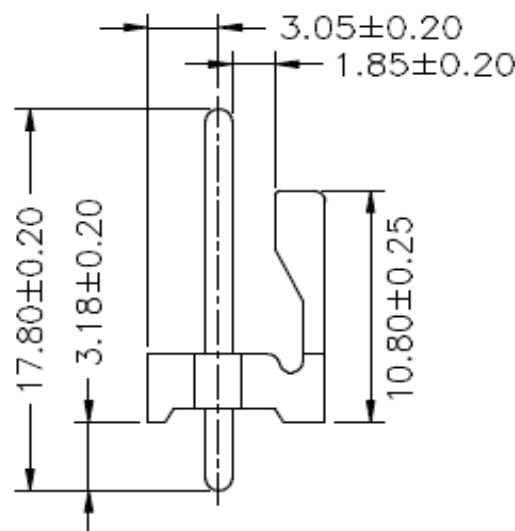

P.C.B. Layout

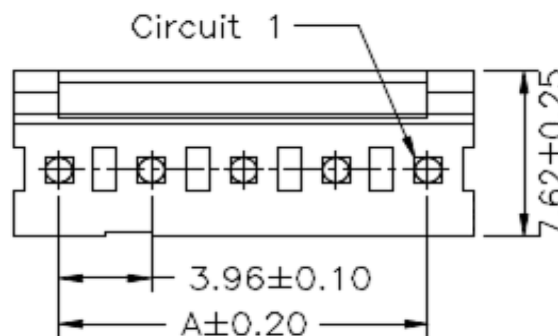
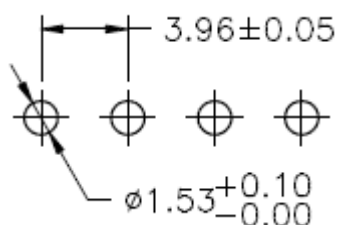

Wafer Serie T68Jxxxx Pitch
3,96mm

Part No.: **T68J019**

Customer:

DRW:	Jason	CHKD	Wilson	MATL:	Wilson	TOLERANCE	Mason	DATE	02.04.2009
APPD:	Schumi			FINISH	Jamy		Sheet No.	1 from 4	

EDCON-COMPONENTS

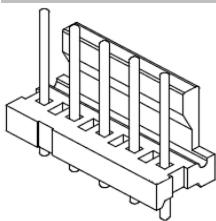

Ordering Informations

Serie	Number of Pos.	Leg function	Color of Body	Packing						
-------	----------------	--------------	---------------	---------	--	--	--	--	--	--

T68J019	02	N	WH	BU						
----------------	-----------	----------	-----------	-----------	--	--	--	--	--	--

xx = Pos.	N= without King	WH= White	BU= Bulk - Ware							

Wafer Serie T68Jxxxx Pitch 3,96mm
Part No.: T68J019
Customer:

DRW:	Jason	CHKD	Wilson	MATL:	Wilson	TOLERANCE	Mason	DATE	02.04.2009
APPD:	Schumi			FINISH	Jamy		Sheet No.		3 from 4

www.edcon-components.com

email: info@edcon-components.com

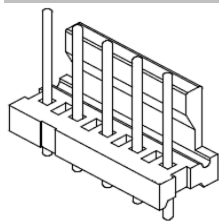

Soldering Profile Curve

Classification Reflow Profile (JEDEC J-STD-020C)

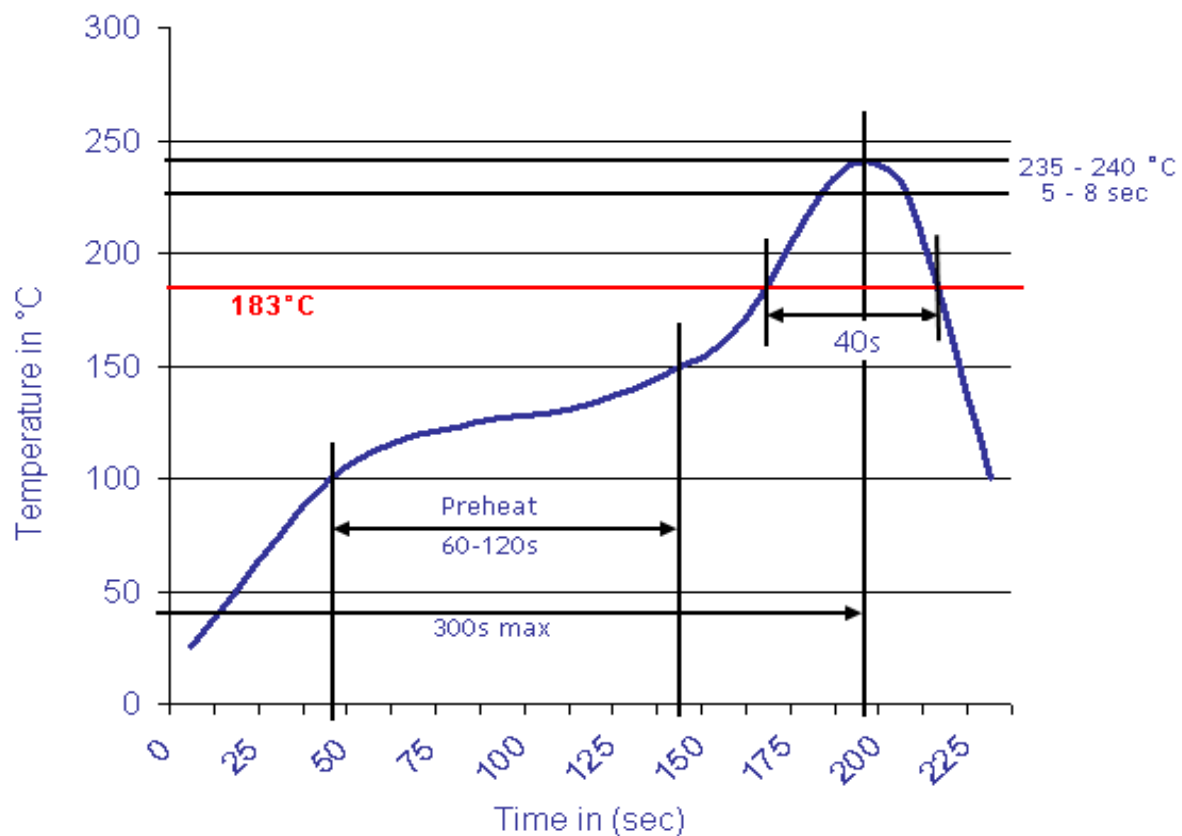

Wafer Serie T68Jxxxx Pitch 3,96mm
Part No.: T68J019
Customer:

DRW:	Jason	CHKD	Wilson	MATL:	Wilson	TOLERANCE	Mason	DATE	02.04.2009
APPD:	Schumi			FINISH	Jamy		Sheet No.	4 from 4	