

EDCON-COMPONENTS

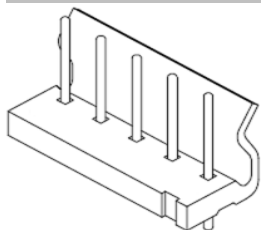

Specifications

Voltage Rating:	250 V AC/DC
Current Rating:	7A AC/DC
Operating Temperature:	-25°C to +85°C
Contact Resistance:	10 mΩ
Withstanding Voltage:	1500 V AC/Minute
Insulation Resistance:	1000MΩ min.
Material Housing:	Nylon 66 / UL94V-2
Pin-Material:	Brass /Tin-plated
Body Color:	Natural / White

Drawing (dimensions all into mm)

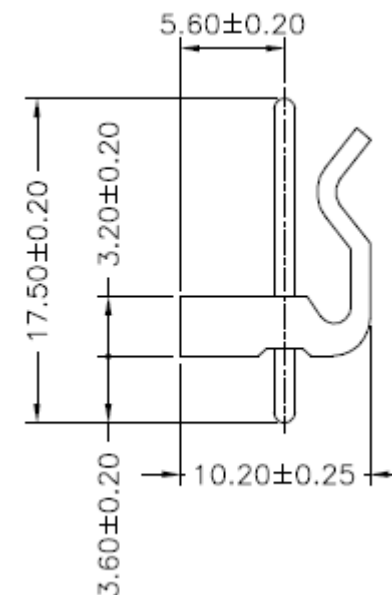
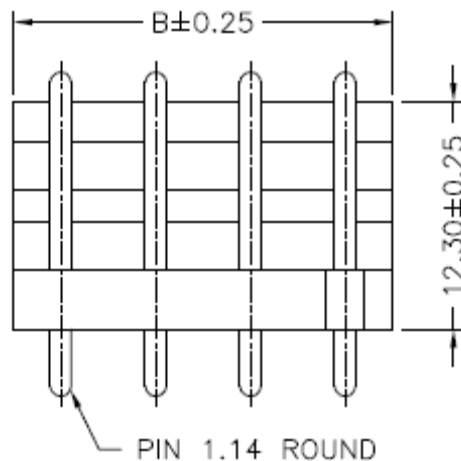

P.C.B. Layout

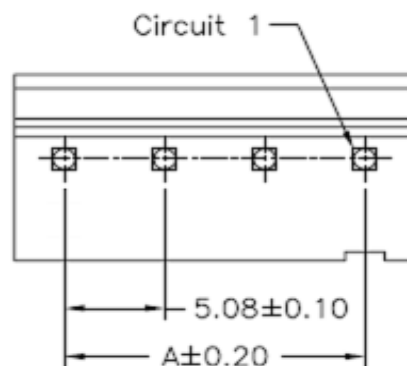
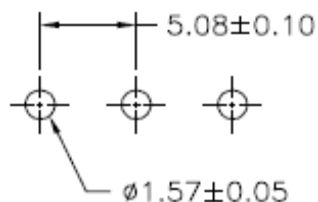

Wafer Serie T68Dxxxx Pitch 5,08mm	
Part No.:	T68D301
Customer:	

DRW:	Jason	CHKD	Wilson	MATL:	Wilson	TOLERANCE	Mason	DATE	02.04.2009
APPD:	Schumi			FINISH	Jamy		Sheet No.	1 from 4	

EDCON-COMPONENTS

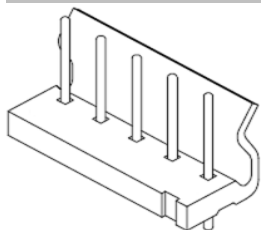

Dimension Information about Housing

Pos.	Dimension (mm)					
	A	B	C	D	E	F
2	5,08	10,16				
3	10,16	15,24				
4	15,24	20,32				
5	20,32	25,40				
6	25,40	30,48				
7	30,48	35,56				
8	35,56	40,64				
9	40,64	45,72				
10	45,72	50,80				
11	50,80	55,88				
12	55,88	60,96				
13	60,96	66,04				
14	66,04	71,12				
15	71,12	76,20				
16	76,20	81,28				
17	81,28	86,36				
18	86,36	91,44				
19	91,44	96,52				
20	96,52	101,60				

Pos.	Dimension (mm)					
	A	B	C	D	E	F

Wafer Serie T68Dxxxx Pitch 5,08mm	
Part No.:	T68D301
Customer:	

DRW:	Jason	CHKD	Wilson	MATL:	Wilson	TOLERANCE	Mason	DATE	02.04.2009
APPD:	Schumi			FINISH	Jamy		Sheet No.	2 from 4	

EDCON-COMPONENTS

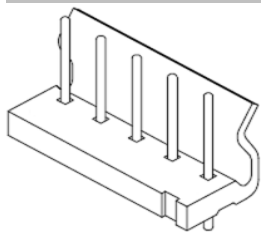

Ordering Informations

Serie	Number of Pos.	Color of Body	Packing							
-------	----------------	---------------	---------	--	--	--	--	--	--	--

T68D301	02	NA	BU							
----------------	-----------	-----------	-----------	--	--	--	--	--	--	--

xx = Pos.	NA= Natural	BU= Bulk-ware								
	WH= White									

Wafer Serie T68Dxxxx Pitch 5,08mm	
Part No.:	T68D301
Customer:	

DRW:	Jason	CHKD	Wilson	MATL:	Wilson	TOLERANCE	Mason	DATE	02.04.2009
APPD:	Schumi			FINISH	Jamy			Sheet No.	3 from 4

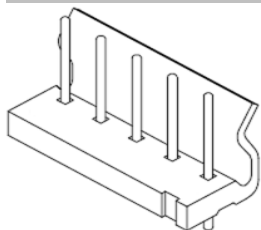

Soldering Profile Curve

Classification Reflow Profile (JEDEC J-STD-020C)

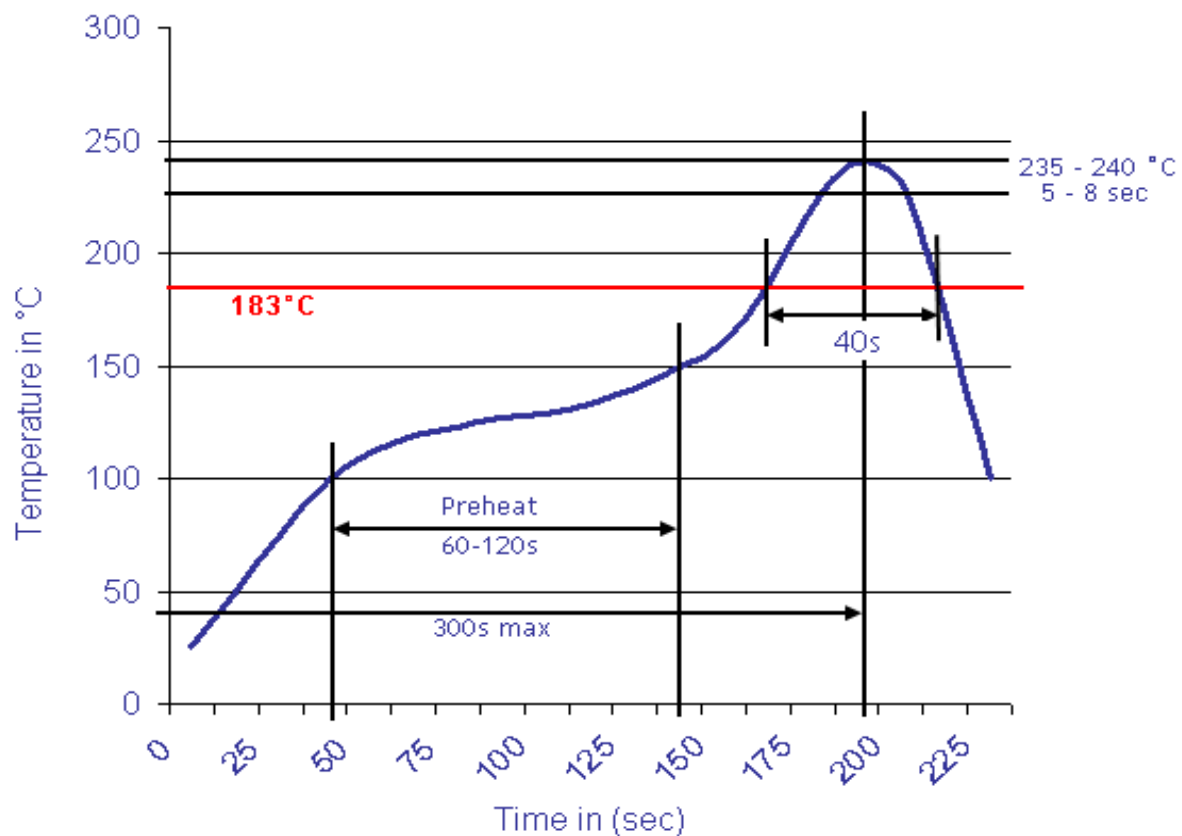

Wafer Serie T68Dxxxx Pitch
5,08mm

Part No.: **T68D301**

DRW:	Jason	CHKD	Wilson	MATL:	Wilson	TOLERANCE	Mason	DATE	02.04.2009	Customer:
APPD:	Schumi			FINISH	Jamy		Sheet No.	4 from 4		