

# Data Sheet

## Pluggable Terminal Block

**Pitch: 5,08 mm**

**Serie: A14M035**

### Customer Information for special Item

**EDCON Customer : 0**

**Customer Version No. : 0**

# EDCON-COMPONENTS



## Technical Discription

## Drawing (Dimension in mm)

### Electrical

Standard	UL	IEC	TÜV
Rated voltage	300V	300V	300V
Rated current	20A	20A	20A
Wire range	24-12 AWG	2.5mm <sup>2</sup>	2.5mm <sup>2</sup>
Withstanding voltage	1.6KV	2.5KV	2.5KV

### Mechanical

Ambient temperature	-40°C ~ +115°C
Strip length	7~8mm
Screw, Torque	M3, 0.5Nm (5Lb-In.)

### Dimensions

Pitch	5.08mm
Poles	2P - 24P

### Material

Housing	Thermoplastic (UL94V-0)
Contact	Brass
Cage	steel Zinc
Terminal screw	steel, Cr <sup>3+</sup> Zn plated

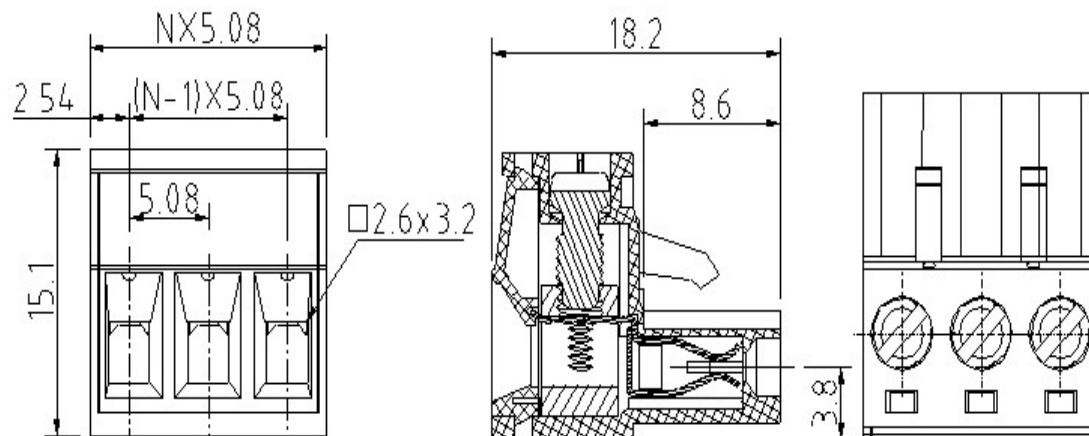

### Pluggable Terminal Block

Part No.: **A14M035**

Customer:

DRW:	Jason	CHKD	Wilson	MATL:	Wilson	TOLERANCE	Mason	DATE	27.03.2022
APPD:	Schumi			FINISH	Jamy		Sheet No.		1 from 4

# EDCON-COMPONENTS



PCB Layout (Dimension in mm)

Dimensions (mm)

No. of Pos.	A	Tol. P
02	10,16	± 0,35
03	15,24	± 0,35
04	20,32	± 0,35
05	25,40	± 0,35
06	30,48	± 0,35
07	35,56	± 0,35
08	40,64	± 0,35
09	45,72	± 0,35
10	50,80	± 0,35
11	55,88	± 0,35
12	60,96	± 0,35
13	66,04	± 0,35
14	71,12	± 0,35
15	76,20	± 0,35
16	81,28	± 0,35
17	86,36	± 0,35
18	91,44	± 0,35
19	96,52	± 0,35
20	101,60	± 0,35
21	106,68	± 0,35
22	111,76	± 0,35

<b>Pluggable Terminal Block</b>	
Part No.:	<b>A14M035</b>
Customer:	

DRW:	Jason	CHKD	Wilson	MATL:	Wilson	TOLERANCE	Mason	DATE	27.03.2022
APPD:	Schumi			FINISH	Jamy		Sheet No.		2 from 4

[www.edcon-components.com](http://www.edcon-components.com)

email: [info@edcon-components.com](mailto:info@edcon-components.com)



# EDCON-COMPONENTS



## Ordering Informations

Serie	No. of Pos.	Body Color	Screw Type	Approval Code	ROHS	Packing	EDCON Cust. No.	Customer Version		
<b>A14M035</b>	<b>02</b>	<b>GN</b>	<b>A</b>	<b>N</b>	<b>R</b>	<b>B</b>				

Pitch  
5,08

<b>02</b> = Number of Pos.  Standard 2 ~ 24Pos.	<b>GY</b> = Gray (Standard)	<b>A</b> = Slotted Screw Type (Standard) 	<b>0</b> = NON Approval  <b>N</b> = UL /UR Approval	<b>R</b> = ROHS Conform  <b>N</b> = NON ROHS Conform	<b>B</b> = Standard Package  <b>I</b> = Individual Package	<b>xxxxxx</b> = Customer Number	<b>xxx</b> = Customer Version ??(Printing)
	<b>GN</b> = Green	<b>B</b> = Cross Slotted Screw Type 	<b>B</b> = VDE Approval Please consult EDCON for available	<b>C</b> = TÜV Approval Please consult EDCON for available			
<b>OR</b> = Orange							
<b>BK</b> = Black							

<b>Pluggable Terminal Block</b>	
Part No.:	<b>A14M035</b>
Customer:	

DRW:	Jason	CHKD	Wilson	MATL:	Wilson	TOLERANCE	Mason	DATE	27.03.2022
APPD:	Schumi			FINISH	Jamy		Sheet No.		3 from 4



Soldering Profile Curve

Classification Reflow Profile (JEDEC J-STD-020C)

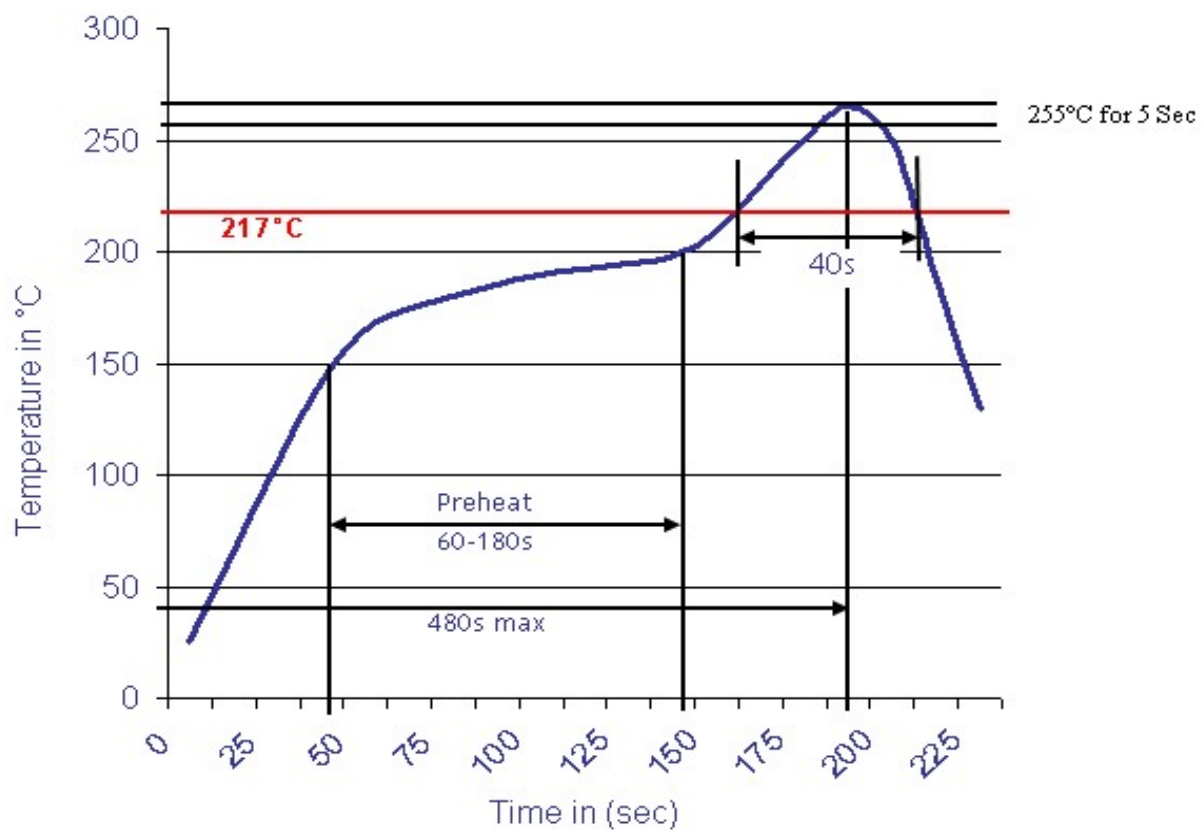

**Pluggable Terminal Block**

Part No.: **A14M035**

Customer:

DRW:	Jason	CHKD	Wilson	MATL:	Wilson	TOLERANCE	Mason	DATE	27.03.2022
APPD:	Schumi			FINISH	Jamy		Sheet No.	4 from 4	