

# Data Sheet

## Elevated Terminal Block

**Pitch: 5,08 mm**

**Serie: A13M027**

### Customer Information for special Item

**EDCON Customer : 0**

**Customer Version No. : 0**

# EDCON-COMPONENTS



## Technical Discription

## Drawing (Dimension in mm)

### Electrical

Rated Voltage	250 Volt
Rated Current	18A
Wire Range	
Solid Wire	AWG 12~24
Stranged Wire	AWG 12~24
Withstanding Voltage	2,0KV
Insulation Resistance	5000MΩ / 1000V

### Mechanical

Operating Temperature	-40°C ~ +115°C
Wire Strip Length	7mm

### Dimensions

Pitch (mm)	5,08
Poles	2 + 3Pos. ~ 24 Pos.

### Materials

1 Terminal Housing	Thermoplastic ( UL94V-0)
2 Clamp	Brass Ni, plated
3 Wire guard	Wire guard solder Pin
4 Terminal screw	Steel Zinc plating
5 Terminal Housing Cover	Thermoplastic ( UL94V-0)

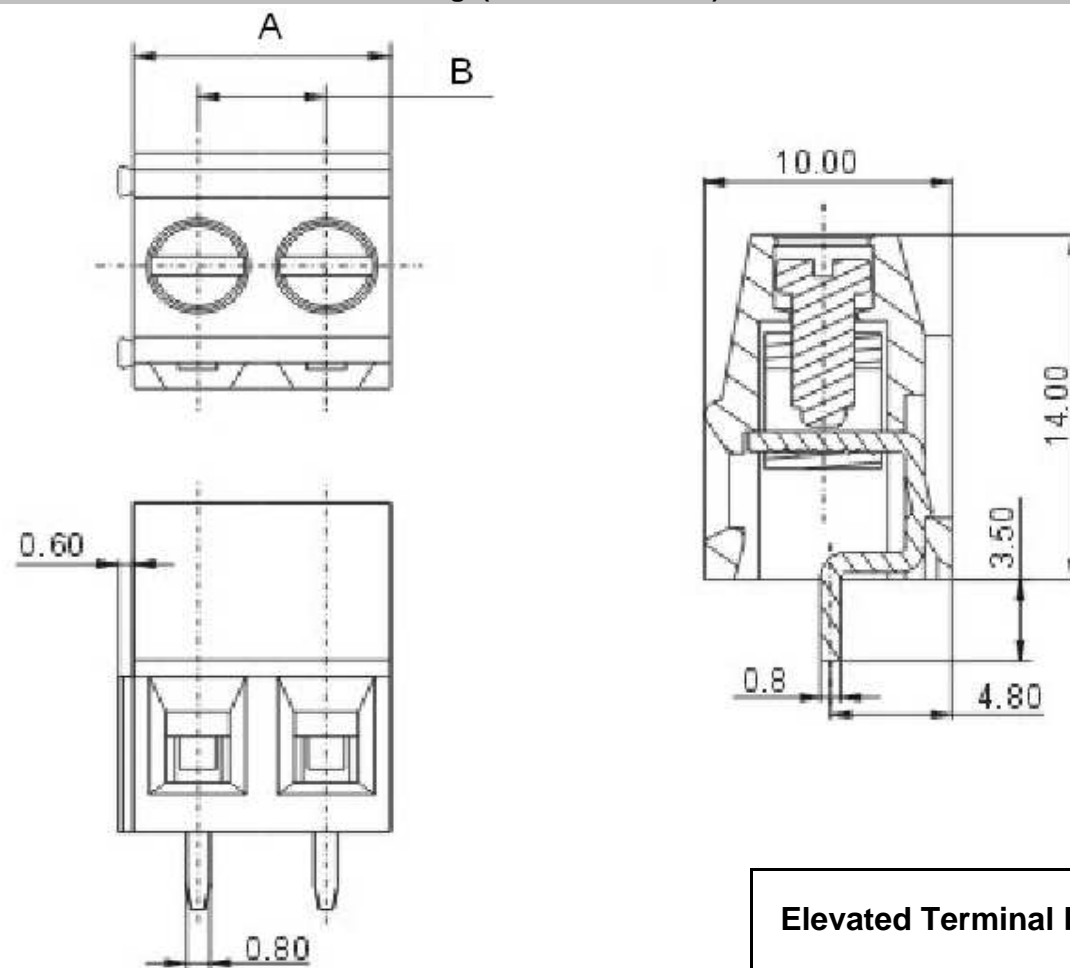

### Elevated Terminal Block

Part No.: **A13M027**

Customer:

DRW:	Jason	CHKD	Wilson	MATL:	Wilson	TOLERANCE	Mason	DATE	11.02.2011
APPD:	Schumi			FINISH	Jamy		Sheet No.		1 from 4

# EDCON-COMPONENTS



PCB Layout



Dimensions (mm)

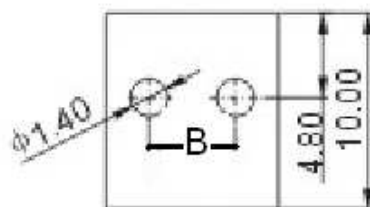

No. of Pos.	A	Tol. A	B	Tol. B
02	10,16	$\pm 0,15$	5,08	$\pm 0,15$
03	15,24	$\pm 0,15$	10,16	$\pm 0,15$
04	20,32	$\pm 0,15$	15,24	$\pm 0,15$
05	25,40	$\pm 0,15$	20,32	$\pm 0,15$
06	30,48	$\pm 0,15$	25,40	$\pm 0,15$
07	35,56	$\pm 0,25$	30,48	$\pm 0,25$
08	40,64	$\pm 0,25$	35,56	$\pm 0,25$
09	45,72	$\pm 0,25$	40,64	$\pm 0,25$
10	50,80	$\pm 0,25$	45,72	$\pm 0,25$
11	55,88	$\pm 0,25$	50,80	$\pm 0,25$
12	60,96	$\pm 0,25$	55,88	$\pm 0,25$
13	66,04	$\pm 0,35$	60,96	$\pm 0,35$
14	71,12	$\pm 0,35$	66,04	$\pm 0,35$
15	76,20	$\pm 0,35$	71,12	$\pm 0,35$
16	81,28	$\pm 0,35$	76,20	$\pm 0,35$
17	86,36	$\pm 0,35$	81,28	$\pm 0,35$
18	91,44	$\pm 0,35$	86,36	$\pm 0,35$
19	96,52	$\pm 0,35$	91,44	$\pm 0,35$
20	101,60	$\pm 0,40$	96,52	$\pm 0,40$
21	106,68	$\pm 0,40$	101,60	$\pm 0,40$
22	111,76	$\pm 0,40$	106,68	$\pm 0,40$
23	116,84	$\pm 0,40$	111,76	$\pm 0,40$
24	121,92	$\pm 0,40$	116,84	$\pm 0,40$

## Elevated Terminal Block

Part No.: **A13M027**

Customer:

DRW:	Jason	CHKD	Wilson	MATL:	Wilson	TOLERANCE	Mason	DATE	11.02.2011
APPD:	Schumi			FINISH	Jamy		Sheet No.	2 from 4	

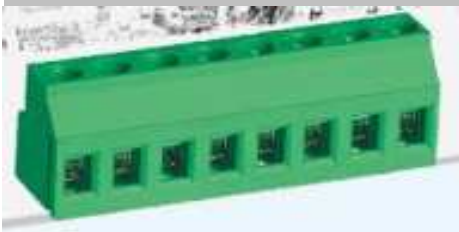

# EDCON-COMPONENTS



## Ordering Informations

Serie	No. of Pos.	Body Color	No Function	Approval Code	ROHS	Packing	EDCON Cust. No.	Customer Version		
-------	-------------	------------	-------------	---------------	------	---------	-----------------	------------------	--	--

<b>A13M027</b>	<b>02</b>	<b>PG</b>	<b>A</b>	<b>N</b>	<b>R</b>	<b>B</b>				
----------------	-----------	-----------	----------	----------	----------	----------	--	--	--	--

Pitch 5,08	<b>02=</b> Number of Pos. Standard 2 + 3Pos- ~ 24Pos.	<b>PG=</b> Phoenix Green (Standard) <b>WH=</b> White <b>GN=</b> Green <b>GY=</b> Gray <b>LG=</b> Light Gray <b>OR=</b> Orange <b>BL=</b> Blue <b>BK=</b> Black	<b>A=</b> Slotted Screw Type (Standard)  <b>B=</b> Cross Slotted Screw Type 	<b>N=</b> NON Approval <b>A=</b> UL /UR Approval Please consult EDCON for available <b>B=</b> VDE Approval Please consult EDCON for available <b>C=</b> TÜV Approval Please consult EDCON for available	<b>R=</b> ROHS Conform <b>N=</b> NON ROHS Conform	<b>B=</b> Bulk-Ware <b>I=</b> Individual Package	<b>xxxxxx=</b> Customer Number	<b>xxx=</b> Customer Version ??(Printing)		
---------------	--	---	---	--	--	---	--------------------------------	---	--	--

Elevated Terminal Block	
Part No.:	<b>A13M027</b>
Customer:	

DRW:	Jason	CHKD	Wilson	MATL:	Wilson	TOLERANCE	Mason	DATE	11.02.2011
APPD:	Schumi			FINISH	Jamy		Sheet No.		3 from 4

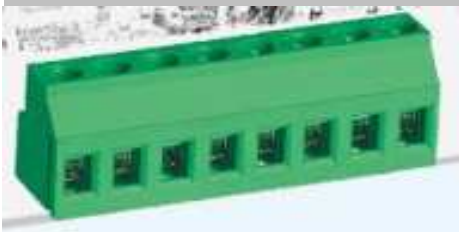

Soldering Profile Curve

Classification Reflow Profile (JEDEC J-STD-020C)



<b>Elevated Terminal Block</b>	
Part No.:	<b>A13M027</b>
Customer:	

DRW:	Jason	CHKD	Wilson	MATL:	Wilson	TOLERANCE	Mason	DATE	11.02.2011
APPD:	Schumi			FINISH	Jamy		Sheet No.	4 from 4	