

EDCON-COMPONENTS

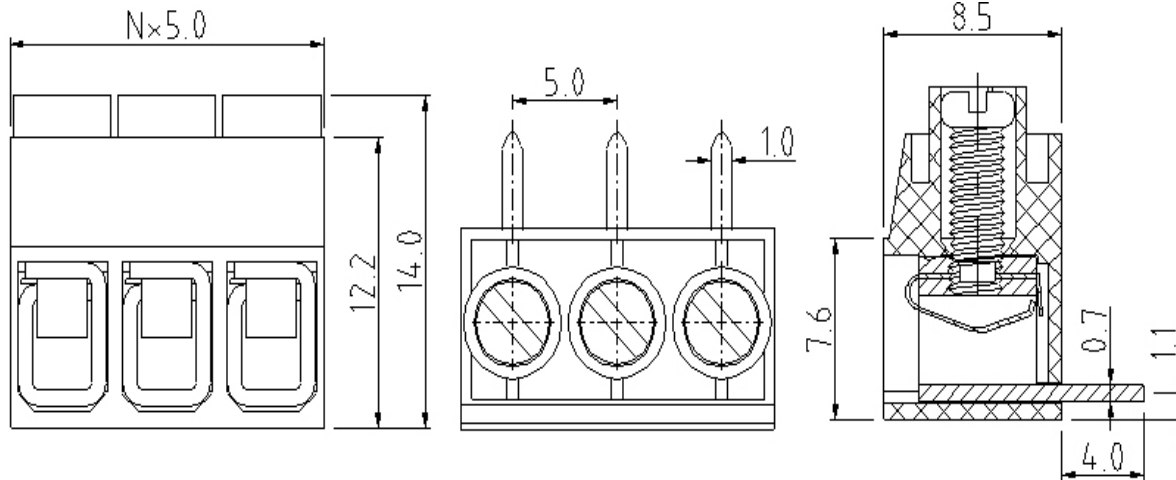

Drawing



P.C.B. Layout

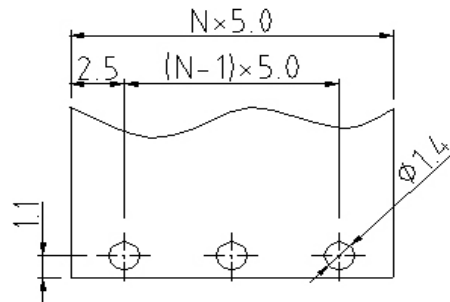

Specification

| APPROVAL | UL | cUL |
|------------------------|-------------------------|-----------|
| Electrical | | |
| Standard | UL | cUL |
| Rated voltage | 300C | 250V |
| Rated current | 10A | 15A |
| Wire range | 22-12 AWG | 20-12 AWG |
| Withstanding voltage | 1.6KV | 1.5KV |
| Mechanical | | |
| Ambient temperature | -40°C ~ +115°C | |
| Soldering temperature | 250°C ± 10°C/5 sec | |
| Strip length | 6 ~ 7mm | |
| Screw, Torque | M2.5, 0.4Nm (3.5Lb-In) | |
| Dimensions | | |
| Pitch | 5.00mm | |
| Poles | 2P - 24P | |
| Material | | |
| Housing | Thermoplastic (UL94V-0) | |
| Surface of solder tail | Tin plated | |
| Contact | Stainless steel | |
| Terminal screw | Steel Zinc plated | |
| Metal housing | Brass Stamped | |



Wire Protector Terminal Block /
Pitch 5.00mm

Part No.: A12L025

Customer:

| | | | | | | | | | |
|-------|-------|------|------|--------|-------|-----------|-----|-----------|------------|
| DRW: | Bill | CHKD | Lord | MATL: | Jimmy | TOLERANCE | Sam | DATE | 14.03.2009 |
| APPD: | Louis | | | FINISH | Georg | | | Sheet No. | 1 from 3 |

www.edcon-components.com

email: info@edcon-components.com

EDCON-COMPONENTS



Ordering Informations

| Serie | - | No. of Pole | Body-Color | wire protector | Screw | - | Customer Request |
|---------|---|-------------|------------|----------------|-------|---|------------------|
| A12L025 | - | XX | XX | X | X | - | X |

| | | | |
|------------|-----------------|----------------------------|------------------------------|
| XX = total | WH - white | 1 - with wire protector | A - Slotted screw (standard) |
| 02 | GN - green | 2 - without wire protector | B - Cross-slotted screw |
| ... | GR - gray | | |
| 24 | LG - light gray | | |

| |
|--------------------|
| PG - Phoenix Green |
| OR - orange |
| BL - blue |
| BK - black |

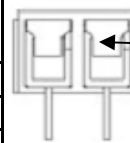

wire protector

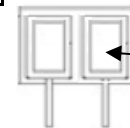

without wire protector



Certification



Wire Protector Terminal Block /
Pitch 5.00mm

Part No.: A12L025

Customer:

| | | | | | | | | | |
|-------|-------|------|------|--------|-------|-----------|-----------|------|------------|
| DRW: | Bill | CHKD | Lord | MATL: | Jimmy | TOLERANCE | Sam | DATE | 14.03.2009 |
| APPD: | Louis | | | FINISH | Georg | | Sheet No. | | 2 from 3 |

www.edcon-components.com

email: info@edcon-components.com



Soldering - Profil

Classification Reflow Profile (JEDEC J-STD-020C)

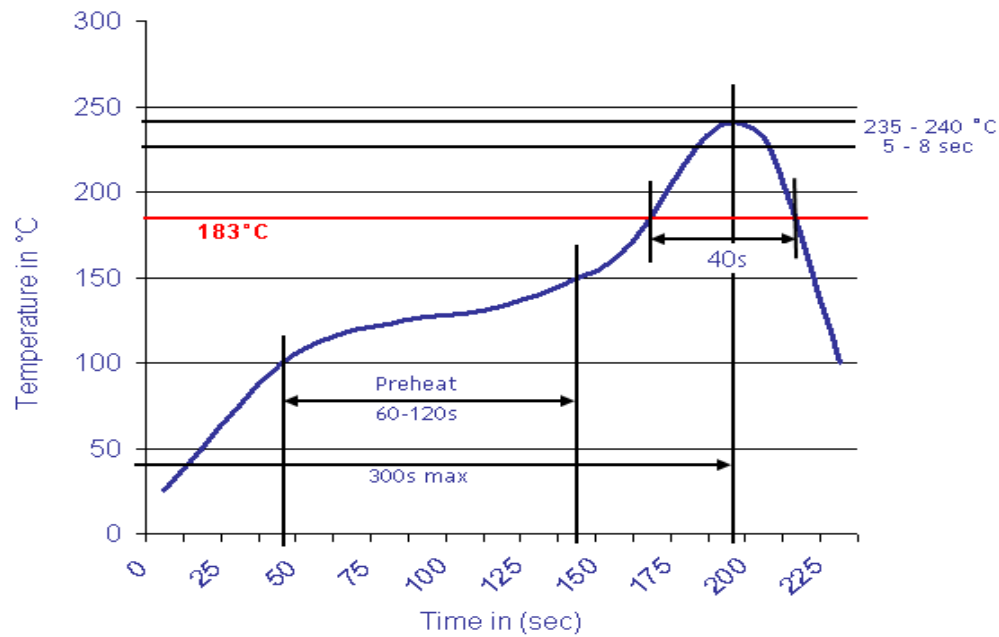

Wire Protector Terminal Block /
Pitch 5.00mm

Part No.: A12L025

Customer:

| | | | | | | | | | |
|-------|-------|------|------|--------|-------|-----------|-----------|----------|------------|
| DRW: | Bill | CHKD | Lord | MATL: | Jimmy | TOLERANCE | Sam | DATE | 14.03.2009 |
| APPD: | Louis | | | FINISH | Georg | | Sheet No. | 3 from 3 | |