

EDCON-COMPONENTS



Specifications

Features

Contact Positions: 09, 15, 25, 37

Plus a ferrite plate as a high frequency anti noise interlace with digital equipments
It performs like a low pass filter that removes noises in the high frequency range 100-300Mhz.

Various types of fasten option Idela for handling speed signals Prevention of EMI/RFI.
Designed for use with data signal carrying device.

Materials

Contact Brass

Housing: PBT +30% Glass Fiber (UL 94V-0)

Shell: cold roller steel

Electrical Characteristics

Current Rating: 5Ampere

Withstanding Voltage: AC 1250V r.m.s.

Insulation Resistance: 5000 Megaohms Minimum at DC500V

Contact Resistance: 15 Milliohm Maximum

Operation Temperature: -55°C ~ +105°C

Applicable: P.C. Board thickness: (1,6mm)

Mechanical Characteristics:

Contact Resistance Force: 341gr. Maximum

Contact Separation Force: 20gr. Minimum

Finishes:

Contact Plating (look Order Code)

Shell Plating (look order code)

Dimensions (mm)

Male Contact

Pos.	9	15	25	37
Dim.A	30,80	39,20	53,05	69,40
Dim.B	25,00	33,30	47,05	63,50
Dim.C	16,90	25,25	38,95	55,40

Female Contact

Pos.	9	15	25	37
Dim.A	30,80	39,20	53,05	69,40
Dim.B	25,00	33,30	47,05	63,50
Dim.C	16,30	24,60	38,35	54,80

P.C.B. Layout

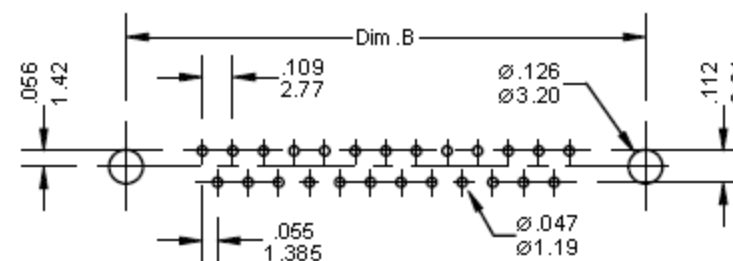

**D-Sub Connector right angle
EURO Norm 10,2mm**

Part No.: **T24E600**

Customer:

DRW:	Jason	CHKD	Wilson	MATL:	Wilson	TOLERANCE	Mason	DATE	13.01.2015
APPD:	Schumi			FINISH	Jamy		Sheet No.	1 from 4	

www.edcon-components.com

email: info@edcon-components.com

EDCON-COMPONENTS



Female Contact

Male Contact

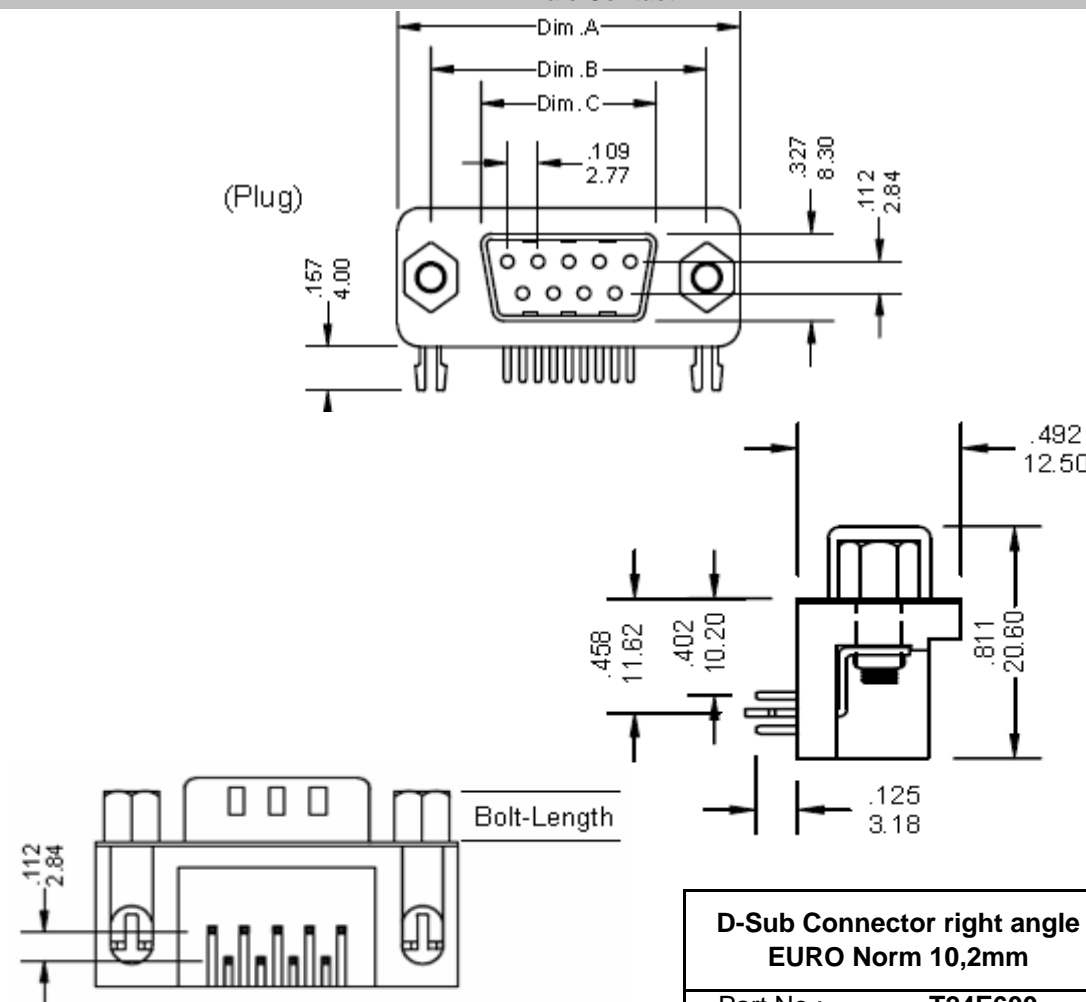
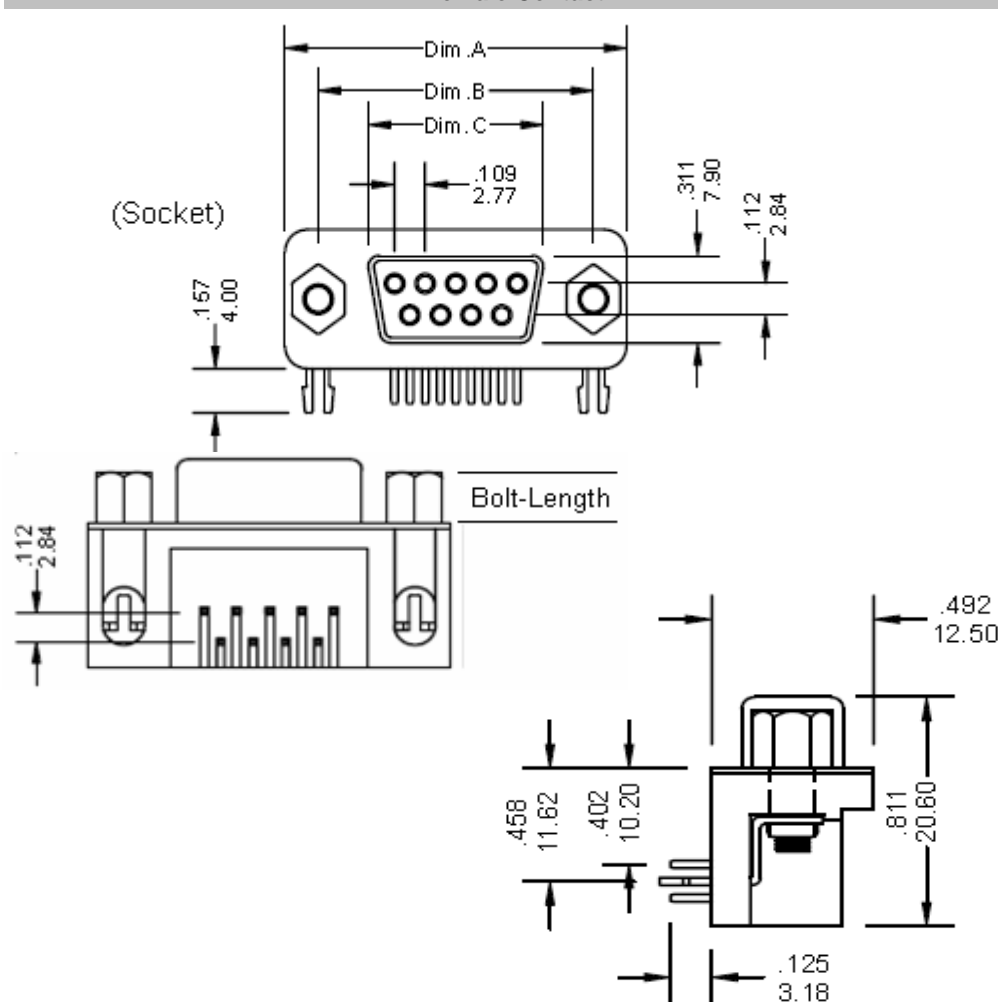

D-Sub Connector right angle EURO Norm 10,2mm	
Part No.:	T24E600
Customer:	

DRW:	Jason	CHKD	Wilson	MATL:	Wilson	TOLERANCE	Mason	DATE	13.01.2015
APPD:	Schumi			FINISH	Jamy			Sheet No.	2 from 4

EDCON-COMPONENTS



Ordering Informations

Serie	No. of contacts.	Contact Type	Shell Finish	Mounting Options	No function	No function	Contact Plating	Plastic Color	ROHS	Packing
-------	------------------	--------------	--------------	------------------	-------------	-------------	-----------------	---------------	------	---------

T24E600	09	F	T	B	0	A	GF	BK	R	TY
----------------	-----------	----------	----------	----------	----------	----------	-----------	-----------	----------	-----------

09= Contacts	F= Female	N= Nickel	A= w. Boardlock Z-Shape	0= Bolt Length 4,8mm	A= w/o UNC 4-40 screw	GF= Gold Flash	BK= Black	R= ROHS Conform	TY= Tray Packing
09, 15, 25, 37 Contacts	M= Male	T= Tin	B= Rivet w. Boardlock Z-Shape	1= Bolt Length 5,8mm	B= added UNC 4-40 screw	GA= 10µ Gold	WH= White	N= NON ROHS Conform	BU= Bulk-Ware
			C= Rivet only	2= w/o Bolt	C= w. ficed UNC 4-40 screw	GB= 15µ Gold	BL= Blue		
			D= Non Thread L-Shape			GC= 30µ Gold	GY= Gray		
			E= Rivet with non Thread L-Shape			GD= 50µ Gold			
			F= Rivet w.4-40 Thread L-Shape	H= 4 Prong Boardlock		SF= Selective Gold flash			
			G= Rivet w.M3 Thread L-Shape	J= Rivet w. 4 Prong Boardlock		SA= 5µ Selective Gold flash			
						SB= 10µ Selective Gold flash			
						SC= 15µ Selective Gold flash	SD= 30µ Selective Gold flash		

**D-Sub Connector right angle
EURO Norm 10,2mm**
Part No.: **T24E600**

DRW:	Jason	CHKD	Wilson	MATL:	Wilson	TOLERANCE	Mason	DATE	13.01.2015	Customer:
APPD:	Schumi			FINISH	Jamy			Sheet No.	3 from 4	



Soldering Profile Curve

Classification Reflow Profile (JEDEC J-STD-020C)



D-Sub Connector right angle EURO Norm 10,2mm	
Part No.:	T24E600
Customer:	

DRW:	Jason	CHKD	Wilson	MATL:	Wilson	TOLERANCE	Mason	DATE	13.01.2015
APPD:	Schumi			FINISH	Jamy		Sheet No.	4 from 4	