

# EDCON-COMPONENTS



## Specifications

### Features

Contact Positions: 09, 15, 25, 37

Plus a ferrite plate as a high frequency anti noise interlace with digital equipments  
It performs like a low pass filter that removes noises in the high frequency range  
100-300Mhz.

Various types of fasten option Idela for handling speed signals Prevention of EMI/RFI.  
Designed for use with data signal carrying device.

### Materials

Contact Brass

Housing: PBT +30% Glass Fiber (UL 94V-0)

Shell: cold roller steel

### Electrical Characteristics

Current Rating: 5Ampere

Withstanding Voltage: AC 1250V r.m.s.

Insulation Resistance: 5000 Megaohms Minimum at DC500V

Contact Resistance: 15 Milliohm Maximum

Operation Temperature: -55°C ~ +105°C

Applicable: P.C. Board thickness: (1,6mm)

### Mechanical Characteristics:

Contact Resistance Force: 341gr. Maximum

Contact Separation Force: 20gr. Minimum

### Finishes:

Contact Plating ( look Order Code)

Shell Plating ( look order code)

### Dimensions (mm)

#### Male Contact

Pos.	9	15	25	37
Dim.A	30,80	39,20	53,05	69,40
Dim.B	25,00	33,30	47,05	63,50
Dim.C	16,90	25,25	38,95	55,40

#### Female Contact

Pos.	9	15	25	37
Dim.A	30,80	39,20	53,05	69,40
Dim.B	25,00	33,30	47,05	63,50
Dim.C	16,30	24,60	38,35	54,80

### P.C.B. Layout

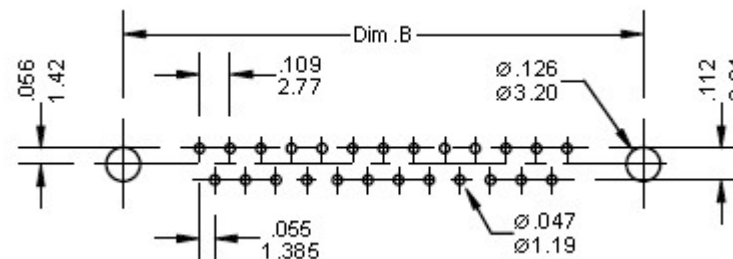

**D-Sub Connector Right Angle  
USA Norm 8,08mm**

Part No.: **T24E400**

DRW:	Jason	CHKD	Wilson	MATL:	Wilson	TOLERANCE	Mason	DATE	10.03.2023	Customer:
APPD:	Schumi			FINISH	Jamy		Sheet No.	1 from 4		

[www.edcon-components.com](http://www.edcon-components.com)

email: [info@edcon-components.com](mailto:info@edcon-components.com)

# EDCON-COMPONENTS



**Female Contact**

**Male Contact**

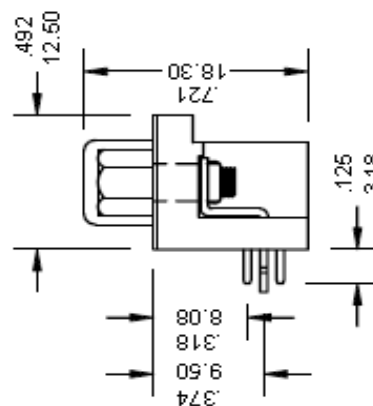
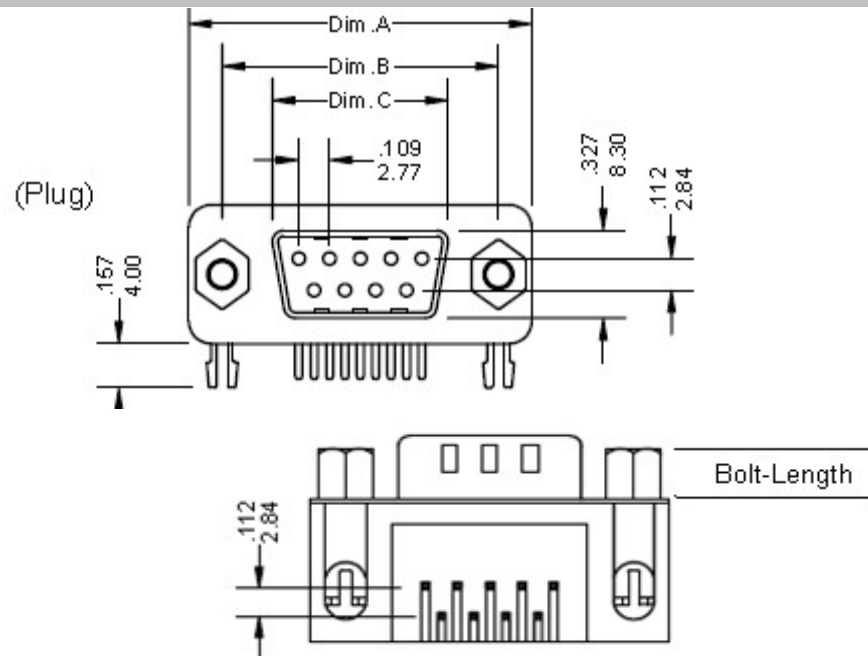
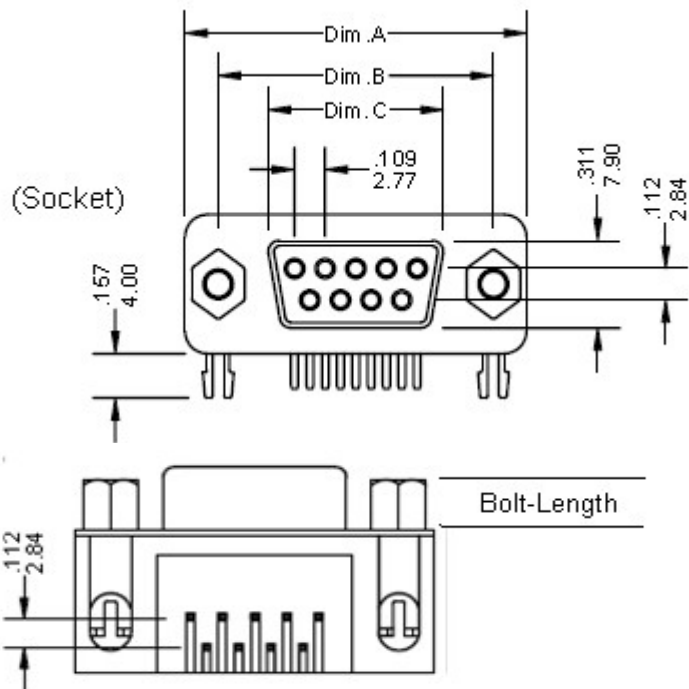

<b>D-Sub Connector Right Angle USA Norm 8,08mm</b>	
Part No.:	<b>T24E400</b>
Customer:	

DRW:	Jason	CHKD	Wilson	MATL:	Wilson	TOLERANCE	Mason	DATE	10.03.2023
APPD:	Schumi			FINISH	Jamy		Sheet No.	2 from 4	

# EDCON-COMPONENTS



## Ordering Informations

Serie	No. of contacts.	Contact Type	Shell Finish	Mounting Options	Bolt Length	No function	Contact Plating	Body Color	ROHS	Packing
-------	------------------	--------------	--------------	------------------	-------------	-------------	-----------------	------------	------	---------

<b>T24E400</b>	<b>09</b>	<b>F</b>	<b>T</b>	<b>B</b>	<b>0</b>	<b>A</b>	<b>SF</b>	<b>BK</b>	<b>R</b>	<b>TY</b>
----------------	-----------	----------	----------	----------	----------	----------	-----------	-----------	----------	-----------

<b>09=</b> Contacts	<b>F=</b> Female	<b>N=</b> Nickel	<b>A=</b> w. Boardlock Z-Shape	<b>0=</b> Bolt Length 4,8mm	<b>A=</b> w/o UNC 4-40 screw	<b>GF=</b> Gold Flash	<b>BK=</b> Black	<b>R=</b> ROHS Conform	<b>TY=</b> Tray Packing
<b>09, 15, 25, 37</b> Contacts	<b>M=</b> Male	<b>T=</b> Tin	<b>B=</b> Rivet w. Boardlock Z-Shape	<b>1=</b> Bolt Length 5,8mm	<b>B=</b> added UNC 4-40 screw	<b>GA=</b> 10µ Gold	<b>WH=</b> White	<b>N=</b> NON ROHS Conform	<b>BU=</b> Bulk-Ware
			<b>C=</b> Rivet only	<b>2=</b> w/o Bolt	<b>C=</b> w. fixed UNC 4-40 screw	<b>GB=</b> 15µ Gold	<b>BL=</b> Blue		
			<b>D=</b> Non Thread L-Shape			<b>GC=</b> 30µ Gold	<b>GY=</b> Gray		
			<b>E=</b> Rivet with non Thread L-Shape			<b>GD=</b> 50µ Gold			
			<b>F=</b> Rivet w. 4-40 Thread L-Shape	<b>H=</b> 4 Prong Boardlock		<b>SF=</b> Selective Gold flash			
			<b>G=</b> Rivet w. M3 Thread L-Shape	<b>J=</b> Rivet w. 4 Prong Boardlock		<b>SA=</b> 5µ Selective Gold flash			
						<b>SB=</b> 10µ Selective Gold flash			
						<b>SC=</b> 15µ Selective Gold flash			
						<b>SD=</b> 30µ Selective Gold flash			

<b>D-Sub Connector Right Angle USA Norm 8,08mm</b>	
Part No.:	<b>T24E400</b>

DRW:	Jason	CHKD	Wilson	MATL:	Wilson	TOLERANCE	Mason	DATE	10.03.2023
APPD:	Schumi			FINISH	Jamy			Sheet No.	3 from 4

Customer:  
email: [info@edcon-components.com](mailto:info@edcon-components.com)

[www.edcon-components.com](http://www.edcon-components.com)



Soldering Profile Curve

Classification Reflow Profile (JEDEC J-STD-020C)

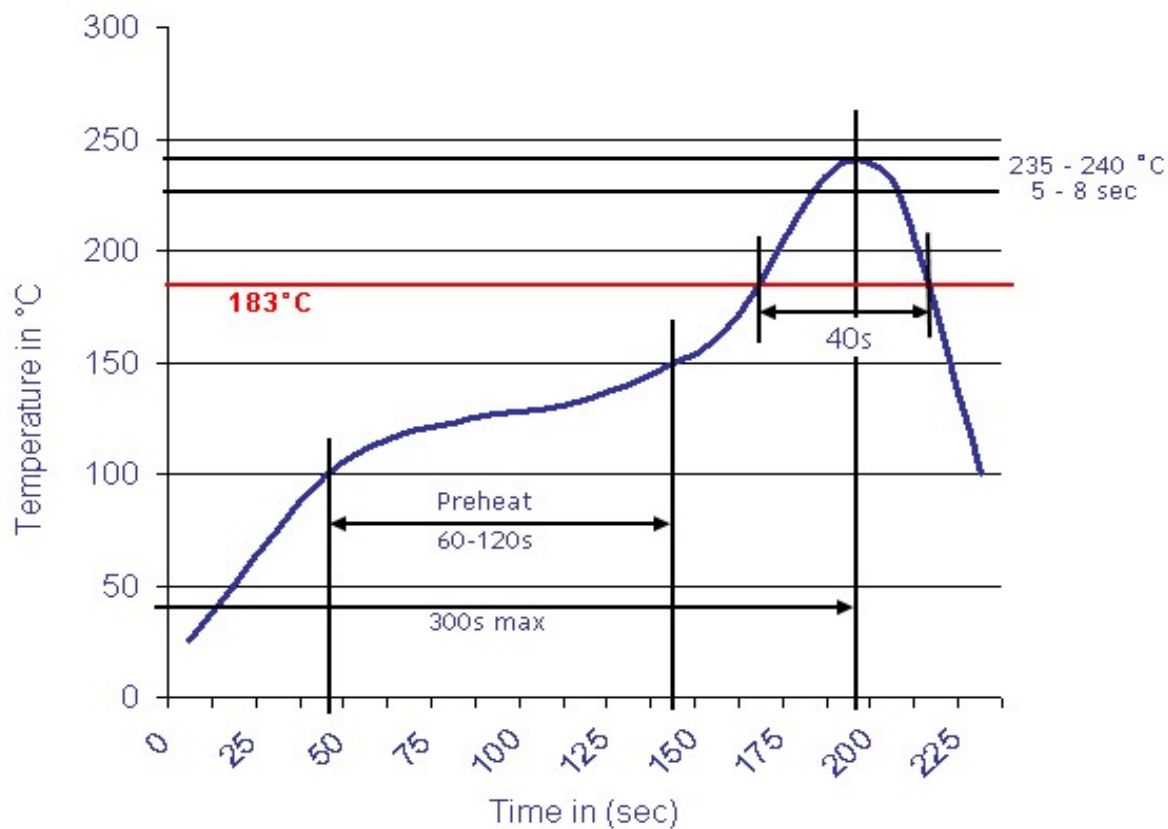

<b>D-Sub Connector Right Angle USA Norm 8,08mm</b>	
Part No.:	<b>T24E400</b>
Customer:	

DRW:	Jason	CHKD:	Wilson	MATL:	Wilson	TOLERANCE:	Mason	DATE:	10.03.2023
APPD:	Schumi			FINISH:	Jamy		Sheet No.		4 from 4