

EDCON-COMPONENTS



Technical Discription

Drawing

Material: PC (UL)
 Flame Class Class 94V-2
 Color Clear

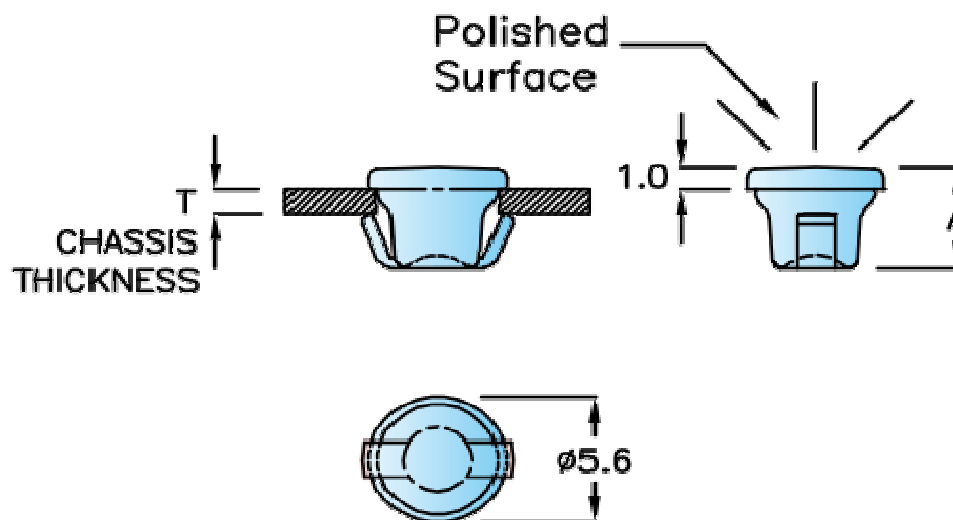

Dimension (mm)

A	4,5	Order Code Type 1
	5,0	Hole in Chassis
	1,0	Chassis Thickness
A	4,9	Order Code Type 2
	5,0	Hole in Chassis
	1,2	Chassis Thickness
A	3,8	Order Code Type 3
	5,0	Hole in Chassis
	0,8	Chassis Thickness

LED CAP

Part No.: **N24020**

Customer:

DRW:	Jason	CHKD	Wilson	MATL:	Wilson	TOLERANCE	Mason	DATE	27.05.2014
APPD:	Schumi			FINISH	Jamy		Sheet No.	1 from 2	

www.edcon-components.com

email: info@edcon-components.com

EDCON-COMPONENTS



Ordering Informations

Serie	Order Code	Spezial Function	ROHS	Packing						
-------	------------	---------------------	------	---------	--	--	--	--	--	--

N24020	-	1	0	R	BU					
---------------	---	----------	----------	----------	-----------	--	--	--	--	--

1 = Type 1	0 = No function	R = ROHS Conform	BU = Bulk- Ware
2 = Type 2			IV = Individual Package
3 = Type 3			

LED CAP
Part No.: N24020
Customer:

DRW:	Jason	CHKD	Wilson	MATL:	Wilson	TOLERANCE	Mason	DATE	27.05.2014
APPD:	Schumi			FINISH	Jamy		Sheet No.	2 from 2	