

EDCON-COMPONENTS



Technical Discription

Material: PC (UL)
 Flame Class: Class 94V-2
 Color: Clear

Drawing

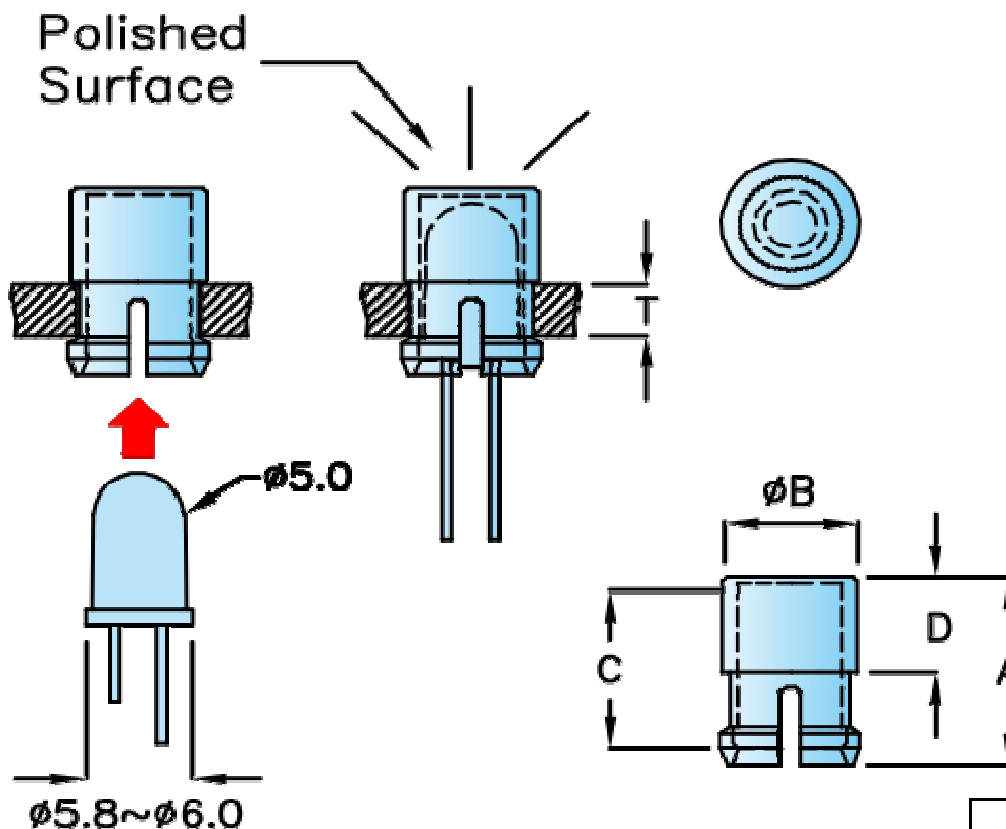

Dimension (mm)		
A	10,9	
B	7,2	
C	9,1	
D	5,4	
	6,4	Hole in Chassis
	3,2	Thickness Chassis
	5,0	Suitable Lamp

LED CAP	
Part No.:	N24014
Customer:	

DRW:	Jason	CHKD	Wilson	MATL:	Wilson	TOLERANCE	Mason	DATE	27.05.2014
APPD:	Schumi			FINISH	Jamy		Sheet No.		1 from 2

EDCON-COMPONENTS



Ordering Informations

Serie	Spezial Function	Spezial Function	ROHS	Packing						
-------	------------------	------------------	------	---------	--	--	--	--	--	--

N24014	-	0	0	R	BU					
---------------	---	----------	----------	----------	-----------	--	--	--	--	--

0 = No function	0 = No function	R = ROHS Conform	BU = Bulk-Ware
			IV = Individual Package

LED CAP
Part No.: N24014
Customer:

DRW:	Jason	CHKD	Wilson	MATL:	Wilson	TOLERANCE	Mason	DATE	27.05.2014
APPD:	Schumi			FINISH	Jamy		Sheet No.		2 from 2