

Data Sheet

Pluggable Terminal Block

Pitch: 7,50 mm

Serie: A14Q009

Customer Information for special Item

EDCON Customer : 0

Customer Version No. : 0

EDCON-COMPONENTS

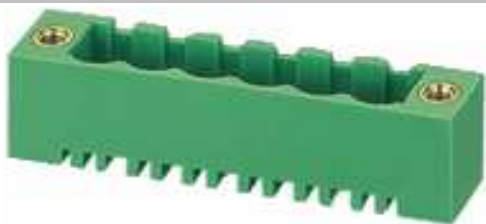

Technical Discription

Drawing (Dimension in mm)

Electrical

Standard	UL	IEC
Rated voltage	300V	320V, 400V
Rated current	15A	20A
Withstanding voltage	AC 2500V/1min	

Mechanical

Ambient temperature	-40°C ~ +105°C
---------------------	----------------

Dimensions

Pitch	7.50mm
Poles	2P - 22P 2P - 12P

Material

Housing	PA66 (UL94V-0)
Pin header	Brass, Tin plated

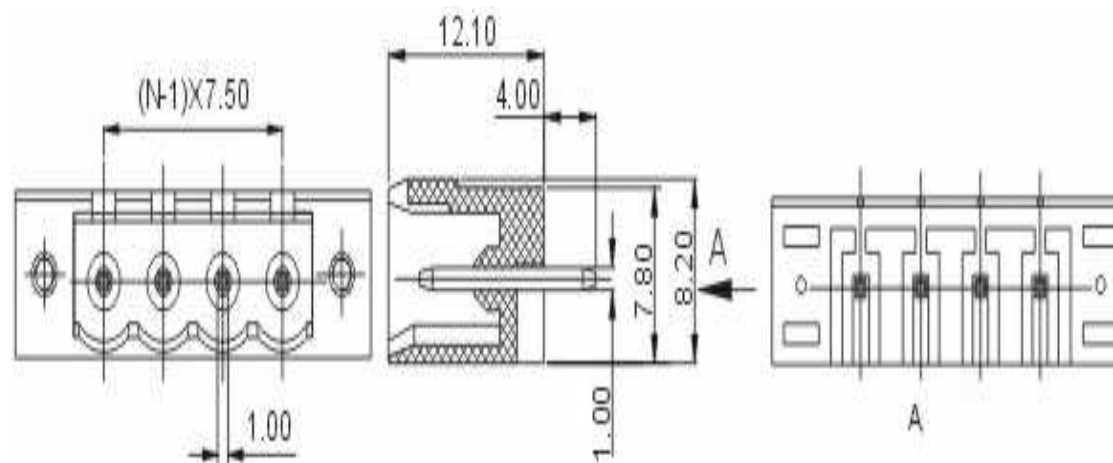

Pluggable Terminal Block

Part No.: **A14Q009**

Customer:

DRW:	Jason	CHKD	Wilson	MATL:	Wilson	TOLERANCE	Mason	DATE	26.05.2014
APPD:	Schumi			FINISH	Jamy		Sheet No.	1 from 4	

EDCON-COMPONENTS

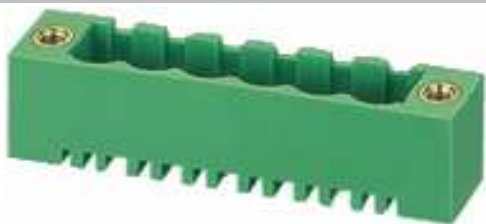

PCB Layout (Dimension in mm)

Dimensions (mm)

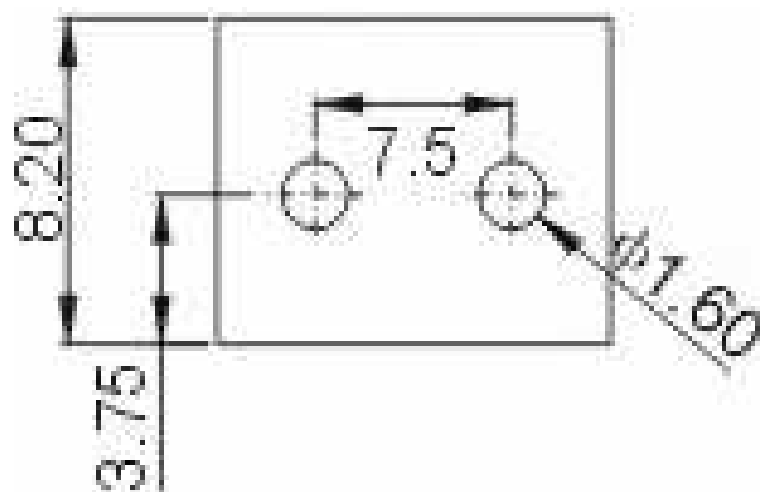

No. of Pos.	A	Tol. P
02	22,50	± 0,35
03	30,00	± 0,35
04	37,50	± 0,35
05	45,00	± 0,35
06	52,50	± 0,35
07	60,00	± 0,35
08	67,50	± 0,35
09	75,00	± 0,35
10	82,50	± 0,35
11	90,00	± 0,35
12	97,50	± 0,35
13	105,00	± 0,35
14	112,50	± 0,35
15	120,00	± 0,35
16	127,50	± 0,35
17	135,00	± 0,35
18	142,50	± 0,35
19	150,00	± 0,35
20	157,50	± 0,35
21	165,00	± 0,35
22	172,50	± 0,35

Pluggable Terminal Block

Part No.: **A14Q009**

DRW:	Jason	CHKD	Wilson	MATL:	Wilson	TOLERANCE	Mason	DATE	26.05.2014
APPD:	Schumi			FINISH	Jamy		Sheet No.	2 from 4	

Customer:

EDCON-COMPONENTS

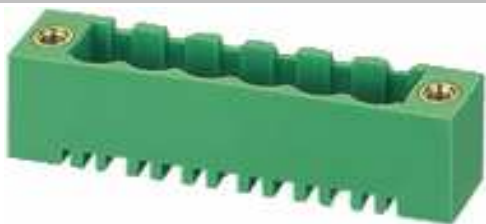

Ordering Informations

Serie	No. of Pos.	Body Color	Approval	Approval Code	ROHS	Packing	EDCON Cust. No.	Customer Version		
A14Q009	02	GN	N	N	R	B				

Pitch 7,50	02= Number of Pos. Standard 2 ~ 24Pos.	GY= Gray (Standard) GN= Green OR= Orange BK= Black	N= No Approval 1= Approval for Material 2= Approval for Terminal Block	N= NON Approval A= UL /UR Approval Please consult EDCON for available B= VDE Approval Please consult EDCON for available C= TÜV Approval Please consult EDCON for available	R= ROHS Conform N= NON ROHS Conform	B= Standard Package I= Individual Package	XXXXXX= Customer Number	XXX= Customer Version ??(Printing)
---------------	---	---	--	--	--	--	-------------------------	------------------------------------

Pluggable Terminal Block

Part No.: **A14Q009**

DRW:	Jason	CHKD	Wilson	MATL:	Wilson	TOLERANCE	Mason	DATE	26.05.2014
APPD:	Schumi			FINISH	Jamy		Sheet No.	3 from 4	

Customer:



Soldering Profile Curve

Classification Reflow Profile (JEDEC J-STD-020C)

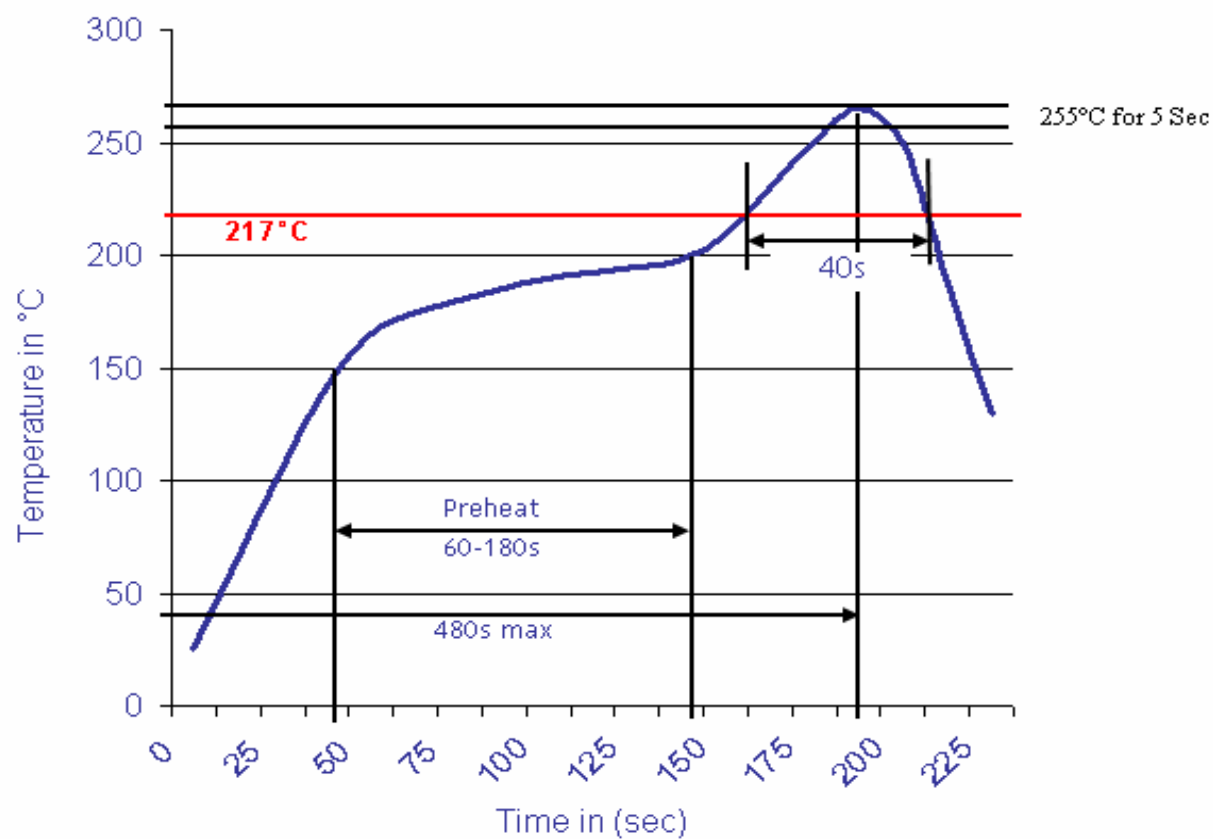

Pluggable Terminal Block

Part No.: **A14Q009**

Customer:

DRW:	Jason	CHKD	Wilson	MATL:	Wilson	TOLERANCE	Mason	DATE	26.05.2014
APPD:	Schumi			FINISH	Jamy		Sheet No.	4 from 4	