

# EDCON-COMPONENTS

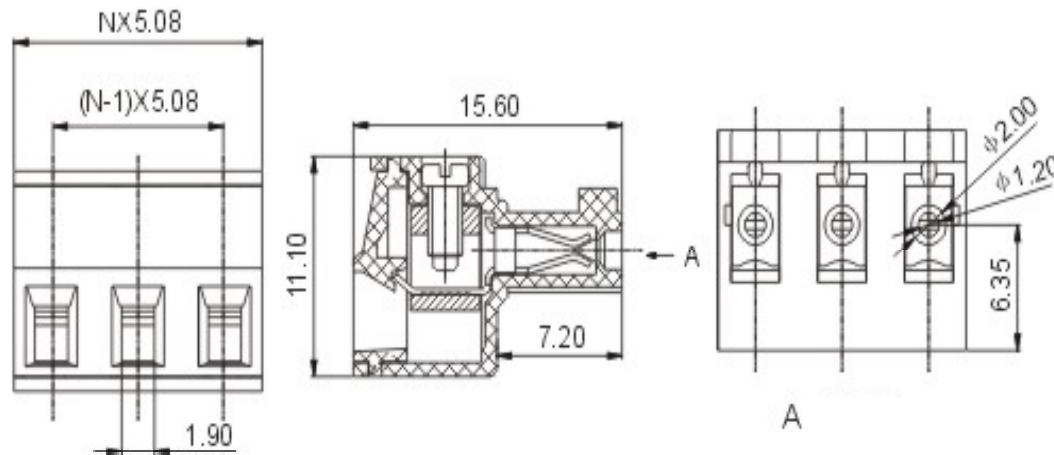

## Drawing



P.C.B. Layout

## Specification

### APPROVAL



#### Electrical

Standard  
Rated voltage  
Rated current  
Wire range  
Withstanding voltage

UL	IEC
300V	250V
8A	7A
28-16 AWG	0.5 - 1.5mm <sup>2</sup>
AC 2000V/1min	

#### Mechanical

Ambient temperature  
Strip length  
Screw, Torque

-40°C ~ +105°C  
7mm  
M2, 0.2Nm (1.7Lb-In.)

#### Dimensions

Pitch  
Poles

5.08mm  
2P - 12P

#### Material

Housing  
Contact  
Cage  
Terminal screw

PA66 (UL94V-0)  
Phosphor Bronze  
Brass, Ni plated  
steel, Cr<sup>3+</sup> Zn plated



### Certification

**Pluggable Terminal Block /  
Pitch 5.08mm**

Part No.: A14M046

Customer:

DRW:	Bill	CHKD	Lord	MATL:	Jimmy	TOLERANCE	Sam	DATE	13.03.2017
APPD:	Louis			FINISH	Georg		Sheet No.		1 from 3

# EDCON-COMPONENTS





## Ordering Informations

Serie

**A14M046**

No. of Pos.	Body Color	Screw Type	Approval Code	ROHS	Packing	EDCON Cust. No.	Customer Version		
-------------	------------	------------	---------------	------	---------	-----------------	------------------	--	--

<b>02</b>	<b>PG</b>	<b>A</b>	<b>N</b>	<b>R</b>	<b>B</b>				
-----------	-----------	----------	----------	----------	----------	--	--	--	--

<b>02=</b> Number of Standard 2 ~ 24Pos.	<b>PG=</b> Phoenix Green	<b>A=</b> Slotted Screw Type (Standard) 	<b>N=</b> NON Approval  <b>A=</b> UL /UR Approval Please consult EDCON for available	<b>R=</b> ROHS Conform  <b>N=</b> NON ROHS Conform	<b>B=</b> Bulk- Ware  <b>I=</b> Individual Package	<b>xxxxxx=</b> Customer Number	<b>xxx=</b> Customer Version ??(Printing)
	<b>WH=</b> White						
	<b>GN=</b> Green	<b>B=</b> Cross Slotted Screw Type 	<b>B=</b> VDE Approval Please consult EDCON for available				
	<b>GY=</b> Gray						
	<b>LG=</b> Light Gray	<b>C=</b> Screwless Type	<b>C=</b> TÜV Approval Please consult EDCON for available				
	<b>OR=</b> Orange						
	<b>BL=</b> Blue						
<b>BK=</b> Black							

**Pluggable Terminal Block /  
Pitch 5.08mm**

Part No.: A14M046

DRW:	Bill	CHKD	Lord	MATL:	Jimmy	TOLERANCE	Sam	DATE	13.03.2017
APPD:	Louis			FINISH	Georg			Sheet No.	2 from 3

Customer:

# EDCON-COMPONENTS



## Soldering - Profil

Classification Reflow Profile (JEDEC J-STD-020C)

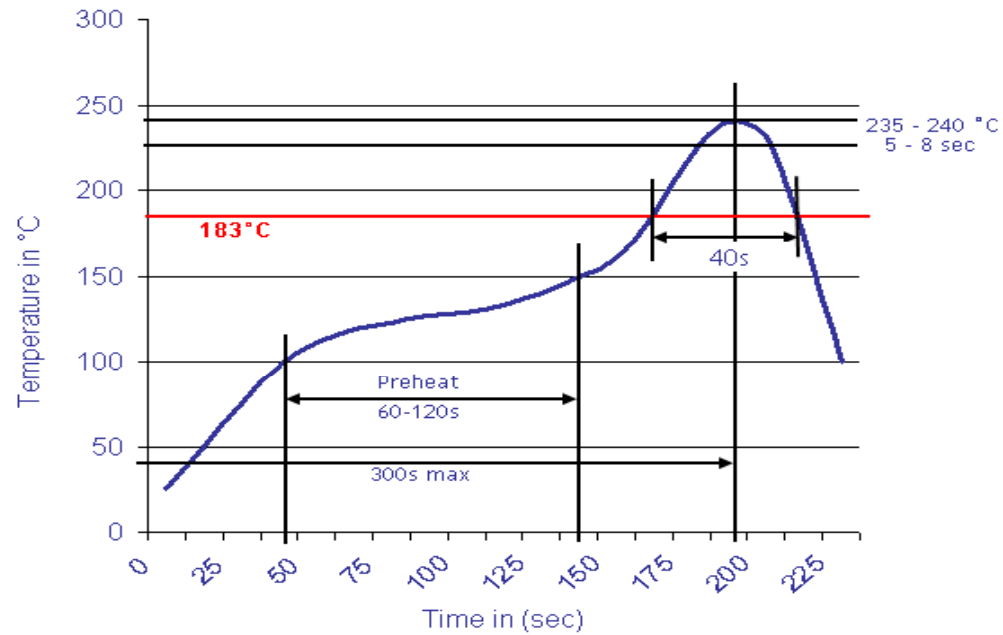

<b>Pluggable Terminal Block / Pitch 5.08mm</b>	
Part No.:	A14M046
Customer:	

DRW:	Bill	CHKD	Lord	MATL:	Jimmy	TOLERANCE	Sam	DATE	13.03.2017
APPD:	Louis			FINISH	Georg		Sheet No.	3 from 3	