

# EDCON-COMPONENTS



## Applications

The rectangular solid ferrites are used for EMI SUPPRESSION on flat cable assemblies

Internal floppy disk ribbon cables

Internal ribbon cables between circuit and data connectors

Internal ribbon cables between circuit and data connectors with

8,16,32 or 64bit digital signal busses

## General Informations

Storage Temperature -20°C to +60°C before assembly

Operating Temperature: - 25°C ~ to +125°C

Test conditions of electrical properties 20°C , 32% RH

## Dimensions

	mm	Tolerance (mm)
<b>A</b>	32,00	± 1,00
<b>B</b>	6,00	± 0,30
<b>C</b>	25,00	± 1,00
<b>D</b>	28,00	± 0,70
<b>E</b>	0,85	± 0,20

## Dimensions (mm)

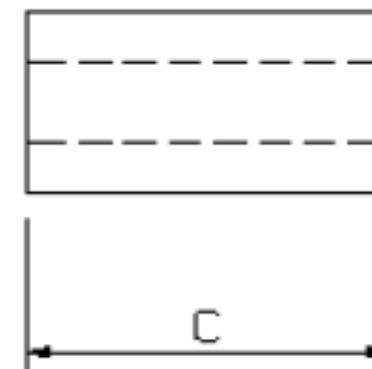
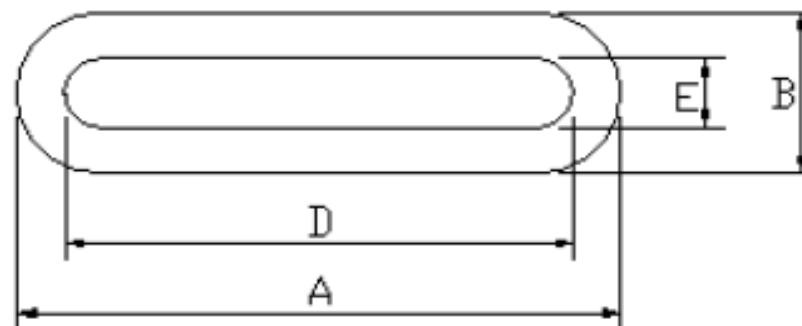

## Core Material specifications

Maerial code	Practical Frequency	Initial Permeability	Cure Temperature	Specific Gravity	Loss Factor @ MHz	x Temp Coef of initial Permeability
Unit	MHZ		°C	g/cm <sup>3</sup>	x10-6 Mhz	x10-6 /°C 20-70 °C
A5	0,1 - 1,0	1000 ±25%	130	4,8	280   1	.2 - 5
K5B	0,1 - 1,0	700 ±25%	140	4,8	250   1	0 - 7
K9D	0,5 - 20	55 ±25%	300	4,8	500   50	30 - 80

**Flat-cable Ferrit Core Type FS**

Part No.: **G29040**

DRW:	Jason	CHKD	Wilson	MATL:	Wilson	TOLERANCE	Mason	DATE	14.05.2014	Customer:
APPD:	Schumi			FINISH	Jamy		Sheet No.	1 from 2		



Impedance Characteristics

Material A5

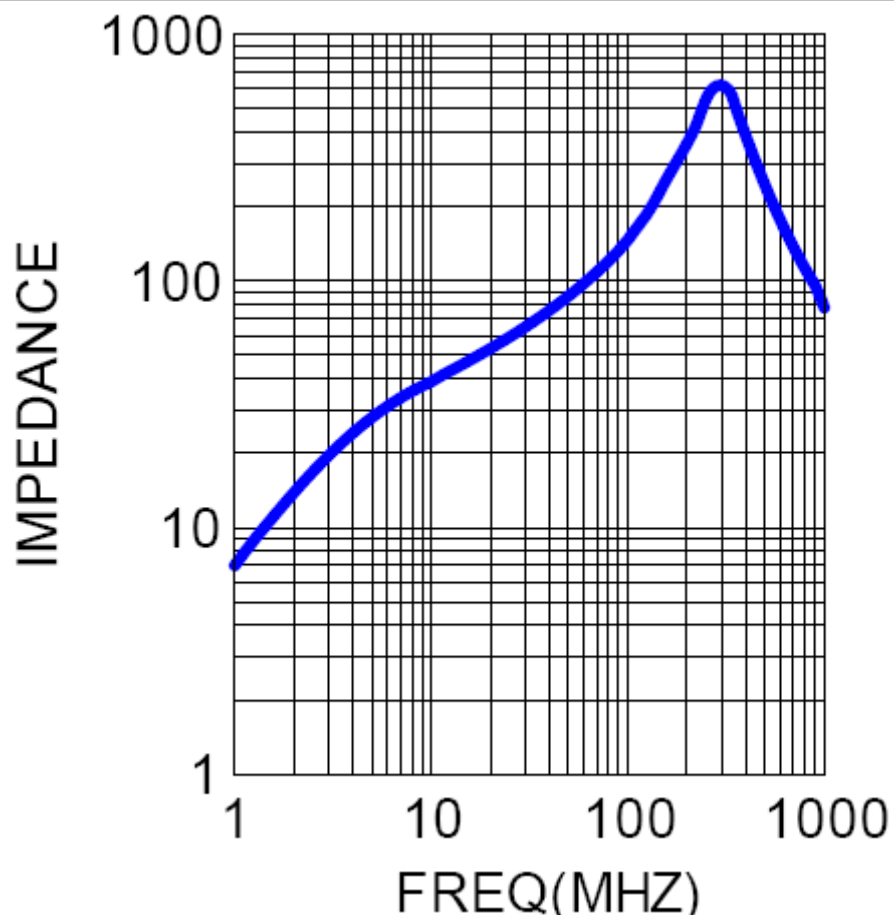

**Flat-cable Ferrit Core Type  
FS**

Part No.: **G29040**

Customer:

DRW:	Jason	CHKD	Wilson	MATL:	Wilson	TOLERANCE	Mason	DATE	14.05.2014
APPD:	Schumi			FINISH	Jamy		Sheet No.	2 from 3	

# EDCON-COMPONENTS



## Ordering Informations

Serie	Material	Special function	ROHS	Packing						
-------	----------	------------------	------	---------	--	--	--	--	--	--

<b>G29040</b>	-	<b>B</b>	<b>XX</b>	<b>R</b>	<b>TY</b>					
---------------	---	----------	-----------	----------	-----------	--	--	--	--	--

	<b>XX=</b> No special function	<b>R=</b> ROHS Conform	<b>TY=</b> Bulk - Ware into Polybag			
<b>B=</b> Material A5		<b>N=</b> NON ROHS Conform	<b>IV=</b> Individual Packing			

**Flat-cable Ferrit Core Type FS**

Part No.: **G29040**

DRW:	Jason	CHKD	Wilson	MATL:	Wilson	TOLERANCE	Mason	DATE	14.05.2014
APPD:	Schumi			FINISH	Jamy		Sheet No.		2 from 2

Customer: