

# EDCON-COMPONENTS

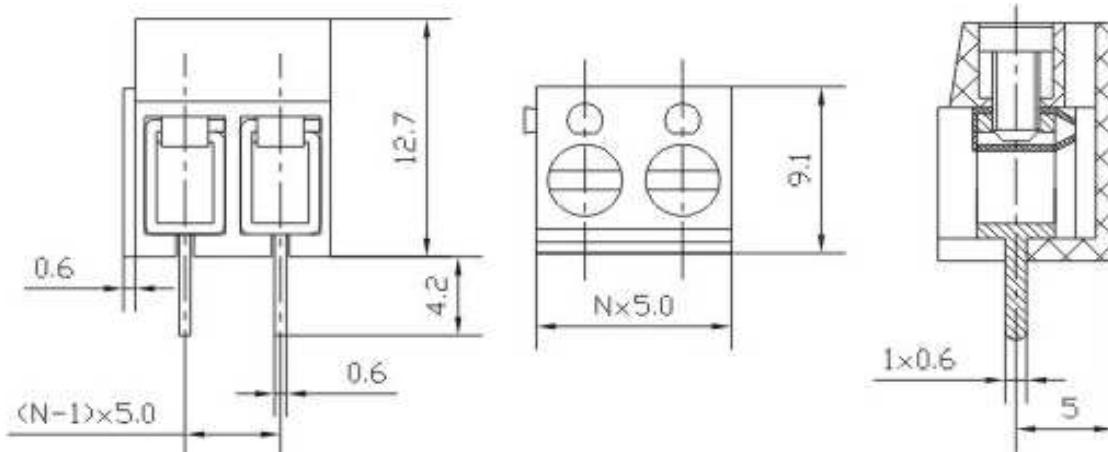

## Drawing



## P.C.B. Layout

## Specification

### Electrical

Rated voltage	300V
Rated current	16A
Wire range	22-14AWG / 1.5mm <sup>2</sup>
Contact resistance	20mΩ
Withstanding voltage	AC 1500V/1Min
Insulation resistance	5000MΩ/DC1000V

### Mechanical

Ambient temperature	-30°C ~ +120°C
Strip length	4,5 ~ 5mm
Screw, Torque	M2.5, 0.4Nm (3.6lb.in)

### Dimensions

Pitch	5.00mm
Poles	2P, 3P

### Material

Housing	PBT (UL94V-0)
Pin header	Brass, Tin-plated
Screw	steel, Zinc-plated
Wire guard	Stainless steel



Wire Protector Terminal Block /  
Pitch 5.00mm

Part No.: A12L032

DRW:	Bill	CHKD	Lord	MATL:	Jimmy	TOLERANCE	Sam	DATE	14.03.2009
APPD:	Louis			FINISH	Georg		Sheet No.		1 from 3

Customer:

[www.edcon-components.com](http://www.edcon-components.com)

email: [info@edcon-components.com](mailto:info@edcon-components.com)

# EDCON-COMPONENTS



## Ordering Informations

Serie	-	No. of Pole	Body-Color	wire protector	Screw	-	Customer Request
<b>A12L032</b>	-	<b>XX</b>	<b>XX</b>	<b>X</b>	<b>X</b>	-	<b>X</b>

XX = total	<b>WH</b> - white	<b>1</b> - with wire protector	<b>A</b> - Slotted screw (standard)
	<b>GN</b> - green	<b>2</b> - without wire protector	<b>B</b> - Cross-slotted screw
	<b>GR</b> - gray		
	<b>LG</b> - light gray		



<b>PG</b> - Phoenix Green
<b>OR</b> - orange
<b>BL</b> - blue
<b>BK</b> - black



wire protector

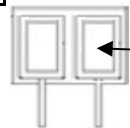

without wire protector



Wire Protector Terminal Block /  
Pitch 5.00mm

Part No.: A12L032

Customer:

DRW:	Bill	CHKD	Lord	MATL:	Jimmy	TOLERANCE	Sam	DATE	14.03.2009
APPD:	Louis			FINISH	Georg		Sheet No.		2 from 3

[www.edcon-components.com](http://www.edcon-components.com)

email: [info@edcon-components.com](mailto:info@edcon-components.com)



## Soldering - Profil

### Classification Reflow Profile (JEDEC J-STD-020C)

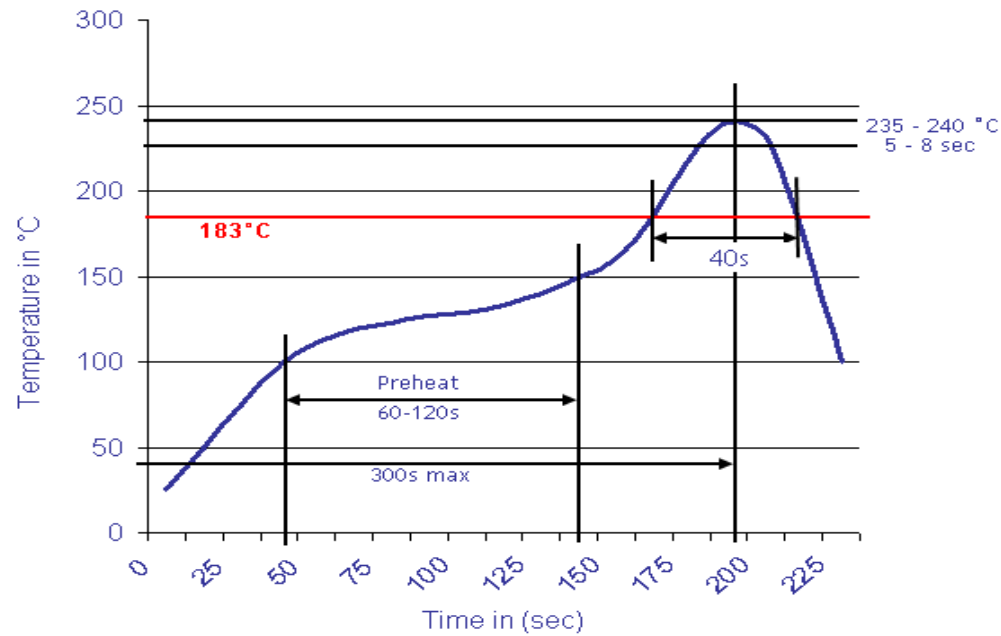

Wire Protector Terminal Block /  
Pitch 5.00mm

Part No.: A12L032

Customer:

DRW:	Bill	CHKD	Lord	MATL:	Jimmy	TOLERANCE	Sam	DATE	14.03.2009
APPD:	Louis			FINISH	Georg			Sheet No.	3 from 3