

EDCON-COMPONENTS

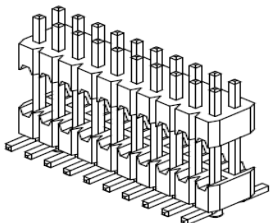

Specifications

Current Rating:	1 Ampere
Insulator Resistance:	5000 Megaohm min.
Dielectric Withstanding:	AC 500V
Operating Temperature:	.-40°C to +105°C
Contact Material:	Copper, Alloy
Insulator Material:	Polyester, UL 94V-0
Standard:	P.B.T.
Contact Plating:	Tin, Gold or Selective Plated
Standard:	Gold Flash Overall
Selectiv Plating:	Gold flash plated on contact area / tin plated on solder area
Max. Processing Temp.	230°C for 60 seconds

P.C.B Layout

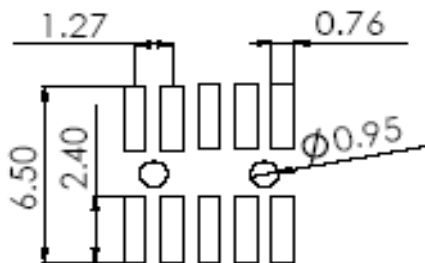

Drawing (dimensions all into mm)

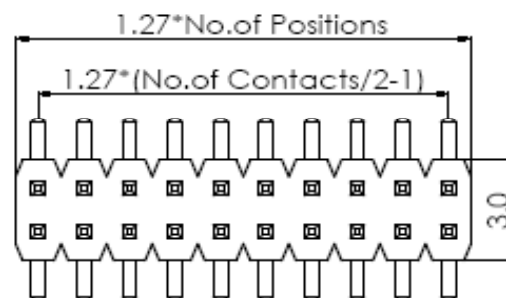
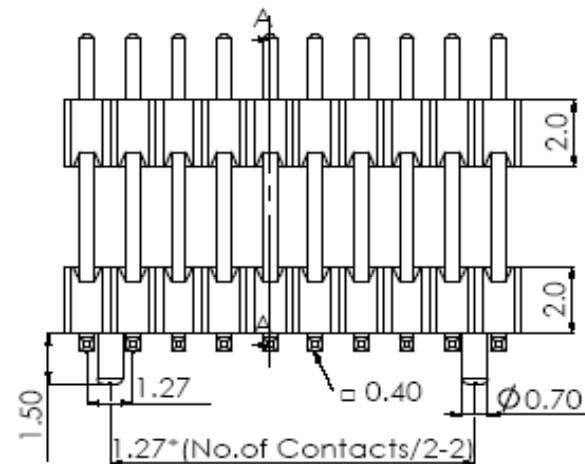
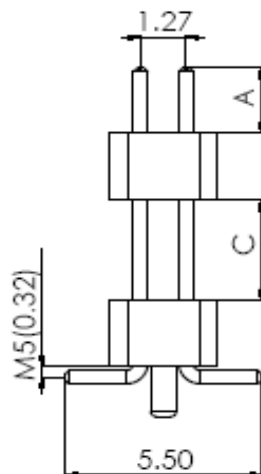

PIN Header / Dual Row / Dual Body / Pitch 1,27mm	
Part No.:	T51C1004 -
Customer:	

DRW:	Jason	CHKD	Wilson	MATL:	Wilson	TOLERANCE	Mason	DATE	27.05.2021
APPD:	Schumi			FINISH	Jamy		Sheet No.		1 from 4

EDCON-COMPONENTS

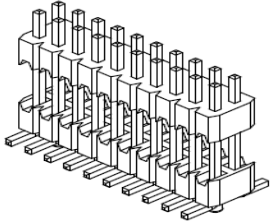

Pin Code length table free configuration

Order Code	Dimension (mm)			Order Code	Dimension (mm)			Order Code	Dimension (mm)			Order Code	Dimension (mm)		
	A	C	M5		A	C	M5		A	C	M5		A	C	M5
A01	2,00	3,00	0,32	A29	3,00	4,50	0,00	A57	4,00	8,00	0,00	A85			
A02	2,00	2,50	0,00	A30	3,00	5,00	0,00	A58	4,00	8,50	0,00	A86			
A03	2,00	2,00	0,00	A31	3,00	5,50	0,00	A59	4,00	9,00	0,00	A87			
A04	2,00	1,50	0,00	A32	3,00	6,00	0,00	A60	4,00	9,50	0,00	A88			
A05	2,00	1,00	0,00	A33	3,00	6,50	0,00	A61	4,00	10,00	0,00	A89			
A06	2,00	0,50	0,00	A34	3,00	7,00	0,00	A62	5,00	0,00	0,00	A90			
A07	2,00	3,50	0,00	A35	3,00	7,50	0,00	A63	5,00	0,50	0,00	A91			
A08	2,00	4,00	0,00	A36	3,00	8,00	0,00	A64	5,00	1,00	0,00	A92			
A09	2,00	4,50	0,00	A37	3,00	8,50	0,00	A65	5,00	1,50	0,00	A93			
A10	2,00	5,00	0,00	A38	3,00	9,00	0,00	A66	5,00	2,00	0,00	A94			
A11	2,00	5,50	0,00	A39	3,00	9,50	0,00	A67	5,00	2,50	0,00	A95			
A12	2,00	6,00	0,00	A40	3,00	10,00	0,00	A68	5,00	3,00	0,00	A96			
A13	2,00	6,50	0,00	A41	4,00	0,00	0,00	A69	5,00	3,50	0,00	A97			
A14	2,00	7,00	0,00	A42	4,00	0,50	0,00	A70	5,00	4,00	0,00	A98			
A15	2,00	7,50	0,00	A43	4,00	1,00	0,00	A71	5,00	4,50	0,00	A99			
A16	2,00	8,00	0,00	A44	4,00	1,50	0,00	A72	5,00	5,00	0,00	B01			
A17	2,00	8,50	0,00	A45	4,00	2,00	0,00	A73	5,00	5,50	0,00	B02			
A18	2,00	9,00	0,00	A46	4,00	2,50	0,00	A74	5,00	6,00	0,00	B03			
A19	2,00	9,50	0,00	A47	4,00	3,00	0,00	A75	5,00	6,50	0,00	B04			
A20	3,00	0,00	0,00	A48	4,00	3,50	0,00	A76	5,00	7,00	0,00	B05			
A21	3,00	0,50	0,00	A49	4,00	4,00	0,00	A77	5,00	7,50	0,00	B06			
A22	3,00	1,00	0,00	A50	4,00	4,50	0,00	A78	5,00	8,00	0,00	B07			
A23	3,00	1,50	0,00	A51	4,00	5,00	0,00	A79	5,00	8,50	0,00	B08			
A24	3,00	2,00	0,00	A52	4,00	5,50	0,00	A80	5,00	9,00	0,00	B09			
A25	3,00	2,50	0,00	A53	4,00	6,00	0,00	A81	5,00	9,50	0,00	PIN Header / Dual Row / Dual Body / Pitch 1,27mm			
A26	3,00	3,00	0,00	A54	4,00	6,50	0,00	A82	5,00	10,00	0,00				
A27	3,00	3,50	0,00	A55	4,00	7,00	0,00	A83	4,06	2,30	0,00	Part No.: T51C1004 -			
A28	3,00	4,00	0,00	A56	4,00	7,50	0,00	A84	??	??	??				
DRW:	Jason	CHKD	Wilson	MATL:	Wilson	TOLERANCE	Mason	DATE	27.05.2021	Customer:					
APPD:	Schumi			FINISH	Jamy			Sheet No.	2 from 4						

EDCON-COMPONENTS

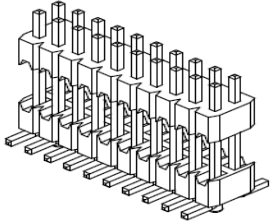

Ordering Informations

Serie	No. of Pos.	Construction	Contact Plating	Material	Polarisation Peg	Pin Length Code	ROHS	Packing		
T51C1004 -	XX	SS	G0	PB	N	A01	R	BU		

XX = total pin of header	SS = straight SMT	G0 = Gold Flash (Standard)	PB =P.B.T (Standard)	N = No	look table page 2	N =NO ROHS	BU = Bulk (Standard)
		T0 = Tin plated					
		GA = 10µ Gold Plating	NY = Nylon-6T	TC = Tube w. pic and Place Cap			
		GB = 15µ Gold Plating		TY = Tray packing w/o Cap			
		GC = 20µ Gold Plating		TR = Tape/Reel w. pic and Place Cap			
		S0 = Selectiv Plating Gold Flash / Tin					
		TN = Tin Plated					

PIN Header / Dual Row / Dual Body / Pitch 1,27mm
Part No.: T51C1004 -
Customer:

DRW:	Jason	CHKD	Wilson	MATL:	Wilson	TOLERANCE	Mason	DATE	27.05.2021
APPD:	Schumi			FINISH	Jamy		Sheet No.		3 from 4

www.edcon-components.com

email: info@edcon-components.com

EDCON-COMPONENTS

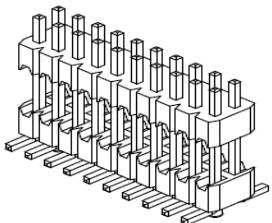

Soldering Profile for Lead Soldering (P.B.T.)

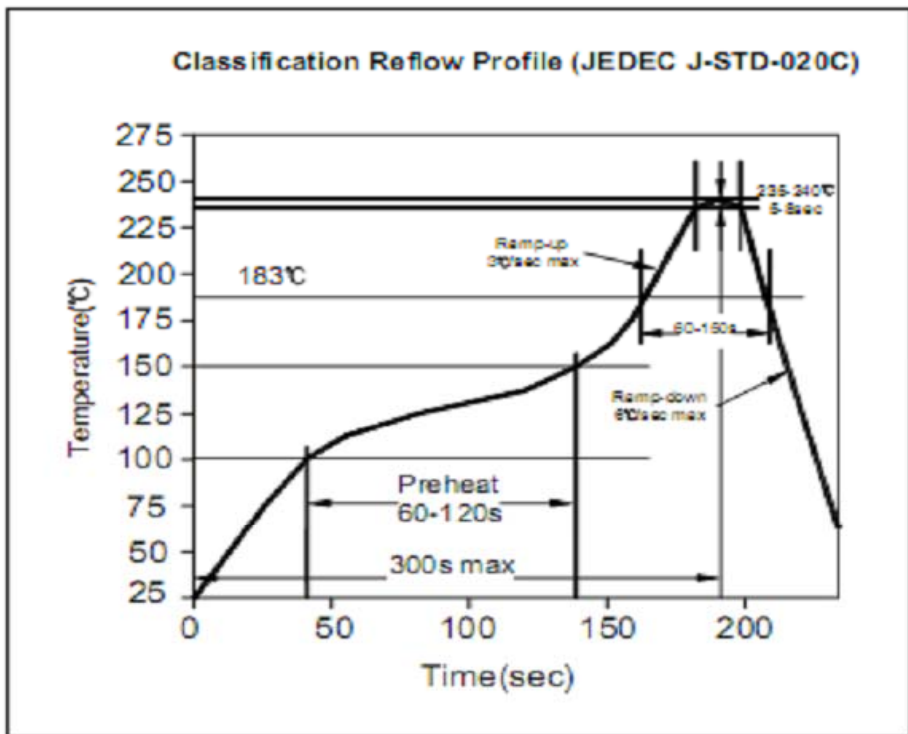

Soldering Profile for Lead Free Soldering (Nylon 6T)

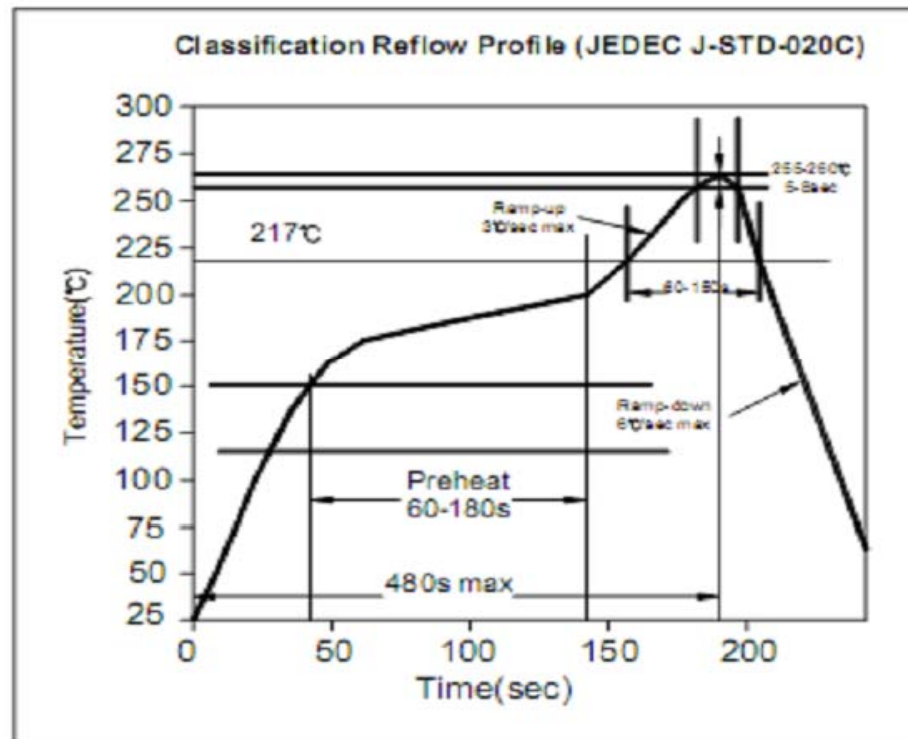

PIN Header / Dual Row / Dual Body / Pitch 1,27mm

Part No.: **T51C1004 -**

DRW:	Jason	CHKD	Wilson	MATL:	Wilson	TOLERANCE	Mason	DATE	27.05.2021
APPD:	Schumi			FINISH	Jamy		Sheet No.	4 from 4	Customer: