

# EDCON-COMPONENTS



## Specifications

### Features

Contact Positions: 9~37  
Stamped Contact

### Materials

Contact Brass and Phosphor Bronze  
Housing: PBT +30% Glass Fiber (UL 94V-0)  
Shell: cold roller steel

### Electrical Characteristics

Current Rating: 2,5Ampere  
Withstanding Voltage: AC 1000V r.m.s.  
Insulation Resistance: 3000 Megaohms Minimum at DC500V  
Contact Resistance: 15 Milliohm Maximum  
Operation Temperature: -55°C ~ +105°C

### Mechanical Characteristics:

Contact Resistance Force: 341gr. Maximum  
Contact Separation Force: 20gr. Minimum

### Finishes:

Contact Plating ( look Order Code)  
Shell Plating ( look order code)

## Dimensions (mm)

Positions	A	B	C	E
9	30,81	24,99	16,92	11,08
15	39,20	33,30	25,25	19,39
25	53,05	47,04	38,96	33,24
37	69,40	63,50	55,42	49,86

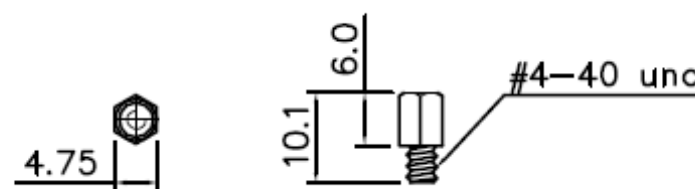

**D-Sub Connector Straight with rear side plastic body**

Part No.: **T24F400**

Customer:

DRW:	Jason	CHKD	Wilson	MATL:	Wilson	TOLERANCE	Mason	DATE	28.02.2012
APPD:	Schumi			FINISH	Jamy		Sheet No.		1 from 4

[www.edcon-components.com](http://www.edcon-components.com)

email: [info@edcon-components.com](mailto:info@edcon-components.com)

# EDCON-COMPONENTS



## Male Contact

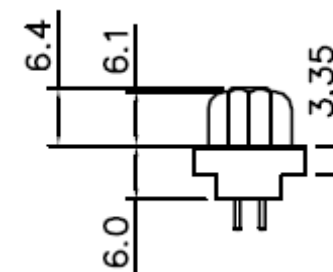
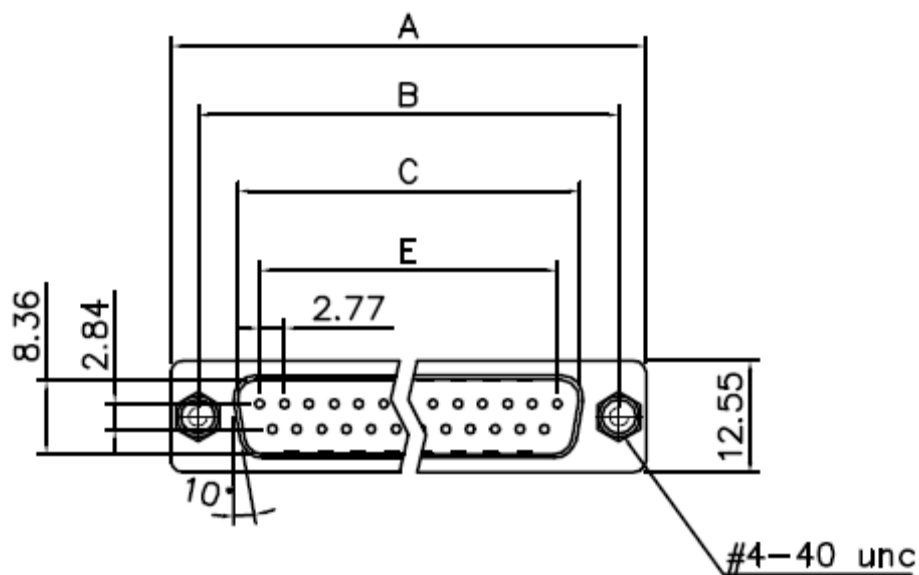

P.C.B. Layout

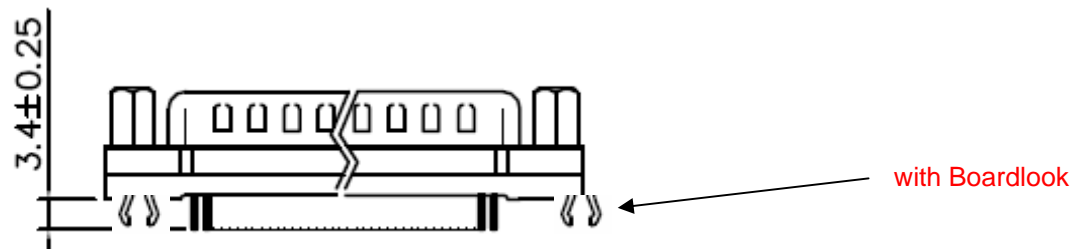
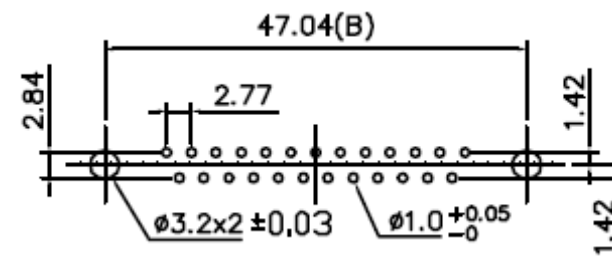

D-Sub Connector Straight with rear side plastic body

Part No.: T24F400

DRW:	Jason	CHKD	Wilson	MATL:	Wilson	TOLERANCE	Mason	DATE	28.02.2012	Customer:
APPD:	Schumi			FINISH	Jamy		Sheet No.	2 from 4		

# EDCON-COMPONENTS



## Ordering Informations

Serie	No. of contacts.	Contact Type	Shell Finish	PCB Options	Screw	Options 1	Contact Plating	Plastic Color	ROHS	Packing
<b>T24F400</b>	<b>09</b>	<b>M</b>	<b>T</b>	<b>B</b>	<b>1</b>	<b>0</b>	<b>GF</b>	<b>BK</b>	<b>R</b>	<b>TY</b>

<b>09~25=</b> Contacts	<b>M=</b> Male	<b>T=</b> Tin	<b>B=</b> Thread Insert UNC- 40	<b>1=</b> without mounting screw	<b>1=</b> Boardlook	<b>GF=</b> Gold Flash	<b>BK=</b> Black	<b>R=</b> ROHS Conform <b>N=</b> NON ROHS Conform	<b>TY=</b> Tray Packing <b>BU=</b> Bulk- Ware
				<b>2=</b> Mounted screw		<b>SF=</b> Selective Gold flash			
				<b>3=</b> added screw separetly		<b>SA=</b> 5µ Selective Gold flash			
					<b>SB=</b> 10µ Selective Gold flash				
					<b>SC=</b> 15µ Selective Gold flash				
						<b>SD=</b> 30µ Selective Gold flash			

**D-Sub Connector Straight with rear side plastic body**

Part No.: **T24F400**

DRW:	Jason	CHKD	Wilson	MATL:	Wilson	TOLERANCE	Mason	DATE	28.02.2012	Customer:
APPD:	Schumi			FINISH	Jamy		Sheet No.	3 from 4		



Soldering Profile Curve

Classification Reflow Profile (JEDEC J-STD-020C)



**D-Sub Connector Straight with rear side plastic body**

Part No.: **T24F400**

DRW:	Jason	CHKD	Wilson	MATL:	Wilson	TOLERANCE	Mason	DATE	28.02.2012
APPD:	Schumi			FINISH	Jamy		Sheet No.	4 from 4	

Customer: