

EDCON-COMPONENTS



Specifications

Features

Contact Positions: 09, 15, 25, 37
Press Fit Contact

Materials

Contact Brass and Phosphor Bronze
Housing: PBT +30% Glass Fiber (UL 94V-0)
Shell: cold roller steel

Electrical Characteristics

Current Rating: 2,5Ampere
Withstanding Voltage: AC 1000V r.m.s.
Insulation Resistance: 3000 Megaohms Minimum at DC500V
Contact Resistance: 15 Milliohm Maximum
Operation Temperature: -55°C ~ +105°C

Mechanical Characteristics:

Contact Resistance Force: 341gr. Maximum
Contact Separation Force: 20gr. Minimum

Finishes:

Contact Plating (look Order Code)
Shell Plating (look order code)

Dimensions (mm)

Male Contact

Pos.	9	15	25	37	
A	30,81	39,25	53,03	69,50	
B	24,99	33,32	47,04	63,50	
C	16,92	47,04	38,96	55,42	
D	18,61	63,50	55,42	57,30	

Female Contact

Pos.	9	15	25	37	
A	16,35	24,70	37,40	54,80	
B	24,99	33,32	47,04	63,50	
C	30,81	39,25	53,03	69,50	
D	18,61	27,15	40,93	57,40	

**D-Sub Connector Straight
PRESSFIT**

Part No.: **T24F200**

DRW:	Jason	CHKD	Wilson	MATL:	Wilson	TOLERANCE	Mason	DATE	10.04.2009	Customer:
APPD:	Schumi			FINISH	Jamy		Sheet No.	1 from 5		

www.edcon-components.com

email: info@edcon-components.com

EDCON-COMPONENTS



Male Contact

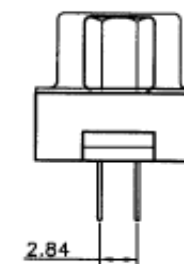
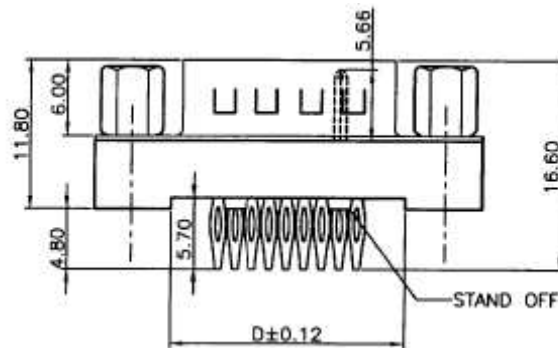
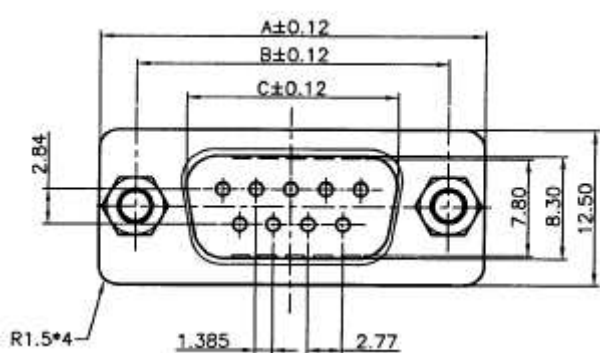

P.C.B. Layout

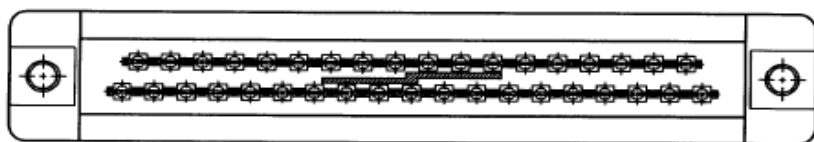

37P STAND OFF

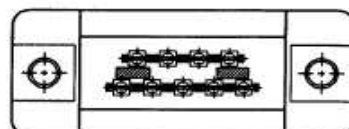

09P STAND OFF

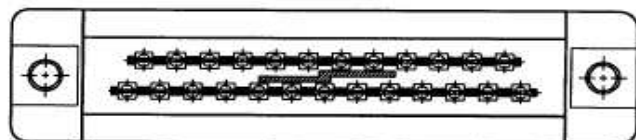

25P STAND OFF

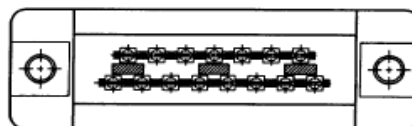

15P STAND OFF

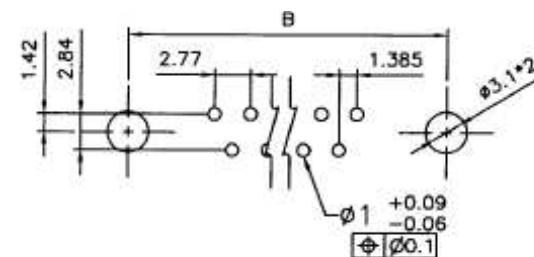

RECOMMENDED P.C.B. LAYOUT(TOP VIEW)
TOLERANCES: ±0.05mm

**D-Sub Connector Straight
PRESSFIT**

Part No.: **T24F200**

DRW:	Jason	CHKD	Wilson	MATL:	Wilson	TOLERANCE	Mason	DATE	10.04.2009	Customer:
APPD:	Schumi			FINISH	Jamy			Sheet No.	2 from 5	

www.edcon-components.com

email: info@edcon-components.com

EDCON-COMPONENTS



Femle Contact

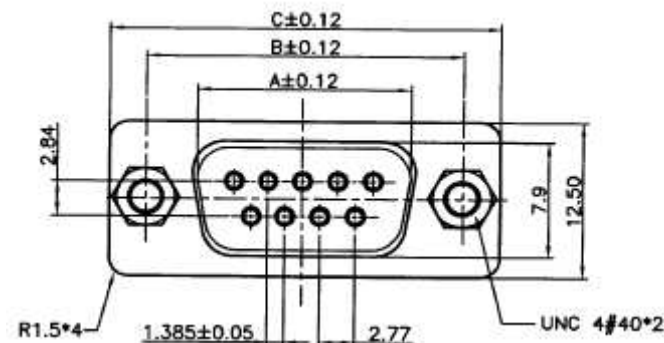
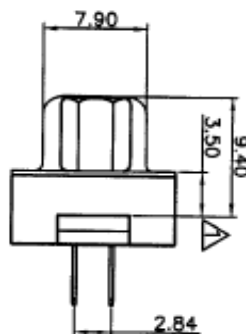
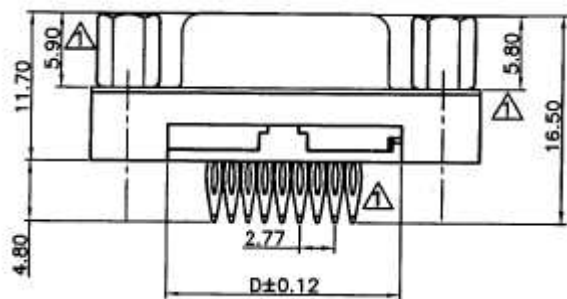

P.C.B. Layout

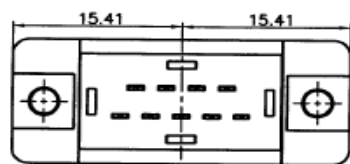

09P

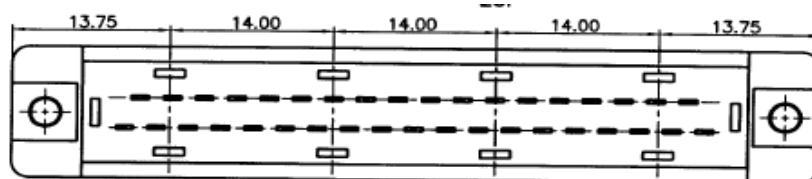

37P

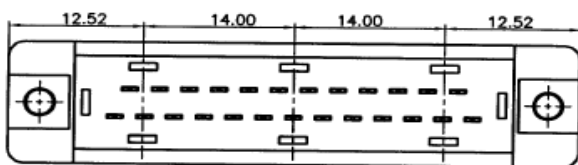

25P

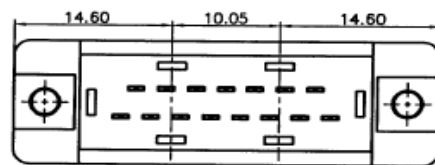

15P

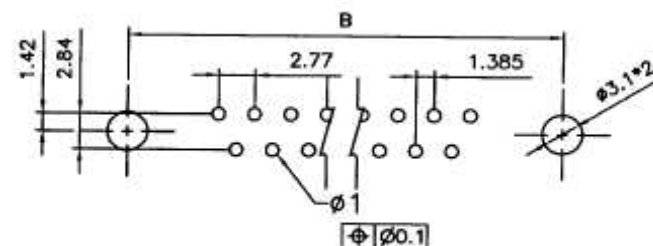

RECOMMENDED P.C.B LAYOUT (TOP VIEW)
TOLERANCES: ±0.05mm

**D-Sub Connector Straight
PRESSFIT**

Part No.: **T24F200**

Customer:

DRW:	Jason	CHKD	Wilson	MATL:	Wilson	TOLERANCE	Mason	DATE	10.04.2009
APPD:	Schumi			FINISH	Jamy		Sheet No.		3 from 5

EDCON-COMPONENTS



Ordering Informations

Serie	No. of contacts.	Contact Type	Shell Finish	PCB Options	Screw	Screw Type	Contact Plating	Plastic Color	ROHS	Packing
T24F200	09	M	T	B	1	A	SF	BK	R	TY

09= Contacts	M= Male	T= Tin	B= Rivet	1= without mounting screw	A= UNC4-40	SF= Selective Gold flash	BK= Black	R= ROHS Conform N= NON ROHS Conform	TY= Tray Packing
09 ~ 37 contacts	F= Female	N= Nickel		2= Mounted screw		SA= 5µ Selective Gold flash			BU= Bulk-Ware
				3= added screw separately		SB= 10µ Selective Gold flash SC= 15µ Selective Gold flash SD= 30µ Selective Gold flash			

D-Sub Connector Straight PRESSFIT	
Part No.:	T24F200
Customer:	

DRW:	Jason	CHKD	Wilson	MATL:	Wilson	TOLERANCE	Mason	DATE	10.04.2009
APPD:	Schumi			FINISH	Jamy		Sheet No.		4 from 5



Soldering Profile Curve

Classification Reflow Profile (JEDEC J-STD-020C)

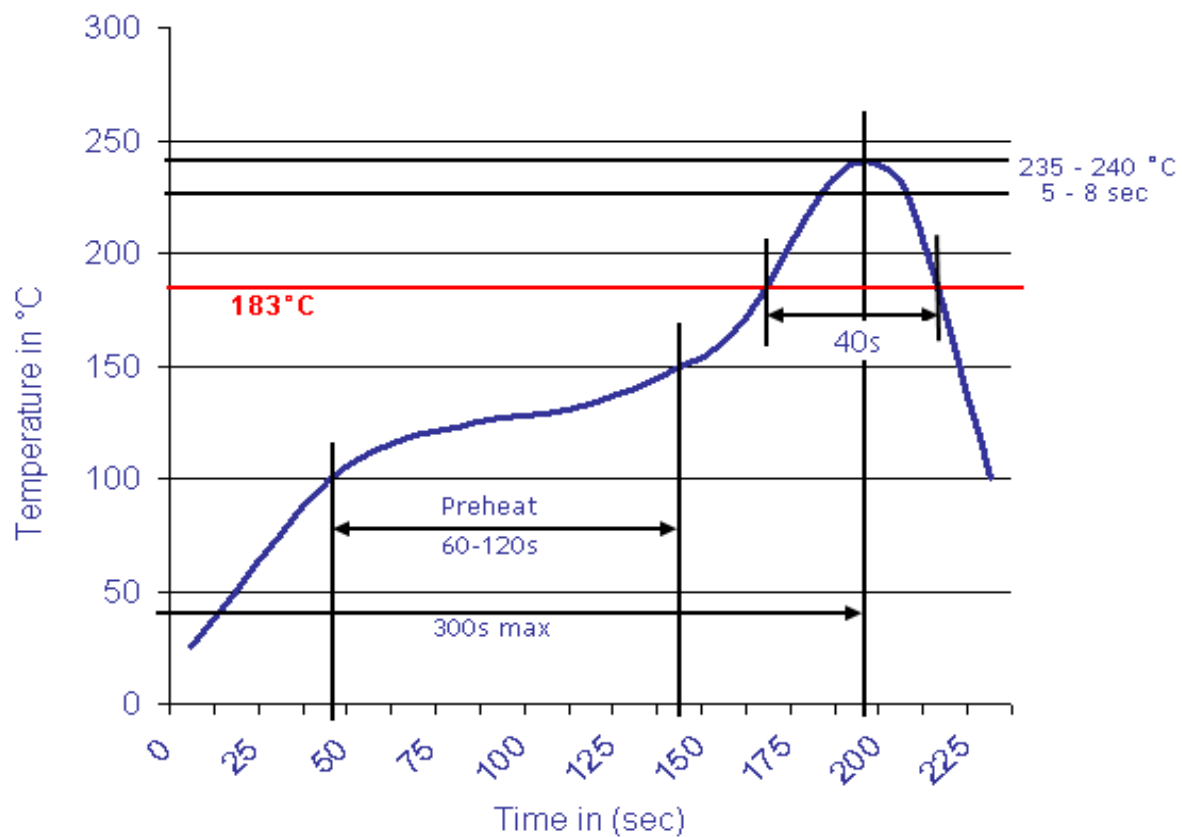

D-Sub Connector Straight PRESSFIT	
Part No.:	T24F200
Customer:	

DRW:	Jason	CHKD	Wilson	MATL:	Wilson	TOLERANCE	Mason	DATE	10.04.2009
APPD:	Schumi			FINISH	Jamy		Sheet No.	5 from 5	