

EDCON-COMPONENTS

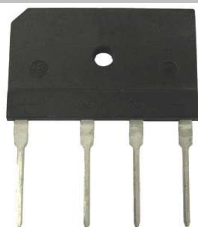

Specifications

Features

- Glass passivated die construction
- Plastic Material used carries UL flammability recognition 94V-0
- High surge current capability
- High case dielectric strength of 1500V rms

Mechanical Data

- CASE: Molded plastic body
- Terminals: plated leads solderable per MIL-STD-750, Method 2026
- Polarity: Polarity symbols marked on body
- Weight: 7gr.

Maximum Ratings & Electrical Characteristics Ratings at 25°C ambient temperature

| | Symbols | GBJ 8D | GBJ 8G | GBJ 8J | GBJ 8K | GBJ 8M | | Unit | |
|--|----------|-----------------|--------|--------|--------|-----------|-------|-----------|------------|
| Maximum reccurent peak reverse Voltage | VRRM | 200 | 400 | 600 | 800 | 1000 | | Volt | |
| Maximum rms Input voltage | VRMS | 140 | 280 | 420 | 560 | 700 | | Volt | |
| Maximum dc blocking Voltage | VDC | 200 | 400 | 600 | 800 | 1000 | | Volt | |
| Maximum average forward output rectified TA=50°C | I(AV) | 8,0 | | | | | | | Amps |
| Peak forward surge current 8,3ms single half sine-wave | IFSM | 180 | | | | | | | Amps |
| Rating for dusing (t<8,3ms) | I²t | 134 | | | | | | | A²sec |
| Maximum Thermal resistance per led (1) | RoJA | 26,0 | | | | | | °C/W | |
| | RoJC | 3,4 | | | | | | | |
| Operation Junction and storage temp.ran | Tj, Tstg | -55°C ~ + 150°C | | | | | | °C | |
| Maximum Instantaneous Forward Voltage per Leg | Vf | 1 | | | | | | lfm=4 | |
| Maximum DC reverse current at rated DC blocking voltage per leg | Ir | 5,0µA | | | | | | T=25°C | |
| | | 500µA | | | | | | T=125°C | |
| DRW: | Jason | CHKD | Wilson | MATL: | Wilson | TOLERANCE | Mason | DATE | 10.05.2010 |
| APPD: | Schumi | | | FINISH | Jamy | | | Sheet No. | 1 from 5 |

Technical Drawing (Unit: inch(mm))

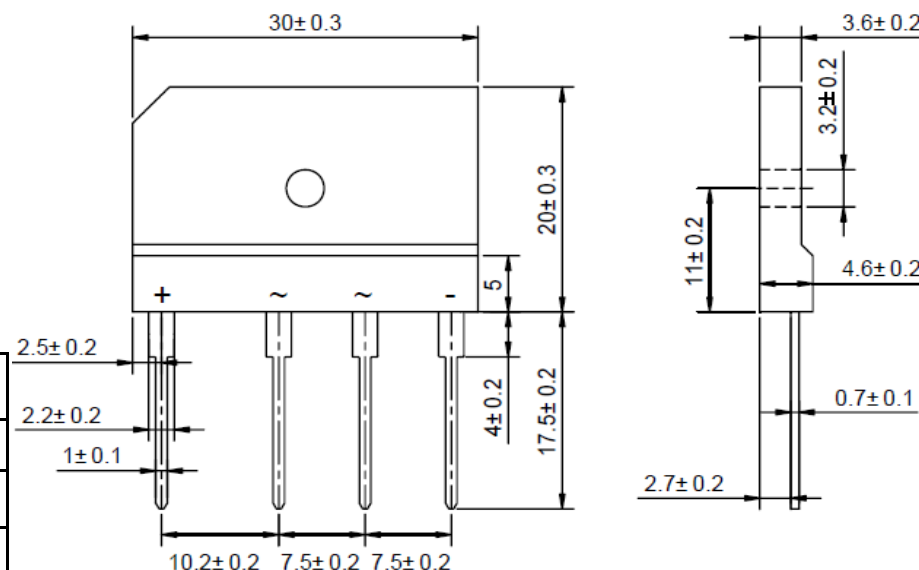

Note (1) Junction to ambient without heatsink (2) Junction to case with heatsink (3) Recommended mounting position is to bolt down on heatsink with silicone thermal compound for maximum heat transfer with M3 screw.

Single Inline Bridge Rectifier 8A (Glass Passivated)

EDCON-Ser. **E14020**

International Serie: **GBJ8x**

EDCON-COMPONENTS

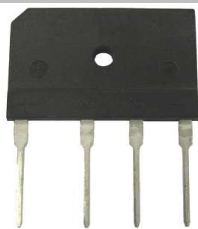

Rating & Characteristics Curves (TA=25°C unless otherwise noted)

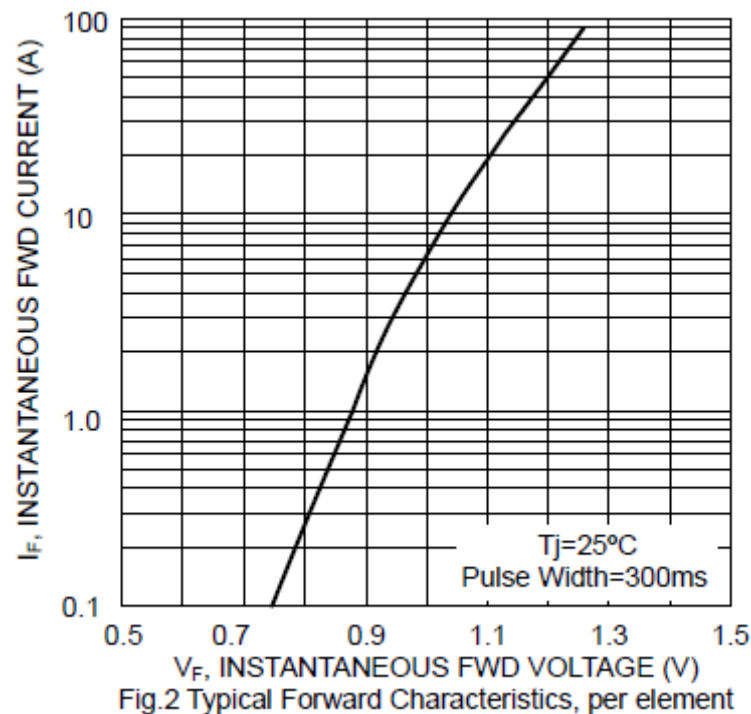
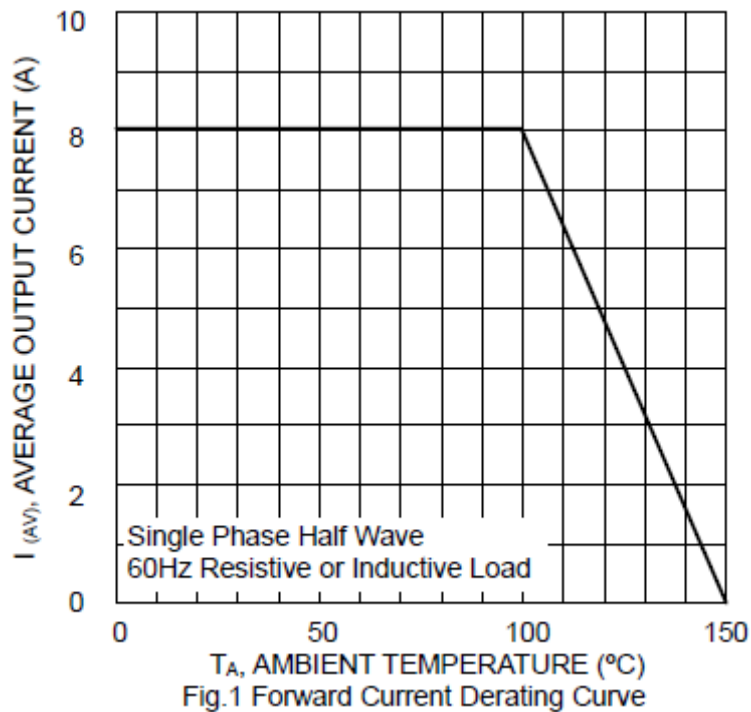

**Single Inline Bridge Rectifier 8A
(Glass Passivated)**

EDCON-Ser. **E14020**

International Serie: **GBJ8x**

| | | | | | | | | | |
|-------|--------|------|--------|--------|--------|-----------|-----------|----------|------------|
| DRW: | Jason | CHKD | Wilson | MATL: | Wilson | TOLERANCE | Mason | DATE | 10.05.2010 |
| APPD: | Schumi | | | FINISH | Jamy | | Sheet No. | 2 from 5 | |

EDCON-COMPONENTS



Rating & Characteristics Curves (TA=25°C unless otherwise noted)

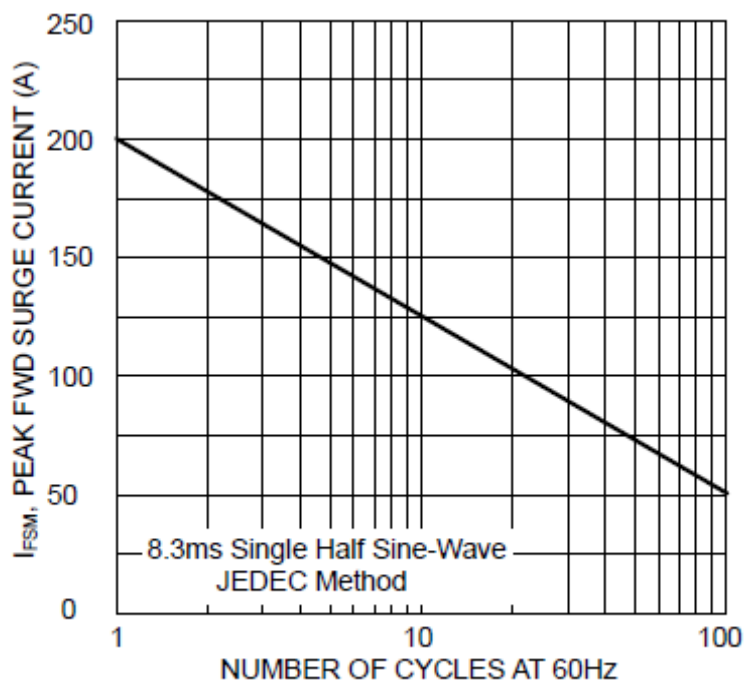

Fig.3 Max Non-Repetitive Peak Fwd Surge Current

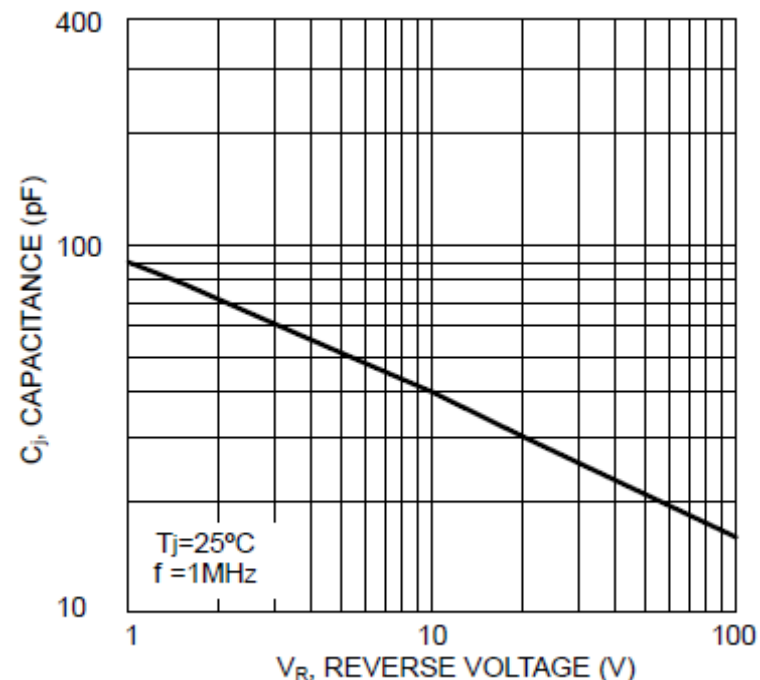

Fig.4 Typical Junction Capacitance Per Element

**Single Inline Bridge Rectifier 8A
(Glass Passivated)**

EDCON-Ser. **E14020**

International Serie: **GBJ8x**

| | | | | | | | | | |
|-------|--------|------|--------|--------|--------|-----------|-----------|----------|------------|
| DRW: | Jason | CHKD | Wilson | MATL: | Wilson | TOLERANCE | Mason | DATE | 10.05.2010 |
| APPD: | Schumi | | | FINISH | Jamy | | Sheet No. | 3 from 5 | |

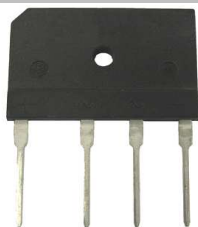

Rating & Characteristics Curves (TA=25°C unless otherwise noted)

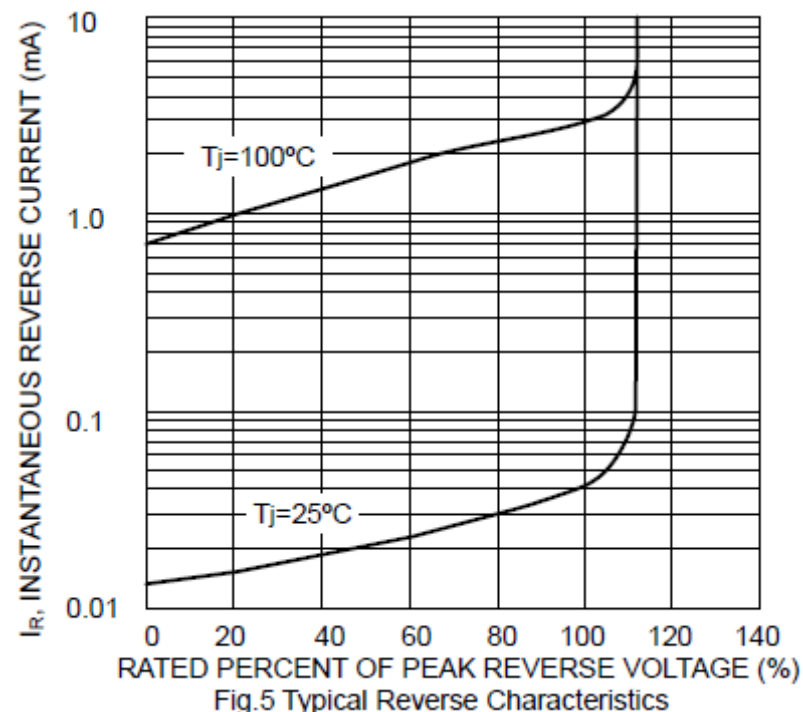

Ordering Informations

| | | | | |
|-------------|--------------------|---------------|------|---------|
| EDCON Serie | International Type | Lead function | ROHS | Package |
|-------------|--------------------|---------------|------|---------|

| | | | | |
|---------------|--------------|-----------|----------|-----------|
| E14020 | GBJ8x | LL | R | BX |
|---------------|--------------|-----------|----------|-----------|

| | | | |
|-------------------------|-----------------------------|-----------------------------|-------------------------|
| Look Voltage Code Table | LL = Long Lead | R = ROHS Conform | BX = Box Packing |
| | L4 = Lead Length 4mm | N = NON ROHS Conform | |

**Single Inline Bridge Rectifier 8A
(Glass Passivated)**

EDCON-Ser. **E14020**

International Serie: **GBJ8x**

| | | | | | | | | | |
|-------|--------|------|--------|--------|--------|-----------|-----------|------|------------|
| DRW: | Jason | CHKD | Wilson | MATL: | Wilson | TOLERANCE | Mason | DATE | 10.05.2010 |
| APPD: | Schumi | | | FINISH | Jamy | | Sheet No. | | 4 from 5 |

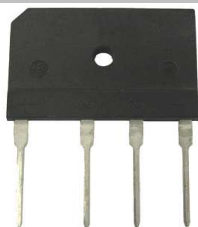

Soldering Profile Curve

Classification Reflow Profile (JEDEC J-STD-020C)



| | |
|---|---------------|
| Single Inline Bridge Rectifier 8A (Glass Passivated) | |
| EDCON-Ser. | E14020 |
| International Serie: | GBJ8x |

| | | | | | | | | | |
|-------|--------|------|--------|--------|--------|-----------|-----------|----------|------------|
| DRW: | Jason | CHKD | Wilson | MATL: | Wilson | TOLERANCE | Mason | DATE | 10.05.2010 |
| APPD: | Schumi | | | FINISH | Jamy | | Sheet No. | 5 from 5 | |