

# EDCON-COMPONENTS



## Specifications

Voltage Rating:	250V / 125V
Current Rating:	0,5A / 1,0A
Contact Material:	Silver plated
Wire Connecting:	Solder Lug Terminal
Housing:	Zinc Alloy
Finisch:	Bright Chrome plated ( Standard)
Mounting in Hole:	with Hex Nut
Switch function:	Off-On
Keys per Switch	Two
Hole size:	16,5mm

## Terminal Options

## Drawing ( dimensions all into mm)

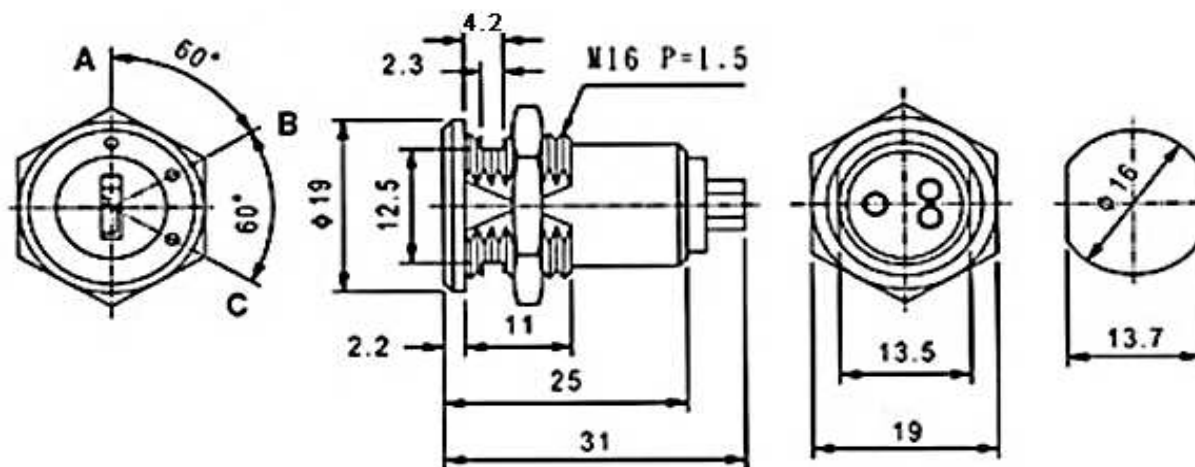

## KEYLOCK Switch

Part No.: **Q44019-**

Customer:

DRW:	Jason	CHKD	Wilson	MATL:	Wilson	TOLERANCE	Mason	DATE	25.07.2016
APPD:	Schumi			FINISH	Jamy		Sheet No.		1 from 2

[www.edcon-components.com](http://www.edcon-components.com)

email: [info@edcon-components.com](mailto:info@edcon-components.com)

# EDCON-COMPONENTS



## Ordering Informations

Serie	Switch function	different Keys	Terminal	Switch degree	Special function	ROHS	Packing			
-------	-----------------	----------------	----------	---------------	------------------	------	---------	--	--	--

<b>Q44019-</b>	<b>C</b>	<b>1</b>	<b>A</b>	<b>A</b>	<b>N</b>	<b>R</b>	<b>BU</b>			
----------------	----------	----------	----------	----------	----------	----------	-----------	--	--	--

	<b>1=</b> All Keys the same Code	<b>A=</b> Solder Lug Terminal	<b>A=</b> 60° switch pos. <b>B=</b> 120° switch pos.	<b>N=</b> No Special function	<b>R=</b> ROHS Conform <b>N=</b> NON ROHS Conform	<b>BU=</b> One Key in one Polybag			
	<b>2=</b> All Keys Different Code					<b>I=</b> Individual Packing			
	<b>C=</b> Key-Pull into OFF / ON Position								
	<b>D=</b> Key-Pull into OFF / ON / ON Position								

<b>KEYLOCK Switch</b>
Part No.: <b>Q44019-</b>
Customer:

DRW:	Jason	CHKD	Wilson	MATL:	Wilson	TOLERANCE	Mason	DATE	25.07.2016
APPD:	Schumi			FINISH	Jamy		Sheet No.		2 from 2