

EDCON-COMPONENTS

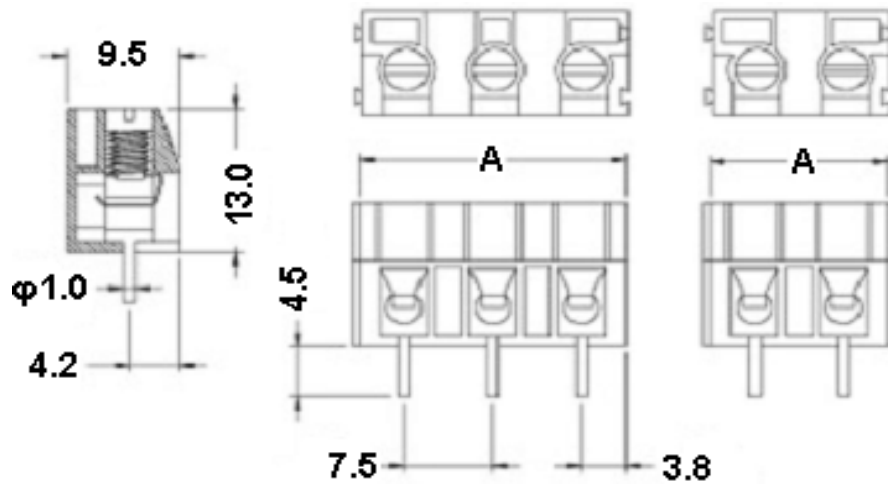

Drawing



P.C.B. Layout

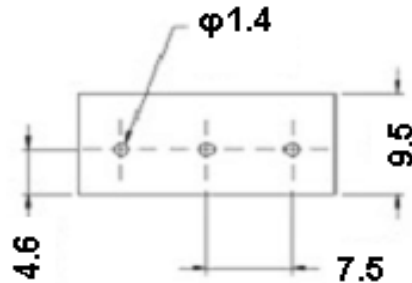

	A [mm]
2P	15.00
3P	22.50

Specification

Electrical

Rated voltage	300V
Rated current	8A
Wire range	22-14 AWG

Mechanical

Ambient temperature	-40°C ~ +105°C
Screw, Torque	M3, 0.45Nm (4.0Lb-In.)

Dimensions

Pitch	7.50mm
Poles	2P + 3P

Material

Housing	PA66 (UL94V-0)
Pin header	Brass, Tin-plated
Screw	steel, Nickel-plated
Wire guard	Stainless strip steel



Wire Protector Terminal Block /
Pitch 7.50mm

Part No.: A12Q012

Customer:

DRW:	Bill	CHKD	Lord	MATL:	Jimmy	TOLERANCE	Sam	DATE	14.03.2009
APPD:	Louis			FINISH	Georg		Sheet No.		1 from 3

www.edcon-components.com

email: info@edcon-components.com

EDCON-COMPONENTS



Ordering Informations

Serie	-	No. of Pole	Body-Color	wire protector	Screw	-	Customer Request
A12Q012	-	XX	XX	X	X	-	X

XX = total	WH - white	1 - with wire protector	A - Slotted screw (standard)
02	GN - green	2 - without wire protector	B - Cross-slotted screw
03	GR - gray		

LG - light gray
PG - Phoenix Green
OR - orange
BL - blue
BK - black (standard)

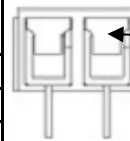

wire protector

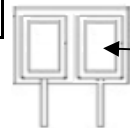

without wire protector



Wire Protector Terminal Block /
Pitch 7.50mm

Part No.: A12Q012

Customer:

DRW:	Bill	CHKD	Lord	MATL:	Jimmy	TOLERANCE	Sam	DATE	14.03.2009
APPD:	Louis			FINISH	Georg			Sheet No.	2 from 3

www.edcon-components.com

email: info@edcon-components.com



Soldering - Profil

Classification Reflow Profile (JEDEC J-STD-020C)

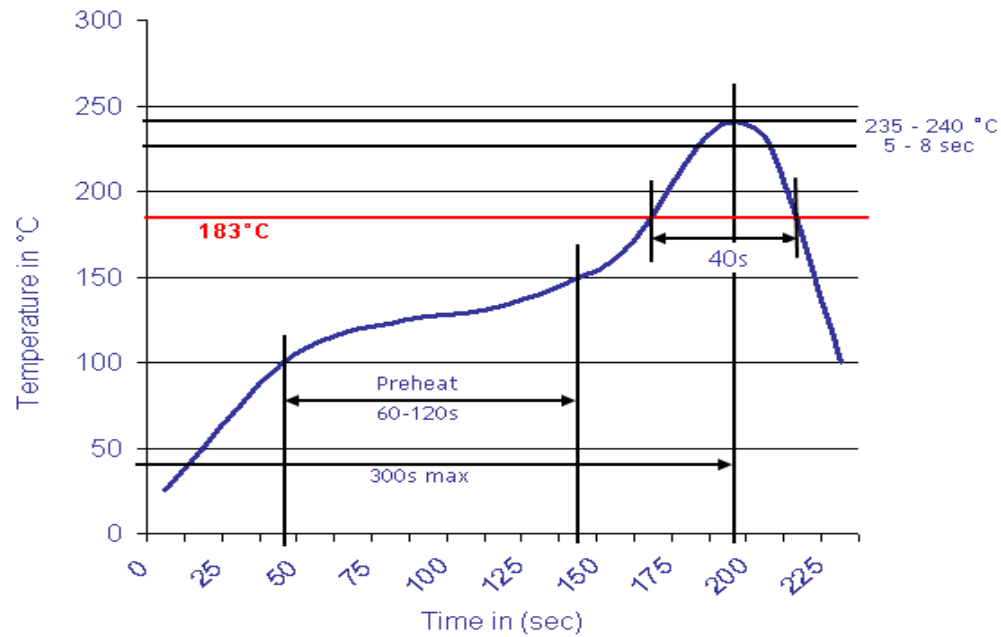

Wire Protector Terminal Block /
Pitch 7.50mm

Part No.: A12Q012

Customer:

DRW:	Bill	CHKD	Lord	MATL:	Jimmy	TOLERANCE	Sam	DATE	14.03.2009
APPD:	Louis			FINISH	Georg		Sheet No.	3 from 3	