

EDCON-COMPONENTS

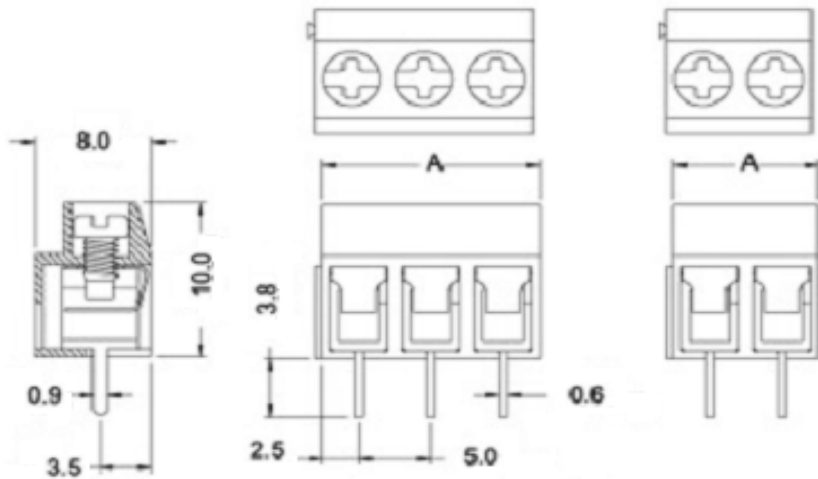

Drawing



P.C.B. Layout

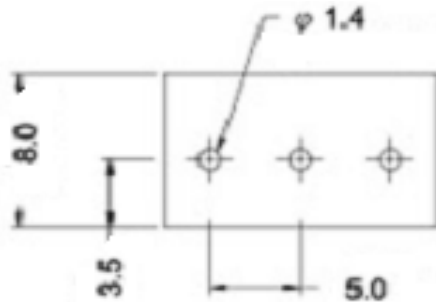

	A [mm]
2P	10.0
3P	15.0

Specification

APPROVAL



Electrical

Standard	cULus
Rated voltage	300V
Rated current	15A
Wire range	26-14 AWG

Mechanical

Ambient temperature	-40°C ~ +105°C
Screw, Torque	M2.6, 0.45Nm (4.0Lb-In.)

Dimensions

Pitch	5.00mm
Poles	2P + 3P

Material

Housing	PA66 (UL94V-0)
Pin header	Brass, Tin-plated
Screw	steel, Zinc-plated
Wire guard	Stainless strip steel



Certification



Wire Protector Terminal Block /
Pitch 5.00mm

Part No.: A12L052

Customer:

DRW:	Bill	CHKD	Lord	MATL:	Jimmy	TOLERANCE	Sam	DATE	14.03.2009
APPD:	Louis			FINISH	Georg		Sheet No.		1 from 3

www.edcon-components.com

email: info@edcon-components.com

EDCON-COMPONENTS



Ordering Informations

Serie	-	No. of Pole	Body-Color	wire protector	Screw	-	Customer Request
A12L052	-	XX	XX	X	X	-	X

XX = total	WH - white	1 - with wire protector	A - Slotted screw
02	GR - gray	2 - without wire protector	B - Cross-slotted screw (standard)
03	GN - green (standard)		



PG - Phoenix Green
OR - orange
LG - light gray
BK - black
BL - blue

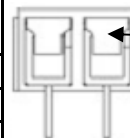

wire protector

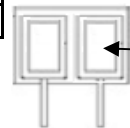

without wire protector



Certification



Wire Protector Terminal Block /
Pitch 5.00mm

Part No.: A12L052

Customer:

DRW:	Bill	CHKD	Lord	MATL:	Jimmy	TOLERANCE	Sam	DATE	14.03.2009
APPD:	Louis			FINISH	Georg			Sheet No.	2 from 3

www.edcon-components.com

email: info@edcon-components.com



Soldering - Profil

Classification Reflow Profile (JEDEC J-STD-020C)

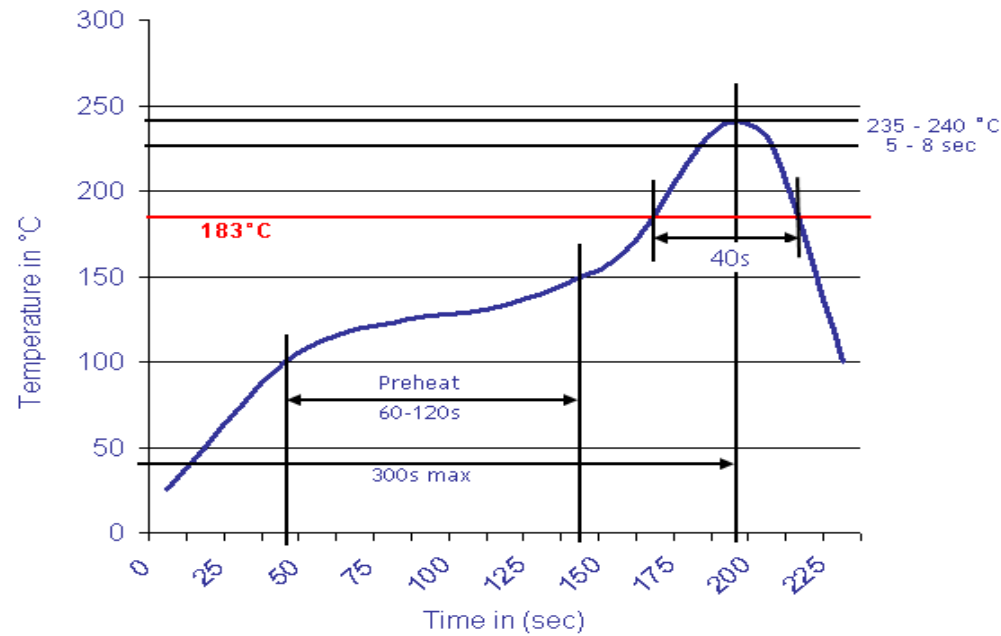

Wire Protector Terminal Block /
Pitch 5.00mm

Part No.: A12L052

DRW:	Bill	CHKD	Lord	MATL:	Jimmy	TOLERANCE	Sam	DATE	14.03.2009
APPD:	Louis			FINISH	Georg		Sheet No.	3 from 3	

Customer: