

EDCON-COMPONENTS

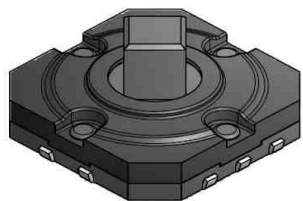

SPECIFICATION:

Current Rating:	DC12V / 50mA
Circuit:	1C-5P
Timing:	NON-Shorting
Travel:	4Directional: 0,25mm Center Push: 0,15mm
Contact Resistance:	500mΩ max.
Operating force:	4-Directional 160gr. +/- 50gr Center Push 250gr +/- 50gr.
Operating Life:	200.000 Cycles

Features:

4 Directional Center push switch with a body height of 1,8mm for compact and slimmer set design.

Multi-directional input type with four directions plus push down.

Contributing to smaller space designing by ist.
Suitable for reflow-soldering

Drawing

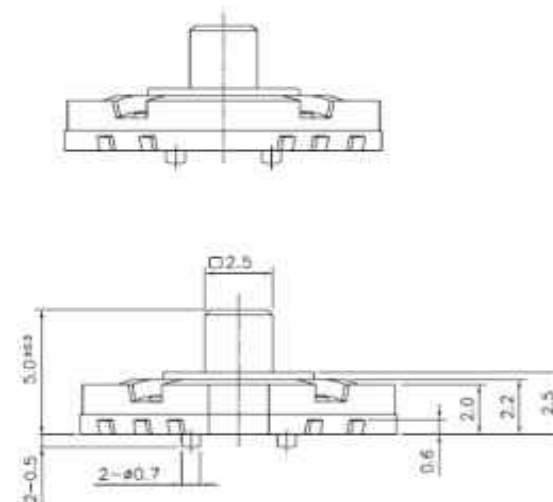
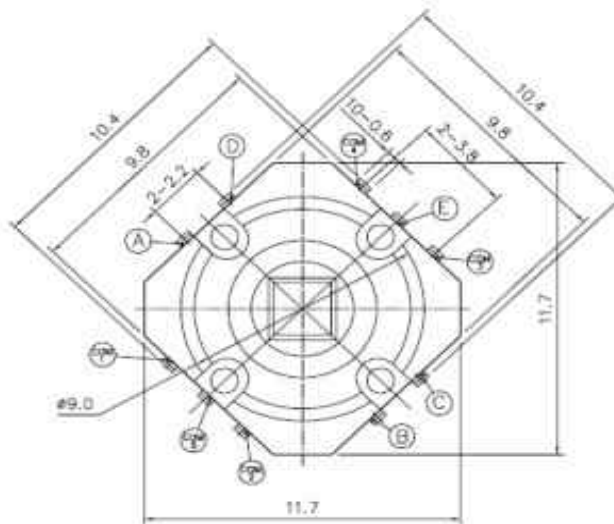

PCB Layout

Circuit Diagram

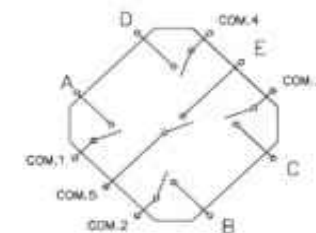
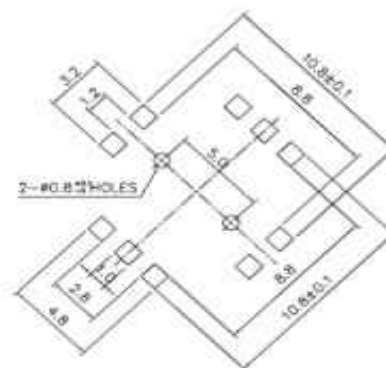

SMT Multi-Direction Switch

Part No.: **Q43004**

Customer:

DRW:	Jason	CHKD	Wilson	MATL:	Wilson	TOLERANCE	Mason	DATE	02.07.2009
APPD:	Schumi			FINISH	Jamy		Sheet No.	1 from 3	

www.edcon-components.com

email: info@edcon-components.com

EDCON-COMPONENTS

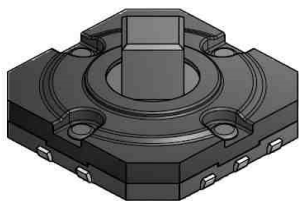

Ordering Informations

Serie	Total height (H)	Embossing	Operating Force	Function	Electrical life	Function	ROHS	Packing		
Q43004	050	Y= with	A	N	204	N	R	BU102		
	050= 5,0mm	Y= with Embossing	A = 160/350gr	N= No function	204= 200000 cycles by 160 / 250 gr. O-Force	N= No function	N= non ROHS R= ROHS conform	BU102= Bulk 1000PCS TR= Tape Reel		

SMT Multi-Direction Switch

Part No.: **Q43004**

Customer:

DRW:	Jason	CHKD	Wilson	MATL:	Wilson	TOLERANCE	Mason	DATE	02.07.2009
APPD:	Schumi			FINISH	Jamy		Sheet No.	2 from 3	

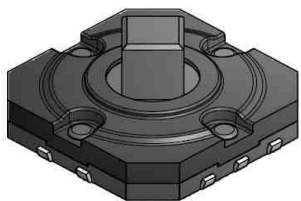

Soldering Profile for Lead Free Soldering

Classification Reflow Profile (JEDEC J-STD-020C)

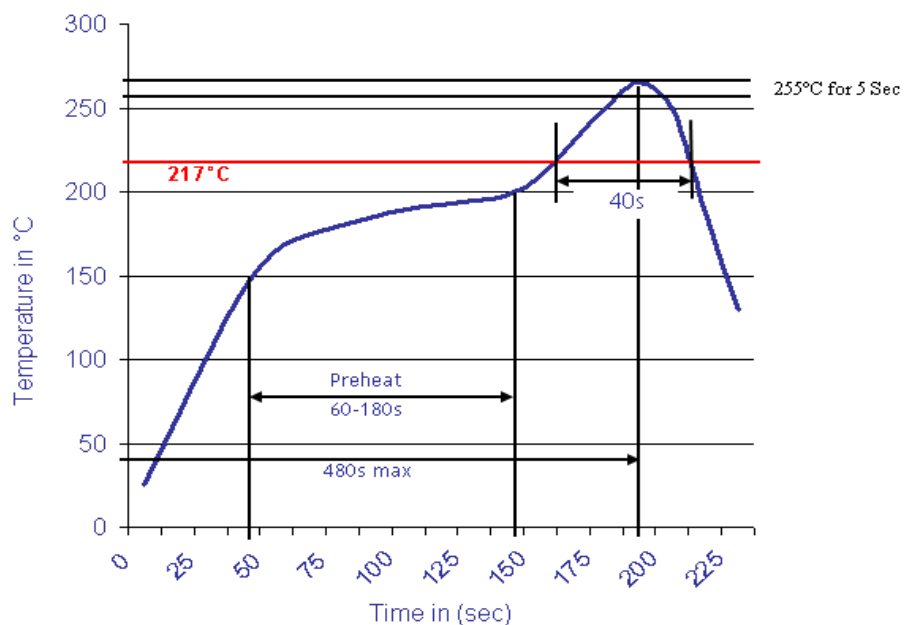

SMT Multi-Direction Switch

Part No.: **Q43004**

Customer:

DRW:	Jason	CHKD	Wilson	MATL:	Wilson	TOLERANCE	Mason	DATE	02.07.2009
APPD:	Schumi			FINISH	Jamy		Sheet No.	3 from 3	