

EDCON-COMPONENTS

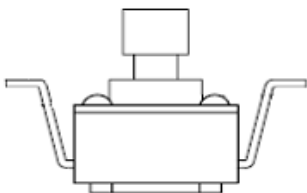

SPECIFICATION:

Current Rating:	DC12V / 50mA
Insulator Resistance:	100 Mega Ω min.
Contact Resistance:	100 m Ω max.
Travel:	0,25 / +/- 0,1mm
Operating Temperature:	-.40°C to +80°C
Lifetime:	look order code
Operating Force:	look order code

Common Specifications

Life Test	50/80 Cycles / Min with 5VDC 5mA Resistive load Cycles of Operation: As per individual Specifications
Dry Heat Proof	80°C +/- 2°C for 96hours after Test Kept in Normal Condition for 30Min.
Moisture Resistance	60°C +/- 2°C 90~95% RH for 96 Hours After Test, Kept in Normal Condition for 30 Minutes
Cold Proof	-.30°C for 96 Hours After Test Kept in Normal Condition for 30 Minutes.
Operating Force	If refers to the maximum load at the time of switching over of the contacts. (Point A in the figure)
Travel	This refers to the state of repeating the contact opening or closing momentarily at the time of the changeover of the switch to ON or OFF. Longer duration of this state

Drawing

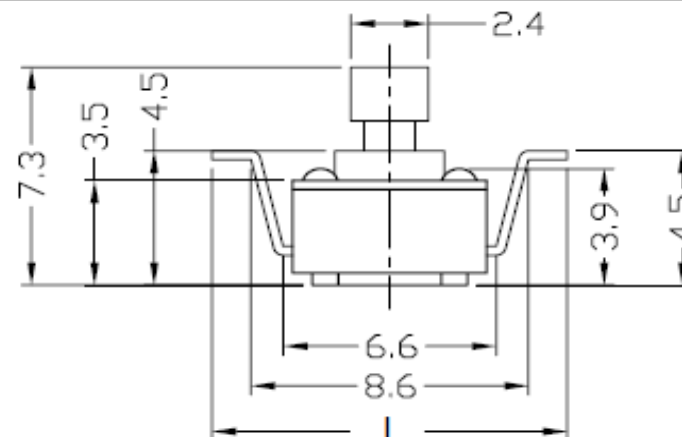
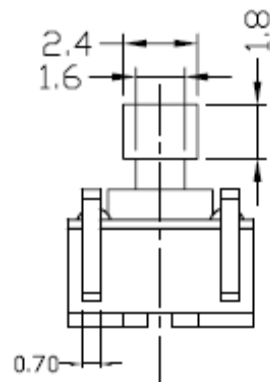
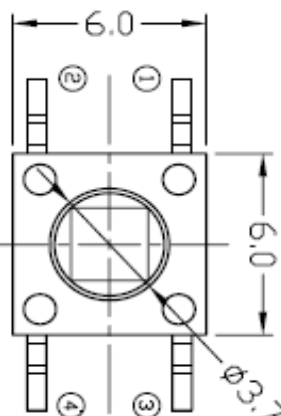

PCB Layout

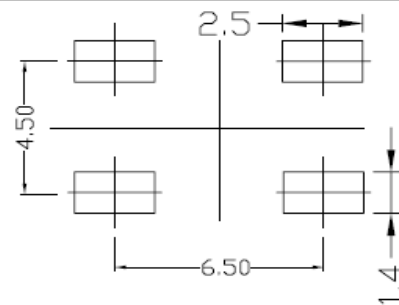

Circuit Diagram

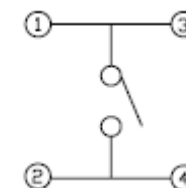

SMT TACT SWITCH

Part No.: **Q12123**

Customer:

DRW:	Jason	CHKD	Wilson	MATL:	Wilson	TOLERANCE	Mason	DATE	24.09.2012
APPD:	Schumi			FINISH	Jamy		Sheet No.		1 from 3

EDCON-COMPONENTS

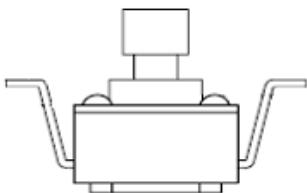

Ordering Informations

Serie	Total height	Stem Dim.	Operating Force	Lead Length (L)	Electrical life	Function	ROHS	Packing		
Q12123	073	A	101	C	104	N	R	TU		
	073= 7,3mm	A= 2,4x2,4mm	101 = 100gr		104= 100000 cycles by 100gr. O-Force	N= No function	N= non ROHS	TR= Tape / Reel		
					104= 100000 cycles by 160gr. O-Force		R= ROHS conform	TU= Tube Packing		
			161 = 160gr	C= L= 11mm				BU= Bulk Ware		

SMT TACT SWITCH	
Part No.:	Q12123
Customer:	

DRW:	Jason	CHKD	Wilson	MATL:	Wilson	TOLERANCE	Mason	DATE	24.09.2012
APPD:	Schumi			FINISH	Jamy		Sheet No.	2 from 3	

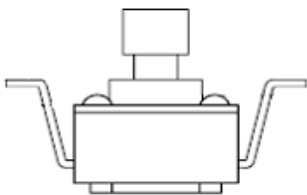

Soldering Profile for Lead Free Soldering

Classification Reflow Profile (JEDEC J-STD-020C)

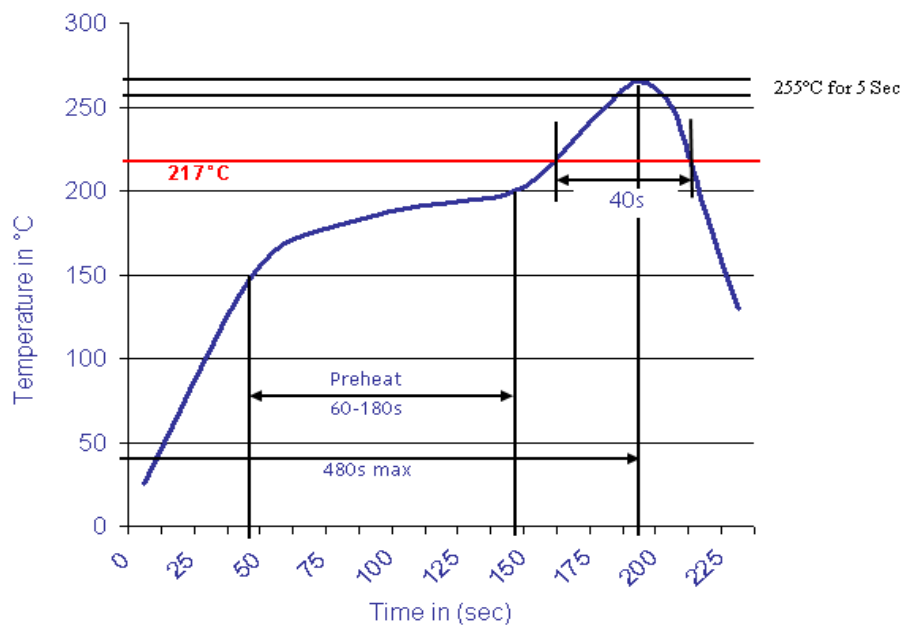

SMT TACT SWITCH

Part No.: **Q12123**

Customer:

DRW:	Jason	CHKD	Wilson	MATL:	Wilson	TOLERANCE	Mason	DATE	24.09.2012
APPD:	Schumi			FINISH	Jamy		Sheet No.	3 from 3	