



**THT, Radial E-Cap., Snap-In, Long Life, Best for Switching power supplies, Load Life 3000 hours at 105°C, ROHS Conform, Packing Box**

Items		Performance Characteristics									
Operating temperature range		-40°C +105°C (10V ~ 250V); -25°C ~ +105°C (350V ~ 500V)									
Leakage current max.		I = 3√CV μA (after 5 minutes)									
Capacitance tolerance		±20% at 120Hz, 20°C									
Dissipation factor max. (at 120Hz, 20°C)		WV	10	16	25	35	50	63	80, 100	160~400	450~500
		TanQ	0,55	0,50	0,40	0,35	0,30	0,25	0,20	0,15	0,20
Load life ( after application of the rated voltage for 3000hrs at 105°C)		Leakage Current								Less than specified Value	
		Capacitance Change								Within ±20% off initial Value	
		TanQ								Less than 200% of specified value	
Shelf life (at 105°C)		Leakage Current								Less than specified Value	
		Capacitance Change								Within ±20% off initial Value	
		TanQ								Less than 200% of specified value	

**FREQUENCY COEFFICIENT OF PERMISSIBLE RIPPLE CURRENT**

WV	Frequency	50HZ	120Hz	300Hz	1kHz	10kHz
10 ~ 100		0,85	1,00	1,06	1,15	1,20
160 ~ 250		0,85	1,00	1,20	1,25	1,45
350 ~ 450		0,85	1,00	1,15	1,20	1,40

**Technical Details**

Range (μF)	220	∅D(mm)	25,0
Voltage	350	L(mm)	35,0
Impedance (Ω)	-.	F(mm)	10,0
Ripple Current (mA)	0,98	∅d(mm)	0
ESR (Ω) max.at 20°C 10KHz	-.	α(mm)	0
Lifetime (hrs)	3000		2,0
Operating- Temperature Range (°C)	-.25°C ~ +105°C		-.

**DRAWING**

Unit : mm

∅D ≤ 40

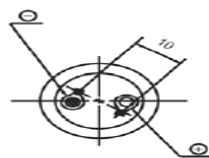
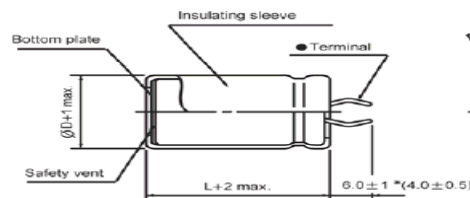

PC Board Mounting Holes

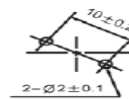

Terminal

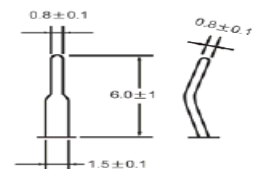

\* Shorter terminal(4.0 ± 0.5) is also available upon request. Terminal length of height 20mm products is applied shorter terminal to standard terminal type.

∅D = 35, 40

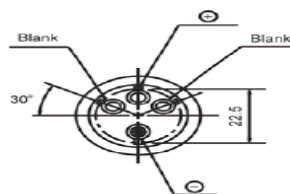
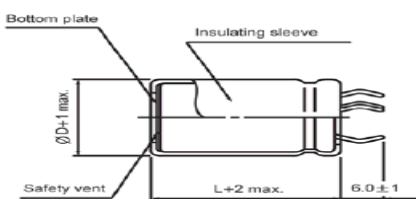

PC Board Mounting Holes

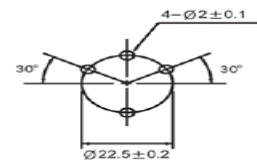

DRW:	Lexua	CHKD	Wilson	MATL:	ChuChu	DATE	28.01.2025
APPD:	Jimmy			FINISH	Josy	Sheet	1 from 2

Copyright by S.Tiede



THT, Radial E-Cap., Snap-In, Long Life, Best for Switching power supplies, Load Life 3000 hours at 105°C, ROHS Conform, Packing Box

**Ordering Informations:**

Serie-No. / Voltage / Range / Size	Capacity Tolerance	ROHS	Packing
------------------------------------	--------------------	------	---------

I14127-3512212535	M	R	BU
-------------------	---	---	----

Serie	Voltage (V)	Range $\mu$ H)	D * L (mm)	Tolerance Order Code	R= ROHS N= NON ROHS	BU= Bulk-Ware (Box)

**Soldering Information**

**Lead Solder Performance**

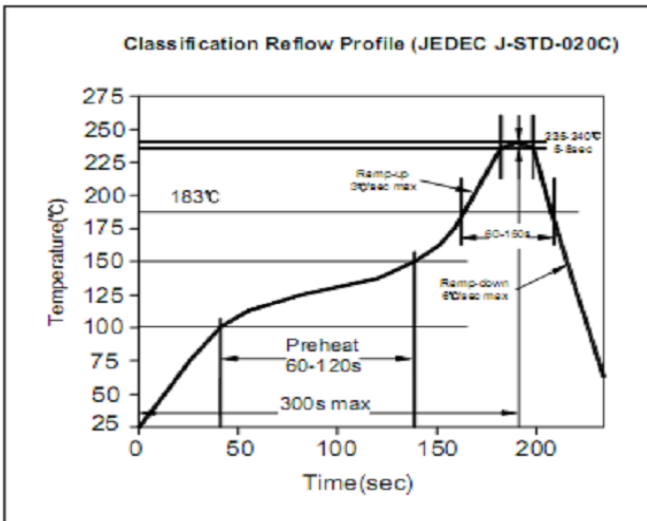

**Lead free Solder Performance**

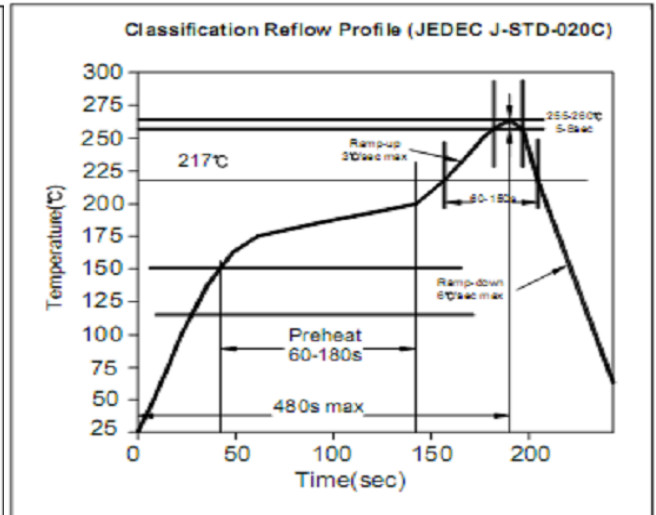

DRW:	Lexua	CHKD	Wilson	MATL:	ChuChu	DATE	28.01.2025
APPD:	Jimmy			FINISH	Josy	Sheet	2 from 2